

# Type FL Pressure Reducing Regulators

## Features

- **No Atmospheric Bleed**—Type FL eliminates nuisance and wasteful bleed gas to atmosphere by utilizing a two-path pilot-operated control system, which bleeds 100% of the gas to the downstream system while the regulator is operating.
- **Quiet Operation**—Optional noise abatement systems are available.
- **Control Accuracy**—Keeps constant inlet pressures to downstream equipment by accurately controlling system pressures at widely varying flow rates and supply pressures for maximum efficiency and best operation.
- **Versatility**—A wide variety of applications such as natural gas transmission and distribution systems, power plants, monitors and sour gas with inlet pressures up to 1480 psig / 102 bar.
- **Easy In-Line Maintenance**—With the optional outlet flange spacer, trim parts such as the disk holder can be inspected, cleaned and replaced without removing the body from the pipeline.
- **Tight Shutoff**—A combination of soft seat and metal plug with a knife edge creates the seal.
- **Easy Startup**—Equal inlet and outlet pressure ratings allow easier startup and shutdown.
- **High Capacity**—Up to NPS 10 / DN 250 body size, the body design and flow passage allows exceptionally high capacities with a maximum  $C_g$  of 51,500 - 2:1 line size.
- **In-Service Travel Indicator**—The travel indicator with protective cover, responds to the precise movement of the diaphragm and plug assembly and shows the actual valve position.

## Introduction

Type FL regulator is accurate, pilot-operated, pressure balanced, soft-seated regulator designed for high-pressure transmission/city gate, large capacity distribution systems and power plant feeds. Type FL provides smooth and quiet operation, tight shutoff and long service life. The regulator utilizes a main valve actuator, a Type PRX pressure reducing pilot and a Type SA/2 pilot supply pressure regulator.

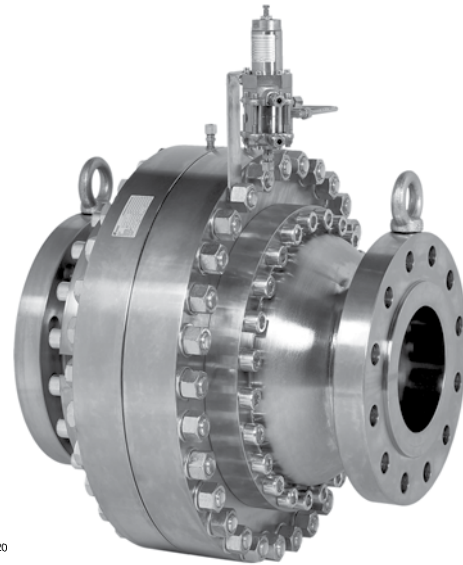

Figure 1. Type FL Regulator with Type PRX Pilot

Type PRX pilot uses inlet pressure reduced by a Type SA/2 supply pressure regulator, as loading pressure to operate the main valve actuator. The outlet pressure is sensed through a control line on the main valve actuator and also on the Type PRX pilot diaphragm.

The regulator's superior performance is due to the amplifying effect of the pilot and two-path control system. Changes in outlet pressure act quickly on the actuator diaphragm to provide fast response to system change. Then the pilot amplifies any small system changes to position the main valve for precise pressure control.

## Type PRX Pilot Descriptions

A pressure reducing pilot that has the ability to handle a wide range of setpoints from 14.5 to 1160 psig / 1.00 to 80.0 bar in two versions:

**Type PRX/120:** A pressure reducing pilot with an outlet pressure range of 14.5 to 435 psig / 1.00 to 30.0 bar. Type PRX/120 can be used as the pilot on single stage pressure-reducing regulators or as the monitor pilot or as the working pilot in wide-open monitor systems.

# Bulletin 71.2:FL

## Specifications

The Specifications section gives some general specifications for the Type FL regulators. The nameplates give detailed information for a particular regulator as it comes from the factory.

### Available Configuration

**Type FL:** Pilot-operated pressure reducing regulator from 14.5 to 1160 psig / 1.00 to 80.0 bar outlet pressures

### Body Sizes

**Type FL:** NPS 1, 2, 3, 4, 6, 8 and 10 / DN 25, 50, 80, 100, 150, 200 and 250

**Type FL with Type SRS Silencer (Inlet x Outlet):**

NPS 1 x 4, 2 x 6, 3 x 10, 4 x 10, 6 x 12 and 8 x 16 / DN 25 x 100, 50 x 150, 80 x 250, 100 x 250, 150 x 300 and 200 x 400

### Main Valve End Connection Style and Pressure Ratings<sup>(1)</sup>

**CL300 RF:** 740 psig / 51.0 bar<sup>(4)</sup>

**CL600 RF:** 1480 psig / 102 bar<sup>(4)</sup>

### Maximum Inlet and Outlet (Casing) Pressure<sup>(1)</sup>

1480 psig / 102 bar<sup>(4)</sup>

### Minimum Operating Differential Pressure<sup>(2)</sup>

#### Start Open:

*NPS 1 to 4 / DN 25 to 100:* 7.3 psid / 0.50 bar d

*NPS 6 and 8 / DN 150 and 200:* 3 psid / 0.21 bar d

*NPS 10 / DN 250:* 2.9 psid / 0.2 bar d

#### Full Open

*NPS 1 to 4 / DN 25 to 100:* 14.5 psid / 1.00 bar d

*NPS 6 and 8 / DN 150 and 200:* 7.3 psid / 0.50 bar d

*NPS 10 / DN 250:* 8.7 psid / 0.6 bar d

### Outlet (Control) Pressure Ranges

See Table 1

### Flow and Coefficients

See Table 2

### Pilot and Filter-Regulator Flow Coefficients

**Type PRX Pilot:**  $C_g$ : 10.5;  $C_v$ : 0.36;  $C_f$ : 29

**Type SA/2 Filter-Regulator:**  $C_g$ : 19

### Pressure Registration

External

### Temperature Capabilities<sup>(1)(3)</sup>

**Nitrile (NBR), Fluorocarbon (FKM) or Polyurethane (PU) Disk:**

-4 to 140°F / -20 to 60°C

**Nitrile (NBR) or Polyurethane (PU) Disk:**

-20 to 140°F / -29 to 60°C<sup>(5)</sup>

### Approximate Weights (Including Pilot)

See Figure 7

### Construction Materials

#### Type FL Main Valve

*Main Body and Flanges:* Steel

*Sleeve and Disk Holder:* Steel

*Diaphragm Plates:* Steel

*Diaphragm:* Nitrile (NBR) with PVC coating

*Disk O-rings:* Nitrile (NBR) or Fluorocarbon (FKM)

*Disk:* Nitrile (NBR), Fluorocarbon (FKM)

or Polyurethane (PU)

#### Type PRX Pilot

*Body:* Steel

*Trim:* Stainless steel

*Diaphragm:* Nitrile (NBR) or Fluorocarbon (FKM)

*Disk O-rings:* Nitrile (NBR) or Fluorocarbon (FKM)

*Disk:* Polyurethane (PU) or Fluorocarbon (FKM)

#### Type SA/2 Supply Pressure Regulator

*Body:* Steel

*Diaphragm:* Nitrile (NBR) with PVC Coating

*O-rings:* Nitrile (NBR) or Fluorocarbon (FKM)

*Disk:* Polyurethane (PU) or Fluorocarbon (FKM)

North America Only

1. The pressure/temperature limits in this Bulletin and any applicable standard or code limitation should not be exceeded.

2. When using a Type SA/2 pilot supply filter regulator, the differential pressure across the regulator must be at least 45 psid / 3.1 bar d for optimum regulator performance.

3. Types PRX and SA/2 Fluorocarbon (FKM) elastomer are limited to 0°F / -18°C.

4. At average ambient temperature.

5. Meets or exceeds ANSI/FCI 70-3 Class VI/VII leakage limits at maximum operating differential pressure.

**Type PRX-AP/120:** A pressure reducing pilot with an outlet pressure range of 435 to 1160 psig / 30.0 to 80.0 bar. Type PRX-AP/120 can be used as the pilot on single stage pressure-reducing regulators or as the monitor pilot or as the working pilot in wide-open monitor systems.

**Type PRX/125:** This pilot is identical to the Type PRX/120 except that the restriction screw is removed. Type PRX/125 can only be used as the monitor override pilot on working monitor applications. The pilot has an outlet pressure range of 14.5 to 435 psig / 1.00 to 30.0 bar.

**Type PRX-AP/125:** This pilot is identical to the Type PRX-AP/120 except that the restriction screw is removed. Type PRX-AP/125 can only be used as the monitor override pilot on working monitor applications. The pilot has an outlet pressure range of 435 to 1160 psig / 30.0 to 80.0 bar.

**Type PRX/131:** Outlet pressure range of 14.5 to 435 psig / 1 to 30 bar. The Type PRX/131 is used as a booster or quick dump pilot with another PRX Series pilot on a single stage pressure reducing regulator or with the monitor pilot on the monitor regulator in Wide-Open Monitor systems. It is installed as standard on the regulator for NPS 10 / DN 250 and has identical pressure ratings as the Type PRX pilots. The Type PRX/131 allows the regulator to operate faster. If the downstream pressure ( $P_2$ ) increases, the Type PRX/131 opens and the loading pressure to the regulator drops, allowing the regulator to release pressure off the downstream side of the diaphragm so it closes faster.

**Type PRX-AP/131:** Outlet pressure range of 435 to 1160 psig / 30 to 80 bar. This pilot is used as a booster or quick dump pilot with another PRX Series pilot on a single stage pressure reducing regulator or with a monitor pilot on the monitor regulator in Wide-Open Monitor systems.

E0822



Figure 2. Noise Abatement Construction

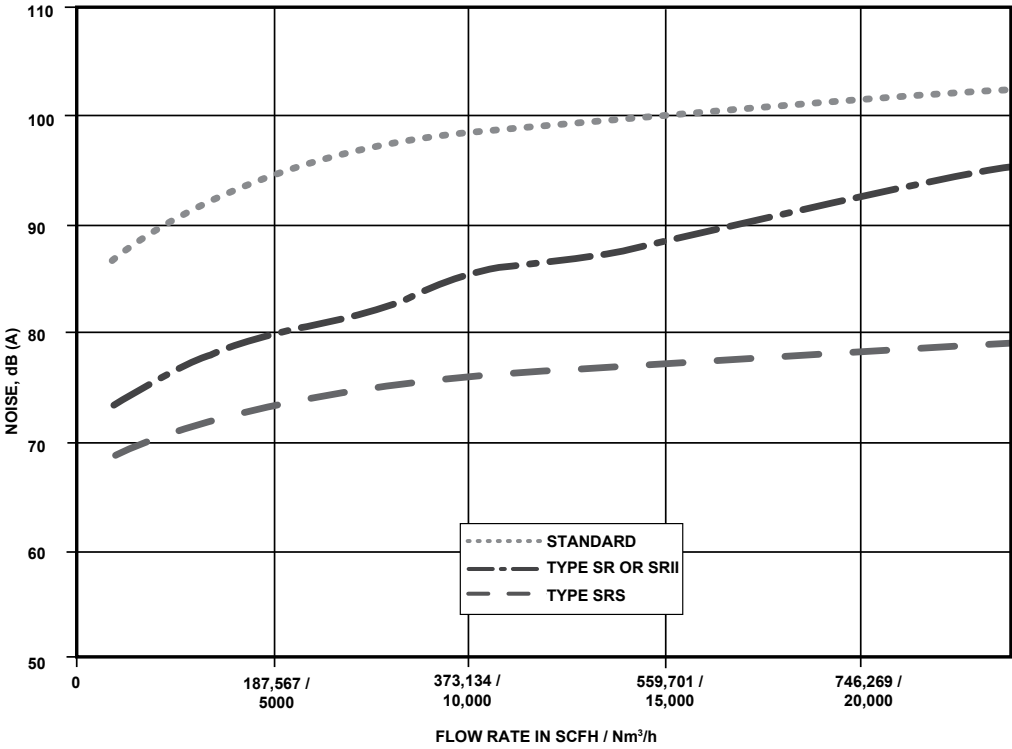

Figure 3. Typical Sound Emission Comparison among the Different Configurations

Table 1. Outlet (Control) Pressure Ranges

TYPE	OUTLET PRESSURE RANGE		AC (ACCURACY CLASS)	PILOT CONTROL SPRING INFORMATION	
	psig	bar		Spring Color	Part Number
PRX/120 PRX/125 PRX/131	14.5 to 26	1.00 to 1.8	2.5%	Yellow	M0255240X12
	23 to 44	1.6 to 3.0	2.5%	Green	M0255230X12
	41 to 80	2.8 to 5.5	2.5%	Blue	M0255180X12
	73 to 123	5.0 to 8.5	2.5%	Black	M0255220X12
	116 to 210	8.0 to 14.5	1%	Silver	M0255210X12
	203 to 334	14.0 to 23.0	1%	Gold	M0255200X12
	319 to 435	22.0 to 30.0	1%	Aluminum	M0255860X12
PRX-AP/120 PRX-AP/125 PRX-AP/131	435 to 1160	30.0 to 80.0	1%	Clear	M0273790X12

North America Only

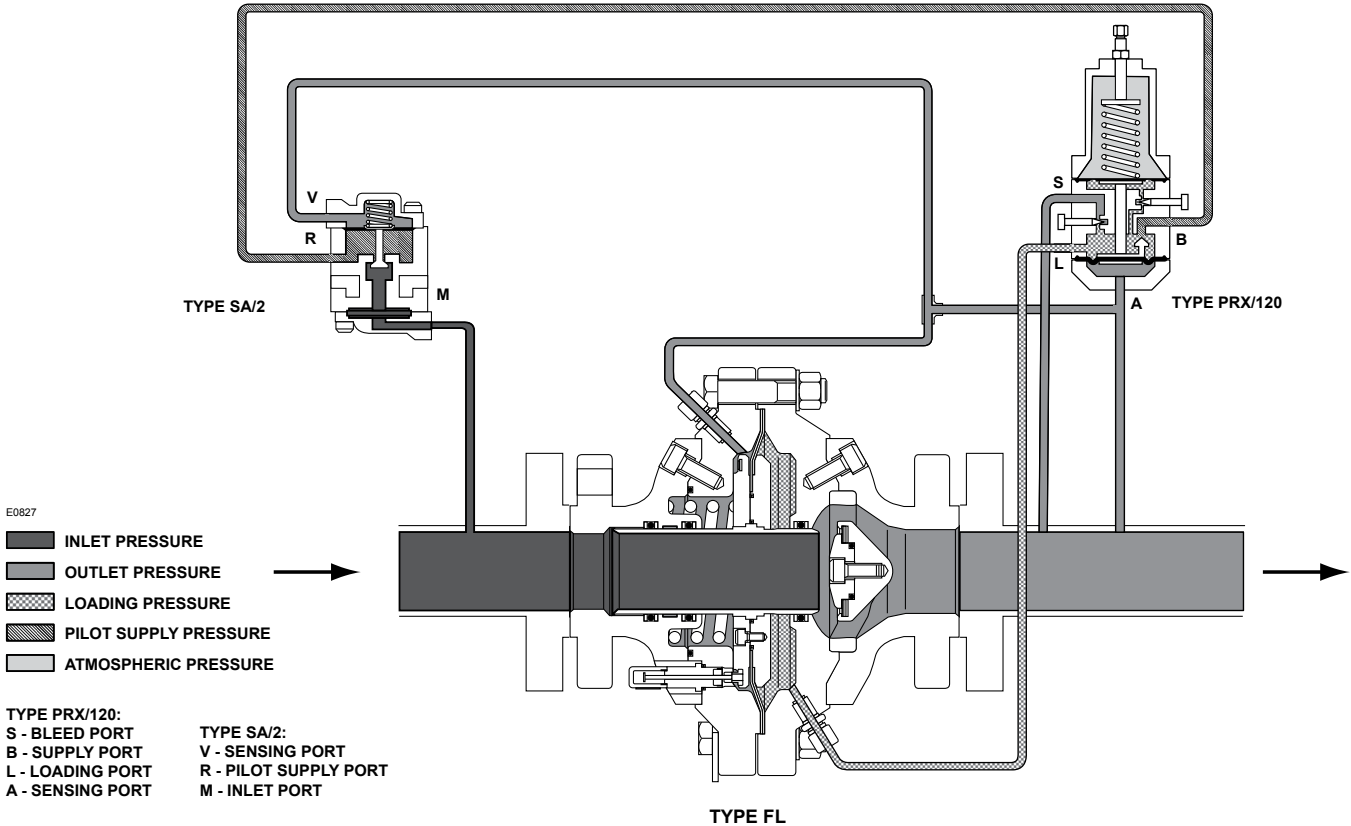

Figure 4. Type FL Operational Schematic

## Type SA/2 Pilot Supply Filter Regulator

The PRX Series pilots are usually used together with the Type SA/2 pilot supply filter regulator. The Type SA/2 acts as a pressure stabilizer that provides a constant supply pressure to the PRX Series pilots: this value is 45 psi / 3.1 bar over set pressure. It is installed on the feed line to the PRX Series pilot and provides the pilot supply pressure to the B port on the pilot. Type SA/2 has an integral 5 micron filter. This integral filter acts only as an emergency filter; gas must be cleaned upstream of the regulator.

## Noise Abatement

At elevated pressure drops and flow rates, regulators with standard trims can produce unacceptable noise levels. Several options are available to reduce the noise generated.

**Type SR:** Type SR (Figure 2) multi-path noise abatement device is incorporated into the regulator on the seat area. It consists of plated Stainless steel wires containing no sound deadening materials. Depending on flows and pressure drop, the silencer can reduce noise levels as much as 20 dB (A) with an approximate 3%  $C_g$  reduction. Type SR is available only in NPS 1 through 6 / DN 25 through 150.

**Type SRII:** The Type SRII (Figure 2) noise abatement device is the next generation of Type SR and is used in case of extreme service conditions (dirty gas, high pressure drops and high gas velocities). Noise characteristics are very similar to the standard Type SR.

**Type SRS:** A second noise reduction device may be added to the Type FL regulators. Type SRS (Figure 2) consists of a Type SR or SRII plus a widened outlet flange in which a second silencer is fitted. Noise reduction is based on the principle of stream splitting and gradual expansion in several stages. By using a wider outlet flange the silencer can be mounted integral to the regulator which allows installation of the regulator directly into the downstream piping without an expansion joint. Noise reduction up to 25 dB (A) is reached without limiting the velocity in the outlet flange with a  $C_g$  reduction of about 15%. Type SRS will be installed together with a Type SR or SRII. Type SR/SRS Silencer is available only in NPS 1 through 6 / DN 25 through 150.

## Principle of Operation

The pilot-operated Type FL (Figure 4) uses inlet pressure as the operating medium, which is reduced through pilot operation to load the actuator diaphragm. Outlet or downstream pressure opposes loading pressure in the actuator and also opposes the pilot control spring.

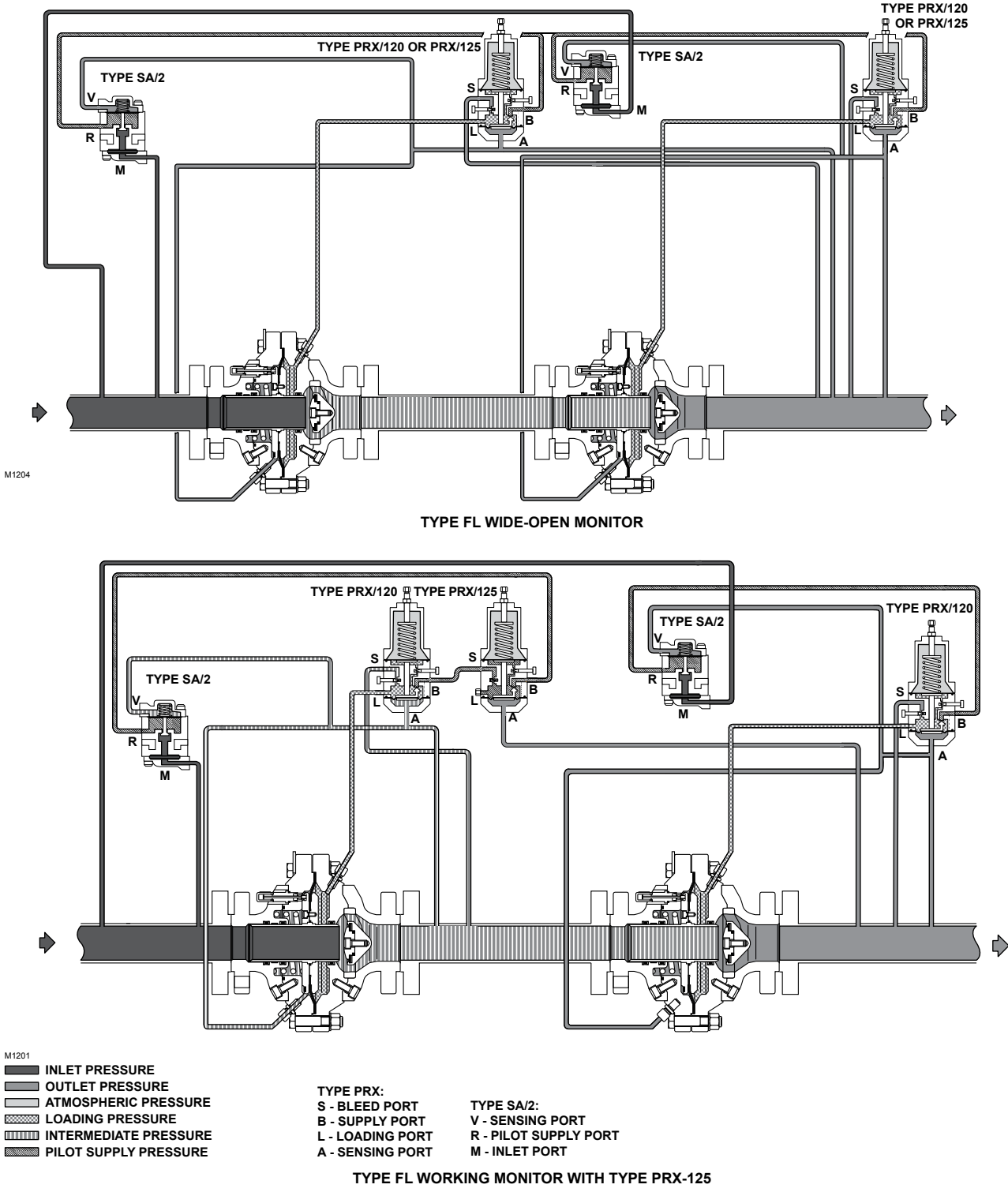
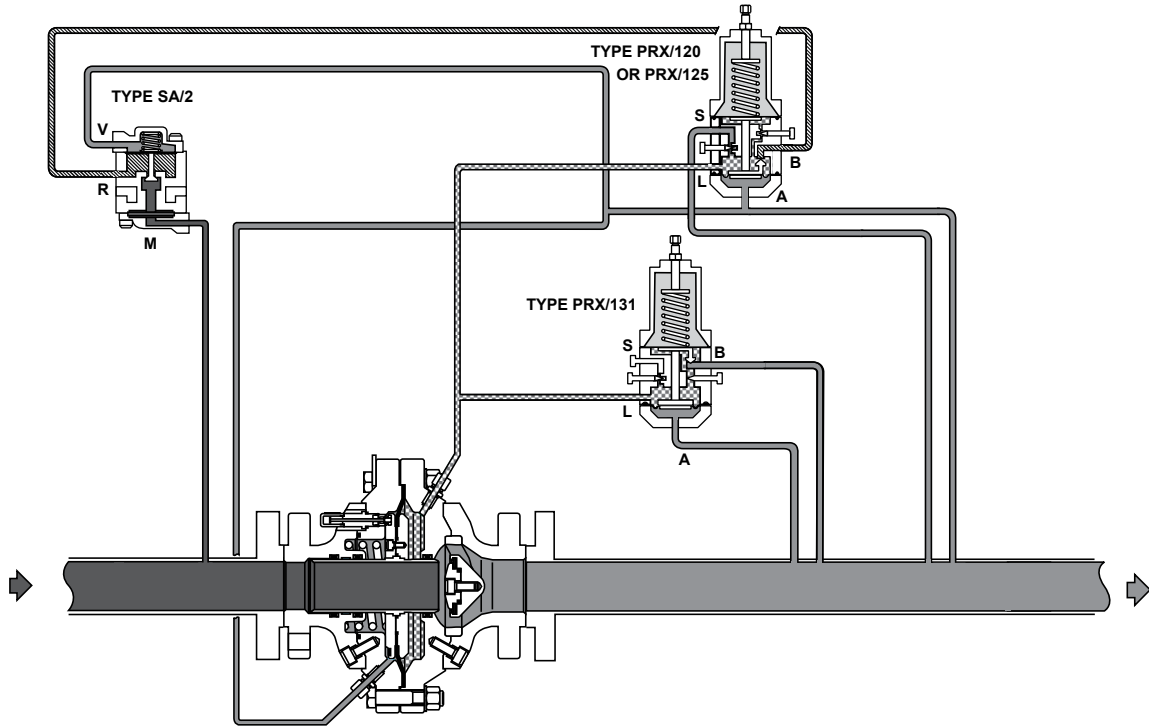

Figure 5. Typical FL Installation Schematics

North America Only



M1216

TYPE FL WITH TYPE PRX/131 QUICK DUMP PILOT

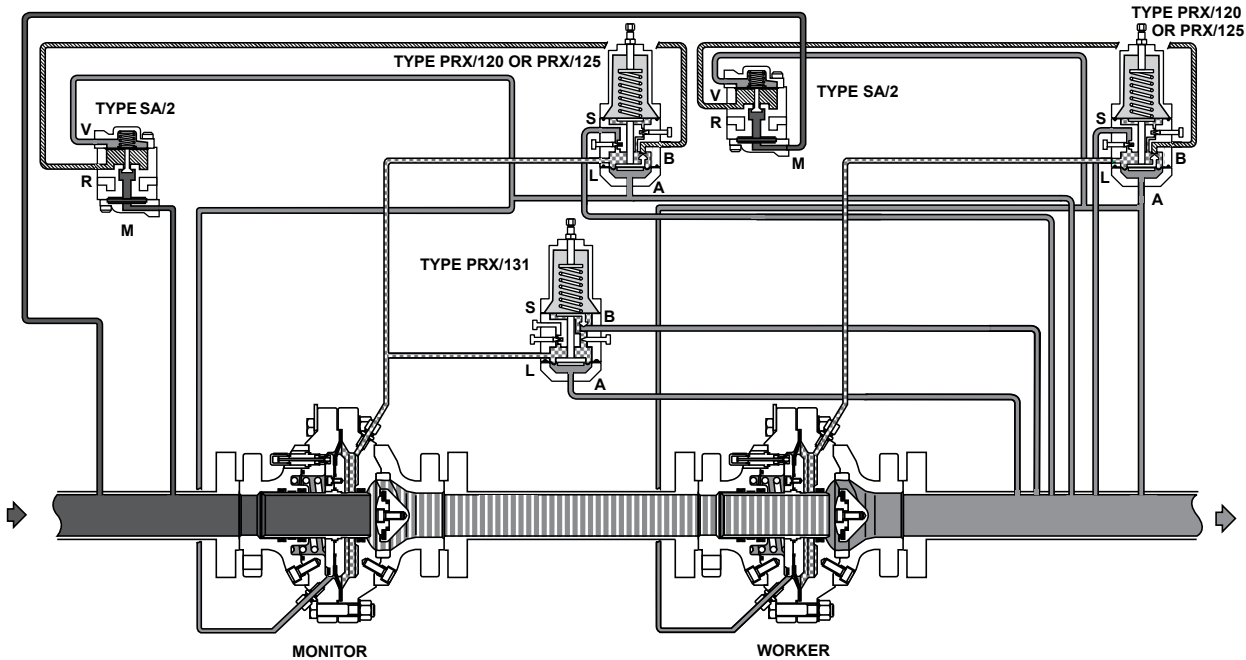

M1212

- INLET PRESSURE
- OUTLET PRESSURE
- ATMOSPHERIC PRESSURE
- ▨ LOADING PRESSURE
- ▨ INTERMEDIATE PRESSURE
- ▨ PILOT SUPPLY PRESSURE

- |                  |                  |                       |                |
|------------------|------------------|-----------------------|----------------|
| TYPE PRX:        |                  | TYPE SA/2:            |                |
| S - BLEED PORT   | V - SENSING PORT | R - PILOT SUPPLY PORT | M - INLET PORT |
| B - SUPPLY PORT  |                  |                       |                |
| L - LOADING PORT |                  |                       |                |
| A - SENSING PORT |                  |                       |                |

TYPE FL WIDE-OPEN MONITOR WITH TYPE PRX/131 QUICK DUMP PILOT

Figure 5. Typical FL Installation Schematics (continued)

North America Only

When outlet pressure drops below the setting of the pilot control spring, pilot control spring force on the pilot diaphragm opens the pilot valve plug, providing additional loading pressure to the actuator diaphragm. This diaphragm loading pressure opens the main valve plug, supplying the required flow to the downstream system. Any excess loading pressure on the actuator diaphragm escapes downstream through the exhaust restriction in the pilot.

When the gas demand in the downstream system has been satisfied, the outlet pressure increases.

The increased pressure is transmitted through the downstream control line and acts on the pilot diaphragm. This pressure exceeds the pilot spring setting and moves the diaphragm, closing the orifice. The loading pressure acting on the main diaphragm bleeds to the downstream system through the exhaust restriction in the pilot.

## Installation

Type FL regulators are installed in a horizontal or vertical pipeline. An optional outlet flange spacer (Figure 6, page 8) is available to be installed downstream of the regulator. Once the spacer and outlet flange are removed, the disk holder and trim parts are easily accessed. See Figure 5 for typical piping installations. Dimensions are given in Figure 7.

Type FL may be installed in any position, but is normally installed in a horizontal pipeline with the pilot or pilots above the body. The optimal location for the sense and bleed lines is between the Type FL and the downstream block valve. If the sense and bleed lines cannot be located between the Type FL and downstream block valve, contact your local Sales Office for Startup assistance. See Figure 5 for typical piping installation.

### Note

**To prevent damage to the pilot during Startup, the sense and bleed lines should be located on the same side of the downstream block valve.**

## Monitoring Systems

Monitoring regulation is overpressure protection by containment, therefore, there is no relief valve to vent to the atmosphere. When the working regulator fails to control the pressure, a monitor regulator installed in series, which has been sensing the downstream and control pressure, goes into operation to maintain the downstream pressure at a higher value than normal pressure. During an overpressure situation, monitoring keeps the customer online. Also, testing is relatively easy and safe. To perform a periodic test on a monitoring regulator, increase the outlet set pressure of the working regulator and watch the outlet pressure to determine if the monitoring regulator takes over at the appropriate outlet pressure.

## Wide-Open Monitoring Systems (Figure 5)

There are two types of wide-open monitoring systems: upstream and downstream. The difference between upstream and downstream monitoring is that the functions of the regulators (monitor and worker) are reversed. Systems can be changed from upstream to downstream monitoring and vice-versa, by simply reversing the setpoints of the two regulators. The decision to use either an upstream or downstream monitoring system is largely a matter of personal preference or company policy.

In normal operation of a wide-open configuration, the working regulator controls the system's outlet pressure. With a higher outlet pressure setting, the monitor regulator senses a pressure lower than its setpoint and tries to increase outlet pressure by going wide open. If the working regulator fails, the monitoring regulator assumes control and holds the outlet pressure at its outlet pressure setting.

## Working Monitoring Regulators (Figure 5)

In a working monitoring system, the upstream regulator requires two pilots and it is always the monitoring regulator. The additional pilot permits the monitoring regulator to act as a series regulator to control an intermediate pressure during normal operation.

In this way, both units are always operating and can be easily checked for proper operation.

In normal operation, the working regulator controls the outlet pressure of the system. The monitoring regulator's working pilot controls the intermediate pressure and the monitoring pilot senses the system's outlet pressure. If the working regulator fails, the monitoring pilot will sense the increase in outlet pressure and take control.



### WARNING

**The working regulator must be rated for the maximum allowable operating pressure of the system because this will be its inlet pressure if the monitoring regulator fails. Also, the outlet pressure rating of the monitoring pilot and any other components that are exposed to the intermediate pressure must be rated for full inlet pressure.**

Working monitor installations require a Type FL main valve with a Type PRX/120 or PRX-AP/120 working pilot and a Type PRX/125 or PRX-AP/125 monitoring pilot for the upstream regulator and a Type FL with the appropriate Type PRX/120 or PRX-AP/120 pilot for the downstream regulator.

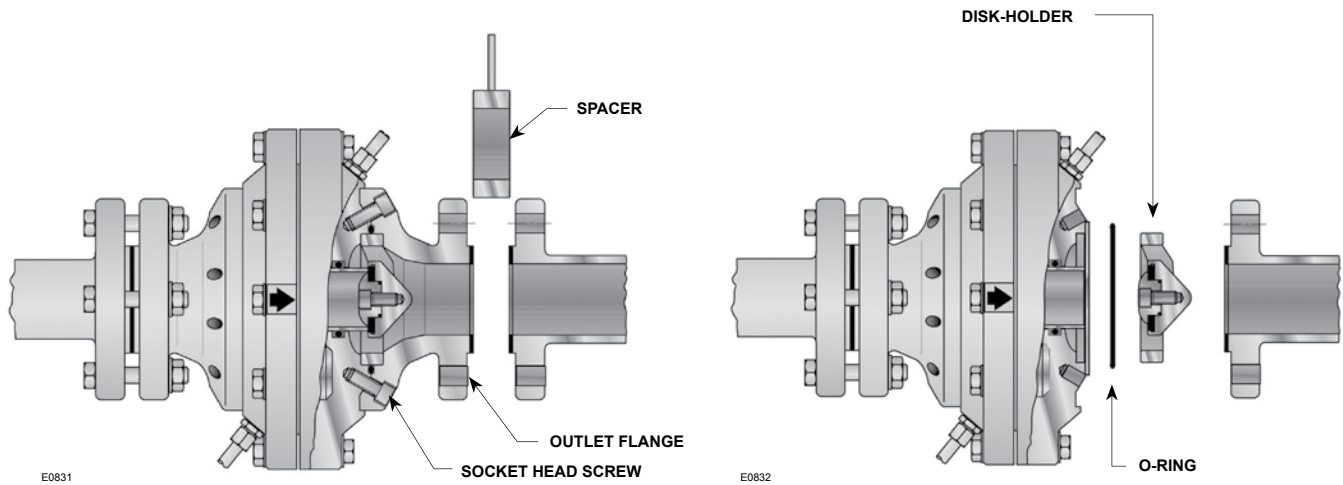

Figure 6. Outlet Flange Spacer Installation

## Capacity Information

### Note

**Type FL flow capacities are laboratory verified; therefore, they may be sized for 100% flow using published capacities as shown. It is not necessary to reduce published capacities.**

Tables 3 and 4 show the natural gas regulating capacities of the Type FL regulator at selected inlet pressures and outlet pressure settings. Flows are in thousands of SCFH at 60°F and 14.7 psia (and in thousands of Nm<sup>3</sup>/h at 0°C and 1.01325 bar) of 0.6 specific gravity natural gas.

To find approximate regulating capacities or to find wide-open flow capacities for relief sizing at any inlet pressure, perform one of the following procedures. Then, if necessary, convert using the factors provided below.

For critical pressure drops (absolute outlet pressure equal to or less than one-half of absolute inlet pressure), use the following formula:

$$Q = (P_1)(C_g)(1.29)$$

For pressure drops lower than critical (absolute outlet pressure greater than one-half of absolute inlet pressure).

$$Q = \sqrt{\frac{520}{GT}} C_g P_1 \text{SIN} \left( \frac{3417}{C_1} \sqrt{\frac{\Delta P}{P_1}} \right) \text{DEG}$$

where,

Q = gas flow rate, SCFH

P<sub>1</sub> = absolute inlet pressure, psia (P<sub>1</sub> gauge + 14.7)

C<sub>g</sub> = regulating or wide-open gas sizing coefficient from the Specifications section and Table 2

G = gas specific gravity of the gas

T = absolute temperature of gas at inlet, °Rankine

C<sub>1</sub> = flow coefficient

ΔP = pressure drop across the regulator, psi

To determine equivalent capacities for air, propane, butane or nitrogen, multiply the capacity by the following appropriate conversion factor: 0.775 for air, 0.625 for propane, 0.547 for butane or 0.789 for nitrogen. For gases of other specific gravities, multiply the given capacity by 0.775 and divide by the square root of the appropriate specific gravity.

Then, if capacity is desired in normal cubic meters per hour at 0°C and 1.01325 bar, multiply SCFH by 0.0268.



**Table 2. Flow and Sizing Coefficients**

BODY SIZE, NPS / DN	LINE SIZE EQUALS BODY SIZE								2:1 LINE SIZE TO BODY SIZE RATIO							
	Regulating		Wide-open		C <sub>1</sub>	IEC Sizing Coefficients			Regulating		Wide-open		C <sub>1</sub>	IEC Sizing Coefficients		
	C <sub>g</sub>	C <sub>v</sub>	C <sub>g</sub>	C <sub>v</sub>		X <sub>T</sub>	F <sub>D</sub>	F <sub>L</sub>	C <sub>g</sub>	C <sub>v</sub>	C <sub>g</sub>	C <sub>v</sub>		X <sub>T</sub>	F <sub>D</sub>	F <sub>L</sub>
<b>Type FL</b>																
1 / 25	590	18.4	610	18.9	32.1	0.65	0.73	0.89	550	16.4	570	16.9	33.5	0.71	0.69	0.89
2 / 50	2300	70.6	2400	72.7	32.6	0.67	0.69	0.89	2200	67.7	2300	69.7	32.5	0.67	0.68	0.89
3 / 80	5200	161.9	5400	166.8	32.1	0.69	0.70	0.89	4900	161.4	5000	166.3	30.4	0.58	0.70	0.89
4 / 100	8000	249.3	8200	256.8	32.1	0.65	0.65	0.89	7900	244.9	8100	252.2	32.3	0.66	0.64	0.89
6 / 150	20,300	735.8	20,900	757.8	27.6	0.48	0.71	0.89	18,400	666.7	19,000	686.7	27.6	0.48	0.67	0.89
8 / 200	30,900	1080.4	32,800	1112.8	28.6	0.52	0.66	0.89	30,600	1069.9	31,500	1102.0	28.6	0.52	0.65	0.89
10 / 250	52,100	1615.4	53,600	1663.9	32.3	0.66	0.69	0.89	51,500	1599.7	53,100	1647.7	32.2	0.66	0.69	0.89
<b>Type FL-SR</b>																
1 / 25	580	17.4	600	17.9	33.4	0.70	0.89	0.89	530	15.5	550	15.9	34.3	0.74	0.84	0.89
2 / 50	2200	65.3	2300	67.2	33.7	0.72	0.84	0.89	2100	60.7	2200	62.6	34.6	0.76	0.81	0.89
3 / 80	5000	151.7	5200	156.3	33.0	0.69	0.85	0.89	4700	149.4	4800	153.9	31.5	0.63	0.84	0.89
4 / 100	7400	226.5	7600	233.3	32.7	0.67	0.78	0.89	7300	226.0	7500	232.8	32.3	0.66	0.77	0.89
6 / 150	17,800	597.5	18,300	615.4	29.8	0.56	0.80	0.89	16,900	567.1	17,400	584.1	29.8	0.56	0.78	0.89
<b>Type FL-SR/SRS</b>																
1 / 25	570	15.6	590	16.0	36.6	0.85	0.84	0.89	500	13.5	520	13.9	37.0	0.87	0.78	0.89
2 / 50	1900	48.9	2000	50.4	38.9	0.95	0.73	0.89	1850	47.2	1900	48.6	39.2	0.97	0.71	0.89
3 / 80	4000	111.7	4100	115.1	35.8	0.81	0.73	0.89	3800	104.8	3900	107.9	36.3	0.83	0.70	0.89
4 / 100	6200	164.7	6400	169.6	37.7	0.90	0.66	0.89	6100	170.6	6300	175.7	35.8	0.81	0.67	0.89
6 / 150	14,000	436.3	14,400	449.4	32.1	0.65	0.68	0.89	13,400	417.6	13,800	430.1	32.1	0.65	0.67	0.89
<b>Type FL-SRII</b>																
1 / 25	540	16.0	560	16.5	33.5	0.82	0.05	0.89	490	14.2	500	14.6	34.5	0.73	0.04	0.89
2 / 50	2000	59.8	2100	61.6	33.4	0.81	0.03	0.89	1900	55.6	2000	57.3	34.2	0.75	0.03	0.89
3 / 80	4400	138.0	4500	142.1	30.0	0.55	0.03	0.89	4200	143.7	4300	148.0	29.3	0.54	0.03	0.89
4 / 100	6500	196.5	6700	202.4	32.9	0.69	0.02	0.89	6400	203.9	6600	210.0	31.5	0.63	0.02	0.89
6 / 150	16,200	480.7	16,700	495.1	31.7	0.65	0.02	0.89	15,400	500.7	15,800	515.7	30.7	0.60	0.02	0.89
8 / 200	25,335	784.0	26,100	807.5	32.3	0.66	0.01	0.89	24,200	749.1	24,900	771.6	32.3	0.66	0.01	0.89
10 / 250	42,500	1197.9	43,800	1233.8	35.5	0.8	0.01	0.89	40,600	1144.6	41,800	1178.9	35.5	0.8	0.58	0.89
<b>Type FL-SRII/SRS</b>																
1 / 25	530	14.3	550	14.7	37.1	0.99	0.04	0.89	520	15.2	540	15.7	33.9	0.89	0.04	0.89
2 / 50	1700	44.8	1800	46.1	38.0	0.98	0.03	0.89	1700	43.2	1800	44.5	39.4	0.96	0.03	0.89
3 / 80	3500	101.6	3600	104.6	34.4	0.65	0.02	0.89	3400	100.8	3500	103.8	33.7	0.71	0.02	0.89
4 / 100	5400	142.9	5600	147.2	37.8	0.93	0.02	0.89	5300	153.9	5500	158.5	34.4	0.77	0.02	0.89
6 / 150	12,700	351.0	13,100	361.5	36.2	0.75	0.01	0.89	12,100	386.6	12,500	398.2	31.3	0.70	0.02	0.89
8 / 200	20,100	515.0	20,700	530.5	39.0	0.96	0.01	0.89	19,200	492.1	19,800	506.9	39.0	0.66	0.01	0.89

# Bulletin 71.2:FL

**Table 3. Capacities for Type FL with PRX Series Pilot and Type SA/2 Pilot Supply Filter Regulator with 1:1 Line Size to Body Size Ratio**

INLET PRESSURE		OUTLET PRESSURE		CAPACITIES IN THOUSANDS OF SCFH / Nm <sup>3</sup> /h OF 0.6 SPECIFIC GRAVITY NATURAL GAS													
psig	bar	psig	bar	NPS 1 / DN 25 Body		NPS 2 / DN 50 Body		NPS 3 / DN 80 Body		NPS 4 / DN 100 Body		NPS 6 / DN 150 Body		NPS 8 / DN 200 Body		NPS 10 / DN 250 Body	
				SCFH	Nm <sup>3</sup> /h	SCFH	Nm <sup>3</sup> /h	SCFH	Nm <sup>3</sup> /h	SCFH	Nm <sup>3</sup> /h	SCFH	Nm <sup>3</sup> /h	SCFH	Nm <sup>3</sup> /h	SCFH	Nm <sup>3</sup> /h
30	2.1	15	1.0	30	0.8	115	3.1	262	7.0	404	10.8	1105	29.6	1656	44.4	2637	70.7
40	2.8	15	1.0	39	1.1	153	4.1	347	9.3	534	14.3	1415	37.9	2140	57.3	3489	93.5
		25	1.7	34	0.9	132	3.5	302	8.1	465	12.5	1291	34.6	1927	51.6	3028	81.2
50	3.4	15	1.0	48	1.3	186	5.0	423	11.3	651	17.4	1685	45.1	2564	68.7	4254	114
		25	1.7	45	1.2	174	4.7	395	10.6	609	16.3	1643	44.0	2472	66.2	3968	106
		35	2.4	38	1.0	148	4.0	337	9.0	519	13.9	1457	39.0	2168	58.1	3379	90.6
60	4.1	up to 16	up to 1.1	56	1.5	218	5.8	494	13.2	760	20.4	1939	52.0	2962	79.4	4965	133
		20	1.4	55	1.5	215	5.8	488	13.1	751	20.1	1947	52.2	2961	79.4	4904	131
		30	2.1	52	1.4	203	5.4	461	12.4	710	19.0	1909	51.2	2875	77.1	4626	124
		45	3.1	42	1.1	162	4.3	370	9.9	569	15.2	1608	43.1	2388	64.0	3699	99.1
75	5.2	up to 22	up to 1.5	67	1.8	262	7.0	594	15.9	913	24.5	2330	62.4	3560	95.4	5964	160
		30	2.1	66	1.8	255	6.8	581	15.6	893	23.9	2339	62.7	3548	95.1	5826	156
		40	2.8	62	1.7	242	6.5	550	14.7	847	22.7	2285	61.2	3438	92.1	5515	148
		60	4.1	47	1.3	181	4.8	414	11.1	637	17.1	1813	48.6	2687	72.0	4135	111
100	6.9	up to 32	up to 2.2	86	2.3	335	9.0	760	20.4	1169	31.3	2982	79.9	4556	122	7629	204
		40	2.8	85	2.3	329	8.8	748	20.0	1151	30.8	2995	80.3	4551	122	7502	201
		50	3.4	82	2.2	318	8.5	723	19.4	1112	29.8	2966	79.5	4476	120	7242	194
		85	5.9	54	1.5	209	5.6	478	12.8	736	19.7	2113	56.6	3126	83.8	4777	128
125	8.6	up to 43	up to 3.0	105	2.8	408	10.9	925	24.8	1424	38.2	3637	97.5	5555	149	9282	249
		50	3.4	104	2.8	403	10.8	915	24.5	1408	37.7	3650	97.8	5552	149	9174	246
		75	5.2	95	2.6	368	9.9	839	22.5	1291	34.6	3513	94.1	5272	141	8393	225
150	10.3	up to 52	up to 3.6	124	3.3	482	12.9	1093	29.3	1681	45.1	4285	115	6549	176	10,959	294
		75	5.2	119	3.2	461	12.4	1048	28.1	1613	43.2	4280	115	6469	173	10,498	281
		95	6.6	110	3.0	425	11.4	970	26.0	1493	40.0	4087	110	6124	164	9701	260
		130	9.0	76	2.0	291	7.8	666	17.8	1025	27.5	2948	79.0	4359	117	6646	178
200	13.8	up to 73	up to 5.0	162	4.3	628	16.8	1424	38.2	2192	58.7	5592	150	8544	229	14,277	383
		100	6.9	156	4.2	604	16.2	1374	36.8	2114	56.6	5591	150	8457	227	13,749	368
		125	8.7	145	3.9	562	15.1	1281	34.3	1972	52.8	5378	144	8068	216	12,812	343
		185	12.8	77	2.1	296	7.9	679	18.2	1045	28.0	3040	81.5	4481	120	6771	181
300	20.7	up to 115	up to 7.9	237	6.3	920	24.7	2088	55.9	3212	86.1	8205	220	12,533	336	20,913	560
		150	10.3	230	6.2	890	23.8	2023	54.2	3113	83.4	8212	220	12,432	333	20,246	543
		200	13.8	208	5.6	801	21.5	1828	49.0	2813	75.4	7733	207	11,575	310	18,263	489
		275	19.0	120	3.2	461	12.3	1055	28.3	1625	43.5	4716	126	6956	186	10,525	282
400	27.6	up to 155	up to 10.7	312	8.4	1214	32.5	2753	73.8	4236	114	10,812	290	16,518	443	27,573	739
		200	13.8	303	8.1	1176	31.5	2673	71.6	4113	110	10,832	290	16,404	440	26,739	717
		250	17.2	284	7.6	1097	29.4	2501	67.0	3848	103	10,464	280	15,709	421	24,989	670
		300	20.7	250	6.7	963	25.8	2200	59.0	3386	90.8	9482	254	14,122	379	21,964	589
500	34.5	up to 196	up to 13.5	388	10.4	1507	40.4	3417	91.6	5258	141	13,422	360	20,506	550	34,221	917
		225	15.5	383	10.3	1486	39.8	3375	90.4	5193	139	13,478	361	20,495	549	33,775	905
		300	20.7	359	9.6	1389	37.2	3163	84.8	4868	131	13,145	352	19,771	530	31,612	847
		400	27.6	286	7.7	1103	29.6	2522	67.6	3882	104	10,988	295	16,317	437	25,165	674
600	41.4	up to 237	up to 16.3	463	12.4	1800	48.2	4082	109	6280	168	16,033	430	24,493	656	40,869	1095
		300	20.7	451	12.1	1747	46.8	3971	106	6111	164	16,070	431	24,348	653	39,724	1065
		375	25.9	422	11.3	1632	43.7	3719	99.7	5724	153	15,547	417	23,347	626	37,161	996
		450	31.0	372	10.0	1434	38.4	3276	87.8	5041	135	14,108	378	21,014	563	32,694	876
700	48.3	up to 278	up to 19.2	539	14.4	2093	56.1	4746	127	7303	196	18,643	500	28,480	763	47,517	1273
		350	24.1	525	14.1	2033	54.5	4621	124	7110	191	18,689	501	28,319	759	46,216	1239
		400	27.6	508	13.6	1966	52.7	4476	120	6888	185	18,450	495	27,812	745	44,738	1199
		600	41.4	349	9.3	1342	36.0	3071	82.3	4726	127	13,543	363	20,045	537	30,622	821
800	55.2	up to 350	up to 24.1	609	16.3	2365	63.4	5368	144	8260	221	21,327	572	32,477	870	53,720	1440
		450	31.0	582	15.6	2254	60.4	5129	138	7893	212	21,089	565	31,813	853	51,272	1374
		609	42.0	486	13.0	1874	50.2	4281	115	6588	177	18,478	495	27,507	737	42,718	1145
900	62.1	up to 350	up to 24.1	691	18.5	2684	71.9	6086	163	9364	251	23,827	639	36,433	976	60,929	1633
		500	34.5	656	17.6	2541	68.1	5782	155	8898	239	23,723	636	35,806	960	57,797	1549
		609	42.0	604	16.2	2331	62.5	5318	143	8184	219	22,498	603	33,674	903	53,101	1423
1000	69.0	up to 350	up to 24.1	770	20.6	2995	80.3	6785	182	10,440	280	26,244	703	40,266	1079	67,954	1821
		500	34.5	746	20.0	2890	77.4	6568	176	10,107	271	26,544	711	40,232	1078	65,690	1760
		609	42.0	707	18.9	2732	73.2	6224	167	9578	257	25,890	694	38,930	1043	62,187	1667

- continued -

North America Only

**Table 3. Capacities for Type FL with PRX Series Pilot and Type SA/2 Pilot Supply Filter Regulator with 1:1 Line Size to Body Size Ratio (continued)**

INLET PRESSURE		OUTLET PRESSURE		CAPACITIES IN THOUSANDS OF SCFH / Nm <sup>3</sup> /h OF 0.6 SPECIFIC GRAVITY NATURAL GAS													
psig	bar	psig	bar	NPS 1 / DN 25 Body		NPS 2 / DN 50 Body		NPS 3 / DN 80 Body		NPS 4 / DN 100 Body		NPS 6 / DN 150 Body		NPS 8 / DN 200 Body		NPS 10 / DN 250 Body	
				SCFH	Nm <sup>3</sup> /h	SCFH	Nm <sup>3</sup> /h	SCFH	Nm <sup>3</sup> /h	SCFH	Nm <sup>3</sup> /h	SCFH	Nm <sup>3</sup> /h	SCFH	Nm <sup>3</sup> /h	SCFH	Nm <sup>3</sup> /h
1100	75.8	up to 350	up to 24.1	848	22.7	3301	88.5	7472	200	11,496	308	28,605	767	44,016	1180	74,857	2006
		500	34.5	831	22.3	3223	86.4	7319	196	11,263	302	29,199	783	44,415	1190	73,230	1963
		609	42.0	801	21.5	3102	83.1	7058	189	10,861	291	28,933	775	43,680	1171	70,547	1891
1200	82.7	up to 350	up to 24.1	925	24.8	3603	96.6	8151	218	12,540	336	30,928	829	47,710	1279	81,673	2189
		500	34.5	913	24.5	3547	95.1	8047	216	12,382	332	31,744	851	48,437	1298	80,535	2158
		609	42.0	891	23.9	3451	92.5	7845	210	12,073	324	31,761	851	48,115	1290	78,453	2103
1300	89.6	up to 350	up to 24.1	1001	26.8	3902	105	8823	237	13,573	364	33,224	890	51,362	1377	88,428	2370
		500	34.5	994	26.6	3863	104	8758	235	13,475	361	34,214	917	52,347	1403	87,675	2350
		609	42.0	976	26.2	3787	102	8603	231	13,237	355	34,444	923	52,339	1403	86,053	2306
1400	96.5	up to 350	up to 24.1	1077	28.9	4199	113	9490	254	14,600	391	35,498	951	54,984	1474	95,154	2550
		500	34.5	1073	28.8	4174	112	9457	253	14,550	390	36,628	982	56,177	1506	94,696	2538
		609	42.0	1060	28.4	4114	110	9338	250	14,369	385	37,026	992	56,415	1512	93,438	2504
1480	102	up to 350	up to 24.1	1137	30.5	4436	119	10,022	269	15,417	413	37,307	1000	57,865	1551	100,535	2694
		500	34.5	1136	30.4	4420	118	10,009	268	15,400	413	38,530	1033	59,196	1587	100,246	2687
		609	42.0	1125	30.2	4371	117	9915	266	15,255	409	39,038	1046	59,597	1597	99,228	2659

**Table 4. Capacities for Type FL with PRX-AP Series Pilot and Type SA/2 Pilot Supply Filter Regulator with 1:1 Line Size to Body Size Ratio**

INLET PRESSURE		OUTLET PRESSURE		CAPACITIES IN THOUSANDS OF SCFH / Nm <sup>3</sup> /h OF 0.6 SPECIFIC GRAVITY NATURAL GAS													
psig	bar	psig	bar	NPS 1 / DN 25 Body		NPS 2 / DN 50 Body		NPS 3 / DN 80 Body		NPS 4 / DN 100 Body		NPS 6 / DN 150 Body		NPS 8 / DN 200 Body		NPS 10 / DN 250 Body	
				SCFH	Nm <sup>3</sup> /h	SCFH	Nm <sup>3</sup> /h	SCFH	Nm <sup>3</sup> /h	SCFH	Nm <sup>3</sup> /h	SCFH	Nm <sup>3</sup> /h	SCFH	Nm <sup>3</sup> /h	SCFH	Nm <sup>3</sup> /h
500	34.5	250	17.2	377	10.1	1461	39.2	3322	89.0	5112	137	13,451	361	20,376	546	33,232	891
		300	20.7	359	9.6	1389	37.2	3163	84.8	4868	131	13,145	352	19,771	530	31,612	847
		400	27.6	286	7.7	1103	29.6	2522	67.6	3882	104	10,988	295	16,317	437	25,165	674
600	41.4	250	17.2	461	12.4	1792	48.0	4065	109	6255	168	16,069	431	24,505	657	40,695	1091
		350	24.1	434	11.6	1678	45.0	3821	102	5880	158	15,804	424	23,800	638	38,188	1023
		500	34.5	319	8.6	1228	32.9	2809	75.3	4324	116	12,327	330	18,270	490	28,021	751
700	48.3	250	17.2	542	14.5	2106	56.4	4773	128	7344	197	18,523	496	28,393	761	47,803	1281
		300	20.7	535	14.3	2078	55.7	4717	126	7258	195	18,699	501	28,493	764	47,210	1265
		400	27.6	508	13.6	1966	52.7	4476	120	6888	185	18,450	495	27,812	745	44,738	1199
800	55.2	550	37.9	410	11.0	1578	42.3	3606	96.6	5551	149	15,656	420	23,270	624	35,983	964
		up to 300	up to 20.7	616	16.5	2395	64.2	5430	146	8355	224	21,179	568	32,419	869	54,374	1457
		400	27.6	598	16.0	2318	62.1	5270	141	8109	217	21,307	571	32,290	865	52,707	1413
900	62.1	500	34.5	561	15.0	2167	58.1	4938	132	7599	204	20,630	553	30,984	830	49,332	1322
		650	44.8	444	11.9	1710	45.8	3911	105	6019	161	17,078	458	25,344	679	39,011	1045
		up to 350	up to 24.1	691	18.5	2684	71.9	6086	163	9364	251	23,827	639	36,433	976	60,929	1633
1000	69.0	400	27.6	683	18.3	2651	71.1	6019	161	9261	248	23,952	642	36,458	977	60,226	1614
		600	41.4	609	16.3	2353	63.1	5366	144	8259	221	22,648	607	33,921	909	53,591	1436
		800	55.2	402	10.8	1545	41.4	3538	94.8	5445	146	15,707	421	23,207	622	35,269	945
1100	75.8	up to 400	up to 27.6	765	20.5	2972	79.6	6740	181	10,371	278	26,470	709	40,440	1084	67,472	1808
		500	34.5	746	20.0	2890	77.4	6568	176	10,107	271	26,544	711	40,232	1078	65,690	1760
		600	41.4	711	19.1	2748	73.7	6260	168	9634	258	25,979	696	39,089	1048	62,550	1676
1200	82.7	800	55.2	568	15.2	2187	58.6	5001	134	7697	206	21,774	584	32,338	867	49,886	1337
		up to 450	up to 31.0	839	22.5	3259	87.4	7394	198	11,377	305	29,109	780	44,441	1191	74,007	1983
		600	41.4	804	21.6	3114	83.5	7085	190	10,903	292	28,983	777	43,781	1173	70,826	1898
1300	89.6	800	55.2	698	18.7	2691	72.1	6144	165	9456	253	26,306	705	39,246	1052	61,326	1644
		1000	69.0	449	12.0	1725	46.2	3951	106	6081	163	17,616	472	25,997	697	39,380	1055
		up to 500	up to 34.5	913	24.5	3547	95.1	8047	216	12,382	332	31,744	851	48,437	1298	80,535	2158
1400	96.5	600	41.4	893	23.9	3461	92.8	7867	211	12,105	324	31,782	852	48,174	1291	78,672	2108
		800	55.2	810	21.7	3129	83.9	7135	191	10,981	294	30,105	807	45,093	1209	71,253	1910
		1100	75.8	471	12.6	1808	48.5	4142	111	6376	171	18,499	496	27,289	731	41,285	1106
1480	102	up to 500	up to 34.5	994	26.6	3863	104	8758	235	13,475	361	34,214	917	52,347	1403	87,675	2350
		600	41.4	978	26.2	3795	102	8619	231	13,263	356	34,443	923	52,367	1403	86,227	2311
		800	55.2	913	24.5	3528	94.6	8038	215	12,369	332	33,477	897	50,321	1349	80,297	2152
1480	102	1160	80.0	571	15.3	2195	58.8	5027	135	7738	207	22,334	599	32,992	884	50,112	1343
		up to 500	up to 34.5	1073	28.8	4174	112	9457	253	14,550	390	36,628	982	56,177	1506	94,696	2538
		600	41.4	1061	28.4	4121	110	9351	251	14,389	386	37,009	992	56,419	1512	93,576	2508
1480	102	800	55.2	1008	27.0	3902	105	8882	238	13,669	366	36,575	980	55,149	1478	88,769	2379
		1160	80.0	747	20.0	2875	77.1	6576	176	10,122	271	28,813	772	42,721	1145	65,585	1758
		up to 500	up to 34.5	1136	30.4	4420	118	10,009	268	15,400	413	38,530	1033	59,196	1587	100,246	2687
1480	102	600	41.4	1126	30.2	4376	117	9926	266	15,272	409	39,010	1046	59,584	1597	99,343	2662
		800	55.2	1082	29.0	4189	112	9529	255	14,664	393	38,913	1043	58,810	1576	95,257	2553
		1160	80.0	863	23.1	3325	89.1	7599	204	11,696	314	32,960	883	49,003	1313	75,813	2032

North America Only

# Bulletin 71.2:FL

**Table 5. Capacities for Type FL-SR with PRX Series Pilot and Type SA/2 Pilot Supply Filter Regulator with 1:1 Line Size to Body Size Ratio**

INLET PRESSURE		OUTLET PRESSURE		CAPACITIES IN THOUSANDS OF SCFH / Nm <sup>3</sup> /h OF 0.6 SPECIFIC GRAVITY NATURAL GAS									
psig	bar	psig	bar	NPS 1 / DN 25 Body		NPS 2 / DN 50 Body		NPS 3 / DN 80 Body		NPS 4 / DN 100 Body		NPS 6 / DN 150 Body	
				SCFH	Nm <sup>3</sup> /h	SCFH	Nm <sup>3</sup> /h	SCFH	Nm <sup>3</sup> /h	SCFH	Nm <sup>3</sup> /h	SCFH	Nm <sup>3</sup> /h
30	2.1	15	1.0	29	0.8	108	2.9	249	6.7	370	9.9	935	25.1
		15	1.0	38	1.0	144	3.9	330	8.8	490	13.1	1220	32.7
40	2.8	25	1.7	33	0.9	124	3.3	285	7.6	425	11.4	1084	29.0
		15	1.0	47	1.3	176	4.7	404	10.8	599	16.1	1471	39.4
50	3.4	25	1.7	43	1.2	163	4.4	375	10.1	558	14.9	1401	37.6
		35	2.4	37	1.0	138	3.7	318	8.5	474	12.7	1216	32.6
60	4.1	up to 16	up to 1.1	55	1.5	206	5.5	472	12.7	700	18.8	1707	45.7
		20	1.4	54	1.4	203	5.4	466	12.5	691	18.5	1699	45.5
		30	2.1	50	1.3	190	5.1	438	11.7	651	17.4	1632	43.7
		45	3.1	40	1.1	151	4.0	348	9.3	519	13.9	1337	35.8
75	5.2	up to 22	up to 1.5	66	1.8	248	6.7	567	15.2	842	22.6	2051	55.0
		30	2.1	64	1.7	241	6.5	553	14.8	821	22.0	2029	54.4
		40	2.8	60	1.6	227	6.1	522	14.0	776	20.8	1950	52.2
		60	4.1	45	1.2	168	4.5	389	10.4	580	15.6	1501	40.2
100	6.9	up to 32	up to 2.2	84	2.3	318	8.5	727	19.5	1078	28.9	2626	70.4
		40	2.8	82	2.2	311	8.3	713	19.1	1058	28.4	2608	69.9
		50	3.4	79	2.1	299	8.0	687	18.4	1021	27.4	2547	68.3
		85	5.9	52	1.4	194	5.2	450	12.1	671	18.0	1742	46.7
125	8.6	up to 43	up to 3.0	102	2.7	387	10.4	884	23.7	1312	35.2	3199	85.7
		50	3.4	101	2.7	381	10.2	873	23.4	1295	34.7	3185	85.3
		75	5.2	92	2.5	345	9.3	795	21.3	1182	31.7	2983	79.9
		110	7.6	58	1.5	217	5.8	503	13.5	750	20.1	1955	52.4
150	10.3	up to 52	up to 3.6	121	3.2	457	12.2	1045	28.0	1549	41.5	3774	101
		75	5.2	115	3.1	434	11.6	997	26.7	1481	39.7	3686	98.8
		95	6.6	106	2.8	399	10.7	918	24.6	1366	36.6	3459	92.7
		130	9.0	72	1.9	270	7.2	626	16.8	933	25.0	2428	65.1
200	13.8	up to 73	up to 5.0	157	4.2	595	16.0	1362	36.5	2019	54.1	4922	132
		100	6.9	151	4.0	569	15.3	1307	35.0	1941	52.0	4823	129
		125	8.7	140	3.7	527	14.1	1214	32.5	1806	48.4	4561	122
		185	12.8	73	2.0	275	7.4	637	17.1	951	25.5	2488	66.7
300	20.7	up to 115	up to 7.9	231	6.2	872	23.4	1995	53.5	2959	79.3	7218	193
		150	10.3	222	6.0	839	22.5	1926	51.6	2860	76.6	7096	190
		200	13.8	199	5.3	750	20.1	1730	46.4	2574	69.0	6530	175
		275	19.0	114	3.0	427	11.5	991	26.6	1479	39.6	3865	104
400	27.6	up to 155	up to 10.7	304	8.2	1151	30.8	2632	70.5	3903	105	9516	255
		200	13.8	294	7.9	1109	29.7	2544	68.2	3778	101	9367	251
		250	17.2	273	7.3	1029	27.6	2370	63.5	3525	94.5	8889	238
		300	20.7	239	6.4	899	24.1	2077	55.7	3093	82.9	7926	212
500	34.5	up to 196	up to 13.5	378	10.1	1429	38.3	3267	87.5	4845	130	11,813	317
		225	15.5	372	10.0	1405	37.7	3219	86.3	4777	128	11,751	315
		300	20.7	346	9.3	1304	35.0	3001	80.4	4461	120	11,210	300
		400	27.6	273	7.3	1028	27.5	2377	63.7	3542	94.9	9130	245
600	41.4	up to 237	up to 16.3	451	12.1	1706	45.7	3902	105	5787	155	14,109	378
		300	20.7	436	11.7	1648	44.2	3781	101	5615	151	13,909	373
		375	25.9	406	10.9	1531	41.0	3526	94.5	5243	141	13,216	354
		450	31.0	355	9.5	1339	35.9	3092	82.9	4605	123	11,796	316
700	48.3	up to 278	up to 19.2	524	14.1	1984	53.2	4537	122	6728	180	16,406	440
		350	24.1	508	13.6	1918	51.4	4400	118	6533	175	16,179	434
		400	27.6	490	13.1	1849	49.6	4251	114	6317	169	15,805	424
		600	41.4	331	8.9	1247	33.4	2889	77.4	4307	115	11,178	300
800	55.2	up to 350	up to 24.1	592	15.9	2238	60.0	5123	137	7602	204	18,649	500
		450	31.0	562	15.1	2121	56.8	4873	131	7242	194	18,092	485
		609	42.0	464	12.4	1748	46.9	4040	108	6016	161	15,431	414
900	62.1	up to 350	up to 24.1	673	18.0	2546	68.2	5820	156	8630	231	21,007	563
		500	34.5	633	17.0	2392	64.1	5495	147	8164	219	20,375	546
1000	69.0	609	42.0	579	15.5	2183	58.5	5032	135	7488	201	18,997	509
		up to 350	up to 24.1	752	20.2	2847	76.3	6499	174	9632	258	23,296	624
		500	34.5	722	19.3	2727	73.1	6255	168	9288	249	22,991	616
		609	42.0	680	18.2	2566	68.8	5904	158	8778	235	22,067	591

- continued -

North America Only

**Table 5. Capacities for Type FL-SR with PRX Series Pilot and Type SA/2 Pilot Supply Filter Regulator with 1:1 Line Size to Body Size Ratio (continued)**

INLET PRESSURE		OUTLET PRESSURE		CAPACITIES IN THOUSANDS OF SCFH / Nm <sup>3</sup> /h OF 0.6 SPECIFIC GRAVITY NATURAL GAS									
psig	bar	psig	bar	NPS 1 / DN 25 Body		NPS 2 / DN 50 Body		NPS 3 / DN 80 Body		NPS 4 / DN 100 Body		NPS 6 / DN 150 Body	
				SCFH	Nm <sup>3</sup> /h	SCFH	Nm <sup>3</sup> /h	SCFH	Nm <sup>3</sup> /h	SCFH	Nm <sup>3</sup> /h	SCFH	Nm <sup>3</sup> /h
1100	75.8	up to 350	up to 24.1	830	22.2	3142	84.2	7166	192	10,617	285	25,541	685
		500	34.5	806	21.6	3048	81.7	6982	187	10,362	278	25,474	683
		609	42.0	773	20.7	2920	78.3	6708	180	9967	267	24,861	666
1200	82.7	up to 350	up to 24.1	907	24.3	3435	92.1	7826	210	11,590	311	27,753	744
		500	34.5	888	23.8	3360	90.1	7687	206	11,403	306	27,868	747
		609	42.0	862	23.1	3256	87.3	7469	200	11,092	297	27,482	737
1300	89.6	up to 350	up to 24.1	983	26.3	3725	99.8	8479	227	12,554	336	29,942	803
		500	34.5	969	26.0	3666	98.2	8377	224	12,421	333	30,201	809
		609	42.0	947	25.4	3580	95.9	8202	220	12,175	326	29,988	804
1400	96.5	up to 350	up to 24.1	1058	28.4	4013	108	9129	245	13,511	362	32,115	861
		500	34.5	1048	28.1	3966	106	9056	243	13,423	360	32,489	871
		609	42.0	1030	27.6	3895	104	8915	239	13,227	355	32,412	869
1480	102	up to 350	up to 24.1	1119	30.0	4242	114	9646	259	14,274	383	33,843	907
		500	34.5	1110	29.8	4204	113	9593	257	14,215	381	34,295	919
		609	42.0	1095	29.3	4142	111	9474	254	14,052	377	34,308	920

**Table 6. Capacities for Type FL-SR with PRX-AP Series Pilot and Type SA/2 Pilot Supply Filter Regulator with 1:1 Line Size to Body Size Ratio**

INLET PRESSURE		OUTLET PRESSURE		CAPACITIES IN THOUSANDS OF SCFH / Nm <sup>3</sup> /h OF 0.6 SPECIFIC GRAVITY NATURAL GAS									
psig	bar	psig	bar	NPS 1 / DN 25 Body		NPS 2 / DN 50 Body		NPS 3 / DN 80 Body		NPS 4 / DN 100 Body		NPS 6 / DN 150 Body	
				SCFH	Nm <sup>3</sup> /h	SCFH	Nm <sup>3</sup> /h	SCFH	Nm <sup>3</sup> /h	SCFH	Nm <sup>3</sup> /h	SCFH	Nm <sup>3</sup> /h
500	34.5	250	17.2	365	9.8	1379	36.9	3163	84.8	4697	126	11,638	312
		300	20.7	346	9.3	1304	35.0	3001	80.4	4461	120	11,210	300
		400	27.6	273	7.3	1028	27.5	2377	63.7	3542	94.9	9130	245
600	41.4	250	17.2	449	12.0	1697	45.5	3883	104	5760	154	14,091	378
		350	24.1	418	11.2	1577	42.3	3627	97.2	5391	145	13,512	362
		500	34.5	304	8.1	1143	30.6	2645	70.9	3942	106	10,202	273
700	48.3	250	17.2	529	14.2	2001	53.6	4569	123	6773	182	16,412	440
		300	20.7	520	13.9	1967	52.7	4503	121	6681	179	16,371	439
		400	27.6	490	13.1	1849	49.6	4251	114	6317	169	15,805	424
800	55.2	550	37.9	391	10.5	1471	39.4	3401	91.1	5066	136	13,034	349
		up to 300	up to 20.7	601	16.1	2274	60.9	5195	139	7703	206	18,712	502
		400	27.6	579	15.5	2188	58.6	5018	134	7451	200	18,450	495
900	62.1	500	34.5	539	14.4	2033	54.5	4681	126	6961	187	17,541	470
		650	44.8	423	11.3	1593	42.7	3685	98.8	5490	147	14,172	380
		up to 350	up to 24.1	673	18.0	2546	68.2	5820	156	8630	231	21,007	563
1000	69.0	400	27.6	663	17.8	2508	67.2	5743	154	8523	228	20,925	561
		600	41.4	584	15.7	2204	59.1	5080	136	7558	203	19,150	513
		800	55.2	381	10.2	1435	38.4	3326	89.1	4959	133	12,917	346
1100	75.8	up to 400	up to 27.6	745	20.0	2818	75.5	6443	173	9556	256	23,297	624
		500	34.5	722	19.3	2727	73.1	6255	168	9288	249	22,991	616
		600	41.4	684	18.3	2582	69.2	5940	159	8830	237	22,172	594
1200	82.7	800	55.2	541	14.5	2038	54.6	4714	126	7023	188	18,097	485
		up to 450	up to 31.0	817	21.9	3089	82.8	7066	189	10,480	281	25,584	686
		600	41.4	777	20.8	2933	78.6	6736	181	10,007	268	24,934	668
1300	89.6	800	55.2	667	17.9	2515	67.4	5805	156	8642	232	22,067	591
		1000	69.0	425	11.4	1600	42.9	3712	99.5	5536	148	14,453	387
		up to 500	up to 34.5	888	23.8	3360	90.1	7687	206	11,403	306	27,868	747
1400	96.5	600	41.4	864	23.2	3266	87.5	7492	201	11,124	298	27,532	738
		800	55.2	777	20.8	2931	78.6	6755	181	10,050	269	25,459	682
		1100	75.8	446	12.0	1677	44.9	3891	104	5803	156	15,164	406
1480	102	up to 500	up to 34.5	969	26.0	3666	98.2	8377	225	12,421	333	30,201	809
		600	41.4	949	25.4	3588	96.2	8220	220	12,200	327	30,021	805
		800	55.2	878	23.5	3312	88.8	7623	204	11,334	304	28,514	764
1480	102	1160	80.0	542	14.5	2038	54.6	4725	127	7046	189	18,360	492
		up to 500	up to 34.5	1048	28.1	3966	106	9056	243	13,423	360	32,489	871
		600	41.4	1032	27.7	3902	105	8930	239	13,248	355	32,431	869
1480	102	800	55.2	972	26.1	3671	98.4	8437	226	12,539	336	31,350	840
		1160	80.0	711	19.0	2676	71.7	6194	166	9230	247	23,867	640
		up to 500	up to 34.5	1110	29.8	4204	113	9593	257	14,215	381	34,295	919
1480	102	600	41.4	1097	29.4	4148	111	9487	254	14,070	377	34,318	920
		800	55.2	1045	28.0	3946	106	9062	243	13,462	361	33,509	898
		1160	80.0	823	22.1	3100	83.1	7167	192	10,676	286	27,453	736

North America Only

# Bulletin 71.2:FL

**Table 7. Capacities for Type FL-SR/SRS with PRX Series Pilot and Type SA/2 Pilot Supply Filter Regulator with 1:1 Line Size to Body Size Ratio**

INLET PRESSURE		OUTLET PRESSURE		CAPACITIES IN THOUSANDS OF SCFH / Nm <sup>3</sup> /h OF 0.6 SPECIFIC GRAVITY NATURAL GAS									
psig	bar	psig	bar	NPS 1 / DN 25 Body		NPS 2 / DN 50 Body		NPS 3 / DN 80 Body		NPS 4 / DN 100 Body		NPS 6 / DN 150 Body	
				SCFH	Nm <sup>3</sup> /h	SCFH	Nm <sup>3</sup> /h	SCFH	Nm <sup>3</sup> /h	SCFH	Nm <sup>3</sup> /h	SCFH	Nm <sup>3</sup> /h
30	2.1	15	1.0	26	0.7	85	2.3	189	5.1	282	7.6	707	18.9
40	2.8	15	1.0	36	1.0	115	3.1	254	6.8	382	10.2	935	25.1
		25	1.7	30	0.8	96	2.6	215	5.8	321	8.6	813	21.8
50	3.4	15	1.0	44	1.2	143	3.8	313	8.4	474	12.7	1139	30.5
		25	1.7	40	1.1	129	3.5	286	7.7	430	11.5	1065	28.5
		35	2.4	34	0.9	107	2.9	239	6.4	356	9.6	909	24.4
60	4.1	up to 16	up to 1.1	52	1.4	169	4.5	368	9.9	558	15.0	1330	35.6
		20	1.4	51	1.4	165	4.4	361	9.7	546	14.6	1314	35.2
		30	2.1	47	1.3	151	4.0	334	9.0	503	13.5	1242	33.3
		45	3.1	37	1.0	116	3.1	261	7.0	388	10.4	996	26.7
75	5.2	up to 22	up to 1.5	62	1.7	203	5.4	442	11.9	671	18.0	1598	42.8
		30	2.1	60	1.6	194	5.2	427	11.4	645	17.3	1563	41.9
		40	2.8	56	1.5	180	4.8	398	10.7	598	16.0	1482	39.7
		60	4.1	41	1.1	129	3.5	291	7.8	432	11.6	1114	29.9
100	6.9	up to 32	up to 2.2	80	2.1	260	7.0	566	15.2	860	23.0	2046	54.8
		40	2.8	78	2.1	251	6.7	552	14.8	834	22.4	2014	54.0
		50	3.4	74	2.0	238	6.4	527	14.1	793	21.2	1947	52.2
		85	5.9	47	1.3	148	4.0	335	9.0	497	13.3	1288	34.5
125	8.6	up to 43	up to 3.0	97	2.6	316	8.5	689	18.5	1045	28.0	2491	66.8
		50	3.4	95	2.6	309	8.3	676	18.1	1023	27.4	2464	66.0
		75	5.2	85	2.3	272	7.3	605	16.2	906	24.3	2259	60.5
		110	7.6	52	1.4	165	4.4	374	10.0	554	14.8	1442	38.6
150	10.3	up to 52	up to 3.6	115	3.1	373	10.0	814	21.8	1237	33.1	2942	78.9
		75	5.2	108	2.9	347	9.3	766	20.5	1154	30.9	2823	75.7
		95	6.6	98	2.6	313	8.4	697	18.7	1043	28.0	2612	70.0
		130	9.0	65	1.7	206	5.5	466	12.5	690	18.5	1793	48.1
200	13.8	up to 73	up to 5.0	150	4.0	486	13.0	1061	28.4	1611	43.2	3835	103
		100	6.9	141	3.8	456	12.2	1005	26.9	1514	40.6	3699	99.1
		125	8.7	130	3.5	414	11.1	922	24.7	1382	37.0	3451	92.5
		185	12.8	66	1.8	208	5.6	472	12.7	698	18.7	1829	49.0
300	20.7	up to 115	up to 7.9	219	5.9	712	19.1	1554	41.6	2358	63.2	5621	151
		150	10.3	209	5.6	673	18.0	1482	39.7	2236	59.9	5448	146
		200	13.8	184	4.9	587	15.7	1310	35.1	1960	52.5	4923	132
		275	19.0	103	2.7	323	8.7	735	19.7	1087	29.1	2843	76.2
400	27.6	up to 155	up to 10.7	290	7.8	940	25.2	2050	54.9	3112	83.4	7413	199
		200	13.8	276	7.4	890	23.8	1959	52.5	2956	79.2	7197	193
		250	17.2	253	6.8	811	21.7	1803	48.3	2703	72.5	6734	181
		300	20.7	219	5.9	696	18.6	1562	41.9	2328	62.4	5926	159
		350	24.1	163	4.4	517	13.8	1170	31.4	1734	46.5	4506	121
500	34.5	up to 196	up to 13.5	359	9.6	1167	31.3	2545	68.2	3863	104	9202	247
		225	15.5	352	9.4	1137	30.5	2492	66.8	3771	101	9088	244
		300	20.7	322	8.6	1031	27.6	2289	61.3	3437	92.1	8518	228
		400	27.6	249	6.7	790	21.2	1780	47.7	2647	70.9	6793	182
600	41.4	up to 237	up to 16.3	429	11.5	1393	37.3	3040	81.5	4614	124	10,991	295
		300	20.7	410	11.0	1324	35.5	2914	78.1	4398	118	10,695	287
		375	25.9	377	10.1	1207	32.3	2683	71.9	4024	108	10,017	268
		450	31.0	326	8.7	1037	27.8	2326	62.3	3468	92.9	8823	236
700	48.3	up to 278	up to 19.2	499	13.4	1620	43.4	3534	94.7	5364	144	12,780	343
		350	24.1	478	12.8	1541	41.3	3391	90.9	5118	137	12,443	334
		400	27.6	457	12.3	1469	39.4	3253	87.2	4891	131	12,054	323
		600	41.4	301	8.1	952	25.5	2153	57.7	3194	85.6	8271	222
800	55.2	up to 350	up to 24.1	561	15.0	1816	48.7	3975	107	6020	161	14,455	387
		450	31.0	525	14.1	1688	45.2	3733	100	5616	151	13,813	370
		609	42.0	425	11.4	1352	36.2	3036	81.4	4524	121	11,530	309
900	62.1	up to 350	up to 24.1	641	17.2	2083	55.8	4539	122	6894	185	16,387	439
		500	34.5	593	15.9	1906	51.1	4212	113	6340	170	15,571	417
		609	42.0	535	14.3	1708	45.8	3812	102	5704	153	14,322	384
1000	69.0	up to 350	up to 24.1	720	19.3	2344	62.8	5091	136	7749	208	18,269	490
		500	34.5	679	18.2	2192	58.7	4822	129	7280	195	17,688	474
		609	42.0	633	17.0	2028	54.4	4502	121	6758	181	16,762	449

- continued -

North America Only

**Table 7. Capacities for Type FL-SR/SRS with PRX Series Pilot and Type SA/2 Pilot Supply Filter Regulator with 1:1 Line Size to Body Size Ratio (continued)**

INLET PRESSURE		OUTLET PRESSURE		CAPACITIES IN THOUSANDS OF SCFH / Nm <sup>3</sup> /h OF 0.6 SPECIFIC GRAVITY NATURAL GAS									
psig	bar	psig	bar	NPS 1 / DN 25 Body		NPS 2 / DN 50 Body		NPS 3 / DN 80 Body		NPS 4 / DN 100 Body		NPS 6 / DN 150 Body	
				SCFH	Nm <sup>3</sup> /h	SCFH	Nm <sup>3</sup> /h	SCFH	Nm <sup>3</sup> /h	SCFH	Nm <sup>3</sup> /h	SCFH	Nm <sup>3</sup> /h
1100	75.8	up to 350	up to 24.1	798	21.4	2602	69.7	5635	151	8593	230	20,118	539
		500	34.5	763	20.4	2468	66.1	5409	145	8185	219	19,710	528
		609	42.0	724	19.4	2328	62.4	5143	138	7743	208	19,006	509
1200	82.7	up to 350	up to 24.1	874	23.4	2857	76.6	6173	165	9428	253	21,944	588
		500	34.5	844	22.6	2737	73.4	5979	160	9068	243	21,668	581
		609	42.0	811	21.7	2614	70.1	5754	154	8684	233	21,127	566
1300	89.6	up to 350	up to 24.1	951	25.5	3111	83.4	6706	180	10,257	275	23,754	637
		500	34.5	924	24.8	3002	80.5	6539	175	9935	266	23,581	632
		609	42.0	895	24.0	2892	77.5	6345	170	9596	257	23,165	621
1400	96.5	up to 350	up to 24.1	1026	27.5	3363	90.1	7237	194	11,081	297	25,550	685
		500	34.5	1003	26.9	3263	87.5	7091	190	10,790	289	25,463	682
		609	42.0	977	26.2	3164	84.8	6921	186	10,487	281	25,145	674
1480	102	up to 350	up to 24.1	1087	29.1	3564	95.5	7659	205	11,738	315	26,980	723
		500	34.5	1065	28.5	3470	93.0	7528	202	11,468	307	26,950	722
		609	42.0	1041	27.9	3378	90.5	7374	198	11,188	300	26,697	716

**Table 8. Capacities for Type FL-SR/SRS with PRX-AP Series Pilot and Type SA/2 Pilot Supply Filter Regulator with 1:1 Line Size to Body Size Ratio**

INLET PRESSURE		OUTLET PRESSURE		CAPACITIES IN THOUSANDS OF SCFH / Nm <sup>3</sup> /h OF 0.6 SPECIFIC GRAVITY NATURAL GAS									
psig	bar	psig	bar	NPS 1 / DN 25 Body		NPS 2 / DN 50 Body		NPS 3 / DN 80 Body		NPS 4 / DN 100 Body		NPS 6 / DN 150 Body	
				SCFH	Nm <sup>3</sup> /h	SCFH	Nm <sup>3</sup> /h	SCFH	Nm <sup>3</sup> /h	SCFH	Nm <sup>3</sup> /h	SCFH	Nm <sup>3</sup> /h
500	34.5	250	17.2	343	9.2	1106	29.6	2436	65.3	3674	98.5	8945	240
		300	20.7	322	8.6	1031	27.6	2289	61.3	3434	92.0	8517	228
		400	27.6	249	6.7	789	21.2	1780	47.7	2644	70.9	6792	182
600	41.4	250	17.2	426	11.4	1380	37.0	3018	80.9	4572	123	10,946	293
		350	24.1	390	10.4	1250	33.5	2772	74.3	4162	112	10,288	276
		500	34.5	276	7.4	874	23.4	1975	52.9	2930	78.5	7565	203
700	48.3	250	17.2	506	13.5	1644	44.0	3575	95.8	5436	146	12,851	344
		300	20.7	494	13.2	1597	42.8	3497	93.7	5295	142	12,701	340
		400	27.6	458	12.3	1468	39.3	3253	87.2	4887	131	12,052	323
800	55.2	550	37.9	357	9.6	1132	30.3	2550	68.3	3791	102	9711	260
		up to 300	up to 20.7	574	15.4	1863	49.9	4058	109	6164	165	14,621	392
		400	27.6	545	14.6	1756	47.1	3868	104	5834	156	14,190	380
900	62.1	500	34.5	501	13.4	1602	42.9	3564	95.5	5340	143	13,296	356
		650	44.8	386	10.3	1222	32.7	2757	73.9	4093	110	10,531	282
		up to 350	up to 24.1	641	17.2	2081	55.8	4539	122	6890	185	16,386	439
1000	69.0	400	27.6	628	16.8	2032	54.5	4453	119	6738	181	16,206	434
		600	41.4	541	14.5	1726	46.3	3852	103	5761	154	14,450	387
		800	55.2	345	9.3	1089	29.2	2472	66.2	3656	98.0	9527	255
1100	75.8	up to 400	up to 27.6	709	19.0	2300	61.6	5020	135	7615	204	18,148	486
		500	34.5	679	18.2	2190	58.7	4822	129	7274	195	17,686	474
		600	41.4	637	17.1	2042	54.7	4533	122	6803	182	16,856	452
1200	82.7	800	55.2	494	13.2	1566	42.0	3531	94.6	5245	141	13,466	361
		up to 450	up to 31.0	777	20.8	2518	67.5	5500	147	8339	224	19,908	534
		600	41.4	728	19.5	2339	62.7	5169	139	7779	209	19,078	511
1300	89.6	800	55.2	614	16.4	1952	52.3	4377	117	6526	175	16,545	443
		1000	69.0	385	10.3	1212	32.5	2754	73.8	4070	109	10,640	285
		up to 500	up to 34.5	844	22.6	2736	73.3	5979	160	9063	243	21,666	581
1400	96.5	600	41.4	814	21.8	2624	70.3	5776	155	8714	234	21,182	568
		800	55.2	719	19.3	2296	61.5	5123	137	7661	205	19,213	515
		1100	75.8	403	10.8	1269	34.0	2885	77.3	4262	114	11,155	299
1480	102	up to 500	up to 34.5	924	24.8	3000	80.4	6539	175	9930	266	23,580	632
		600	41.4	898	24.1	2900	77.7	6364	171	9621	258	23,208	622
		800	55.2	816	21.9	2614	70.1	5810	156	8712	234	21,643	580
1480	102	1160	80.0	490	13.1	1547	41.5	3511	94.1	5193	139	13,538	363
		up to 500	up to 34.5	1003	26.9	3261	87.4	7091	190	10,785	289	25,462	682
		600	41.4	979	26.2	3171	85.0	6938	186	10,509	282	25,178	675
1480	102	800	55.2	909	24.4	2917	78.2	6459	173	9707	260	23,917	641
		1160	80.0	647	17.3	2048	54.9	4628	124	6866	184	17,709	475
		up to 500	up to 34.5	1065	28.5	3469	93.0	7528	202	11,462	307	26,949	722
1480	102	600	41.4	1044	28.0	3384	90.7	7389	198	11,207	300	26,724	716
		800	55.2	980	26.3	3150	84.4	6958	187	10,476	281	25,658	688
		1160	80.0	753	20.2	2388	64.0	5377	144	7995	214	20,464	548

North America Only

# Bulletin 71.2:FL

**Table 9. Capacities for Type FL-SR11 with PRX Series Pilot and Type SA/2 Pilot Supply Filter Regulator with 1:1 Line Size to Body Size Ratio**

INLET PRESSURE		OUTLET PRESSURE		CAPACITIES IN THOUSANDS OF SCFH / Nm <sup>3</sup> /h OF 0.6 SPECIFIC GRAVITY NATURAL GAS													
psig	bar	psig	bar	NPS 1 / DN 25 Body		NPS 2 / DN 50 Body		NPS 3 / DN 80 Body		NPS 4 / DN 100 Body		NPS 6 / DN 150 Body		NPS 8 / DN 200 Body		NPS 10 / DN 250 Body	
				SCFH	Nm <sup>3</sup> /h	SCFH	Nm <sup>3</sup> /h	SCFH	Nm <sup>3</sup> /h	SCFH	Nm <sup>3</sup> /h	SCFH	Nm <sup>3</sup> /h	SCFH	Nm <sup>3</sup> /h	SCFH	Nm <sup>3</sup> /h
30	2.1	15	1.0	27	0.7	99	2.6	230	6.2	323	8.7	823	22.1	1274	34.1	2025	54.3
40	2.8	15	1.0	35	0.9	131	3.5	301	8.1	429	11.5	1087	29.1	1687	45.2	2719	72.9
		25	1.7	30	0.8	113	3.0	267	7.1	371	10.0	949	25.4	1465	39.3	2310	61.9
50	3.4	15	1.0	43	1.2	161	4.3	363	9.7	525	14.1	1322	35.4	2058	55.1	3350	89.8
		25	1.7	40	1.1	149	4.0	345	9.3	488	13.1	1240	33.2	1921	51.5	3066	82.2
		35	2.4	34	0.9	126	3.4	299	8.0	414	11.1	1061	28.4	1637	43.9	2565	68.7
60	4.1	16	up to 1.1	51	1.4	188	5.0	422	11.3	614	16.5	1542	41.3	2403	64.4	3935	105
		20	1.4	50	1.3	185	5.0	419	11.2	606	16.2	1526	40.9	2374	63.6	3859	103
		30	2.1	47	1.3	174	4.7	402	10.8	570	15.3	1446	38.7	2241	60.1	3581	96.0
		45	3.1	37	1.0	138	3.7	329	8.8	454	12.2	1163	31.2	1793	48.1	2798	75.0
75	5.2	22	up to 1.5	61	1.6	226	6.1	507	13.6	738	19.8	1854	49.7	2889	77.4	4728	127
		30	2.1	59	1.6	220	5.9	501	13.4	719	19.3	1816	48.7	2823	75.6	4565	122
		40	2.8	56	1.5	207	5.6	481	12.9	679	18.2	1725	46.2	2673	71.6	4263	114
		60	4.1	41	1.1	154	4.1	369	9.9	507	13.6	1302	34.9	2005	53.7	3117	83.5
100	6.9	32	up to 2.2	78	2.1	290	7.8	649	17.4	945	25.3	2373	63.6	3698	99.1	6049	162
		40	2.8	77	2.1	284	7.6	644	17.3	928	24.9	2339	62.7	3637	97.5	5895	158
		50	3.4	74	2.0	273	7.3	628	16.8	894	23.9	2264	60.7	3512	94.1	5629	151
		85	5.9	48	1.3	178	4.8	428	11.5	586	15.7	1506	40.4	2318	62.1	3587	96.1
125	8.6	43	up to 3.0	95	2.5	352	9.4	790	21.2	1150	30.8	2890	77.4	4502	121	7354	197
		50	3.4	94	2.5	348	9.3	786	21.1	1135	30.4	2861	76.7	4450	119	7221	194
		75	5.2	85	2.3	315	8.5	735	19.7	1034	27.7	2631	70.5	4073	109	6463	173
		110	7.6	54	1.4	199	5.3	480	12.9	655	17.6	1687	45.2	2595	69.5	4003	107
150	10.3	52	up to 3.6	112	3.0	416	11.2	933	25.0	1359	36.4	3412	91.5	5318	143	8692	233
		75	5.2	107	2.9	396	10.6	909	24.4	1297	34.8	3283	88.0	5095	137	8179	219
		95	6.6	98	2.6	364	9.8	852	22.8	1195	32.0	3044	81.6	4710	126	7450	200
		130	9.0	67	1.8	248	6.6	597	16.0	815	21.8	2097	56.2	3227	86.5	4985	134
200	13.8	73	up to 5.0	146	3.9	543	14.5	1216	32.6	1771	47.5	4448	119	6931	186	11,318	303
		100	6.9	140	3.8	520	13.9	1190	31.9	1700	45.6	4300	115	6676	179	10,726	287
		125	8.6	130	3.5	482	12.9	1124	30.1	1580	42.3	4020	108	6222	167	9856	264
		185	12.8	68	1.8	252	6.7	611	16.4	830	22.2	2140	57.3	3289	88.2	5052	135
300	20.7	115	up to 7.9	215	5.7	795	21.3	1783	47.8	2595	69.5	6520	175	10,158	272	16,570	444
		150	10.3	207	5.5	766	20.5	1751	46.9	2505	67.1	6333	170	9835	264	15,815	424
		200	13.8	185	5.0	686	18.4	1608	43.1	2251	60.3	5738	154	8873	238	13,998	375
		275	19.0	105	2.8	392	10.5	949	25.4	1290	34.6	3326	89.2	5115	137	7861	211
400	27.6	155	up to 10.7	283	7.6	1049	28.1	2351	63.0	3422	91.7	8598	230	13,397	359	21,856	586
		200	13.8	273	7.3	1012	27.1	2311	61.9	3309	88.7	8365	224	12,993	348	20,902	560
		250	17.2	254	6.8	941	25.2	2190	58.7	3084	82.6	7844	210	12,143	325	19,251	516
		300	20.7	222	5.9	823	22.1	1950	52.3	2703	72.4	6916	185	10,675	286	16,690	447
500	34.5	350	24.1	167	4.5	622	16.7	1499	40.2	2048	54.9	5269	141	8108	217	12,513	335
		196	up to 13.5	351	9.4	1302	34.9	2919	78.2	4248	114	10,673	286	16,629	446	27,125	727
		225	15.5	346	9.3	1282	34.3	2901	77.8	4187	112	10,552	283	16,414	440	26,576	712
		300	20.7	321	8.6	1191	31.9	2763	74.0	3904	105	9917	266	15,364	412	24,431	655
600	41.4	400	27.6	253	6.8	941	25.2	2245	60.2	3094	82.9	7934	213	12,232	328	19,025	510
		237	up to 16.3	420	11.2	1555	41.7	3486	93.4	5074	136	12,748	342	19,862	532	32,394	868
		300	20.7	406	10.9	1504	40.3	3432	92.0	4919	132	12,429	333	19,307	517	31,074	833
		375	25.9	377	10.1	1399	37.5	3256	87.3	4587	123	11,666	313	18,063	484	28,643	768
700	48.3	450	31.0	330	8.8	1225	32.8	2903	77.8	4024	108	10,296	276	15,892	426	24,852	666
		278	up to 19.2	488	13.1	1808	48.5	4054	109	5900	158	14,823	397	23,095	619	37,663	1009
		350	24.1	472	12.6	1750	46.9	3993	107	5723	153	14,460	388	22,464	602	36,160	969
		400	27.6	455	12.2	1689	45.3	3897	104	5530	148	14,025	376	21,746	583	34,704	930
800	55.2	600	41.4	308	8.2	1143	30.6	2747	73.6	3761	101	9669	259	14,887	399	23,017	617
		350	up to 24.1	550	14.8	2041	54.7	4606	123	6664	179	16,778	450	26,112	700	42,368	1135
		450	31.0	522	14.0	1936	51.9	4461	120	6340	170	16,070	431	24,924	668	39,821	1067
		609	42.0	431	11.6	1600	42.9	3797	102	5258	141	13,458	361	20,767	557	32,437	869
900	62.1	350	up to 24.1	626	16.8	2320	62.2	5191	139	7568	203	19,003	509	29,617	794	48,363	1296
		500	34.5	589	15.8	2184	58.5	5024	135	7148	192	18,112	485	28,096	753	44,930	1204
		609	42.0	538	14.4	1996	53.5	4678	125	6548	176	16,694	447	25,815	692	40,702	1091
1000	69.0	350	up to 24.1	700	18.8	2593	69.5	5760	154	8451	227	21,169	567	33,033	885	54,226	1453
		500	34.5	671	18.0	2488	66.7	5674	152	8136	218	20,554	551	31,934	856	51,417	1378
		609	42.0	632	16.9	2344	62.8	5438	146	7681	206	19,516	523	30,232	810	48,041	1287

- continued -

North America Only



**Table 9. Capacities for Type FL-SR11 with PRX Series Pilot and Type SA/2 Pilot Supply Filter Regulator with 1:1 Line Size to Body Size Ratio (continued)**

INLET PRESSURE		OUTLET PRESSURE		CAPACITIES IN THOUSANDS OF SCFH / Nm <sup>3</sup> /h OF 0.6 SPECIFIC GRAVITY NATURAL GAS													
psig	bar	psig	bar	NPS 1 / DN 25 Body		NPS 2 / DN 50 Body		NPS 3 / DN 80 Body		NPS 4 / DN 100 Body		NPS 6 / DN 150 Body		NPS 8 / DN 200 Body		NPS 10 / DN 250 Body	
				SCFH	Nm <sup>3</sup> /h	SCFH	Nm <sup>3</sup> /h	SCFH	Nm <sup>3</sup> /h	SCFH	Nm <sup>3</sup> /h	SCFH	Nm <sup>3</sup> /h	SCFH	Nm <sup>3</sup> /h	SCFH	Nm <sup>3</sup> /h
1100	75.8	350	up to 24.1	772	20.7	2861	76.7	6318	169	9318	250	23,296	624	36,389	975	59,999	1608
		500	34.5	750	20.1	2780	74.5	6290	169	9081	243	22,884	613	35,600	954	57,650	1545
		609	42.0	719	19.3	2666	71.4	6131	164	8726	234	22,107	593	34,297	919	54,863	1470
1200	82.7	350	up to 24.1	844	22.6	3126	83.8	6868	184	10,175	273	25,396	681	39,703	1064	65,709	1761
		500	34.5	826	22.1	3063	82.1	6885	185	9998	268	25,139	674	39,151	1049	63,715	1708
		609	42.0	801	21.5	2971	79.6	6781	182	9716	260	24,554	658	38,141	1022	61,359	1644
1300	89.6	350	up to 24.1	915	24.5	3389	90.8	7413	199	11,024	295	27,476	736	42,987	1152	71,374	1913
		500	34.5	901	24.2	3340	89.5	7464	200	10,894	292	27,342	733	42,623	1142	69,661	1867
		609	42.0	881	23.6	3265	87.5	7403	198	10,668	286	26,903	721	41,836	1121	67,636	1813
1400	96.5	350	up to 24.1	985	26.4	3650	97.8	7953	213	11,868	318	29,541	792	46,249	1240	77,005	2064
		500	34.5	975	26.1	3613	96.8	8033	215	11,776	316	29,506	791	46,037	1234	75,519	2024
		609	42.0	958	25.7	3551	95.2	8005	215	11,595	311	29,183	782	45,426	1217	73,757	1977
1480	102	350	up to 24.1	1041	27.9	3858	103	8382	225	12,539	336	31,185	836	48,845	1309	81,490	2184
		500	34.5	1033	27.7	3828	103	8482	227	12,473	334	31,217	837	48,735	1306	80,159	2148
		609	42.0	1018	27.3	3775	101	8476	227	12,321	330	30,970	830	48,242	1293	78,571	2106

**Table 10. Capacities for Type FL-SR11 with PRX-AP Series Pilot and Type SA/2 Pilot Supply Filter Regulator with 1:1 Line Size to Body Size Ratio**

INLET PRESSURE		OUTLET PRESSURE		CAPACITIES IN THOUSANDS OF SCFH / Nm <sup>3</sup> /h OF 0.6 SPECIFIC GRAVITY NATURAL GAS													
psig	bar	psig	bar	NPS 1 / DN 25 Body		NPS 2 / DN 50 Body		NPS 3 / DN 80 Body		NPS 4 / DN 100 Body		NPS 6 / DN 150 Body		NPS 8 / DN 200 Body		NPS 10 / DN 250 Body	
				SCFH	Nm <sup>3</sup> /h	SCFH	Nm <sup>3</sup> /h	SCFH	Nm <sup>3</sup> /h	SCFH	Nm <sup>3</sup> /h	SCFH	Nm <sup>3</sup> /h	SCFH	Nm <sup>3</sup> /h	SCFH	Nm <sup>3</sup> /h
500	34.5	250	17.2	339	9.1	1258	33.7	2872	77.0	4114	110	10,397	279	16,150	433	25,988	696
		300	20.7	321	8.6	1191	31.9	2763	74.0	3904	105	9917	266	15,364	412	24,431	655
		400	27.6	253	6.8	941	25.2	2245	60.2	3094	82.9	7934	213	12,232	328	19,025	510
600	41.4	250	17.2	417	11.2	1547	41.5	3481	93.3	5050	135	12,702	340	19,778	530	32,166	862
		350	24.1	388	10.4	1441	38.6	3331	89.3	4719	127	11,975	321	18,561	497	29,577	793
		500	34.5	282	7.6	1046	28.0	2508	67.2	3443	92.3	8842	237	13,622	365	21,113	566
700	48.3	250	17.2	492	13.2	1823	48.8	4057	109	5942	159	14,894	399	23,234	623	38,089	1021
		300	20.7	484	13.0	1794	48.1	4043	108	5857	157	14,741	395	22,947	615	37,269	999
		400	27.6	455	12.2	1689	45.3	3897	104	5530	148	14,025	376	21,746	583	34,704	930
		550	37.9	363	9.7	1346	36.1	3206	85.9	4426	119	11,342	304	17,492	469	27,249	730
800	55.2	up to 300	up to 20.7	559	15.0	2072	55.5	4625	124	6756	181	16,951	454	26,429	708	43,232	1159
		400	27.6	538	14.4	1996	53.5	4553	122	6527	175	16,492	442	25,621	687	41,246	1105
		500	34.5	501	13.4	1858	49.8	4322	116	6091	163	15,488	415	23,981	643	38,034	1019
900	62.1	650	44.8	393	10.5	1458	39.1	3485	93.4	4796	129	12,305	330	18,966	508	29,461	790
		up to 350	up to 24.1	626	16.8	2320	62.2	5191	139	7568	203	19,003	509	29,617	794	48,363	1296
		400	27.6	617	16.5	2287	61.3	5167	139	7470	200	18,815	504	29,276	785	47,464	1272
1000	69.0	600	41.4	543	14.6	2015	54.0	4716	126	6610	177	16,844	451	26,053	698	41,124	1102
		800	55.2	354	9.5	1314	35.2	3174	85.1	4329	116	11,145	299	17,147	460	26,424	708
		up to 400	up to 27.6	693	18.6	2568	68.8	5757	154	8379	225	21,051	564	32,799	879	53,486	1433
		500	34.5	671	18.0	2488	66.7	5674	152	8136	218	20,554	551	31,934	856	51,417	1378
1100	75.8	600	41.4	636	17.0	2359	63.2	5465	147	7728	207	19,626	526	30,409	815	48,373	1296
		800	55.2	503	13.5	1866	50.0	4451	119	6135	164	15,731	422	24,254	650	37,726	1011
		up to 450	up to 31.0	760	20.4	2816	75.5	6321	169	9189	246	23,096	619	35,977	964	58,603	1571
		600	41.4	722	19.3	2678	71.8	6150	165	8763	235	22,190	595	34,432	923	55,134	1478
1200	82.7	800	55.2	620	16.6	2300	61.6	5431	146	7554	203	19,305	517	29,816	799	46,746	1253
		1000	69.0	395	10.6	1467	39.3	3551	95.2	4832	130	12,450	334	19,147	513	29,445	789
		up to 500	up to 34.5	826	22.1	3063	82.1	6885	185	9998	268	25,139	674	39,151	1049	63,715	1708
		600	41.4	804	21.5	2980	79.9	6794	182	9745	261	24,617	660	38,247	1025	61,587	1651
1300	89.6	800	55.2	722	19.4	2680	71.8	6270	168	8790	236	22,396	600	34,642	928	54,686	1466
		1100	75.8	414	11.1	1537	41.2	3725	99.8	5065	136	13,055	350	20,074	538	30,845	827
		up to 500	up to 34.5	901	24.2	3340	89.5	7464	200	10,894	292	27,342	733	42,623	1142	69,661	1867
		600	41.4	883	23.7	3273	87.7	7412	199	10,692	287	26,952	722	41,920	1124	67,832	1818
1400	96.5	800	55.2	816	21.9	3026	81.1	7027	188	9918	266	25,205	676	39,039	1046	61,996	1661
		1160	80.0	503	13.5	1868	50.1	4511	121	6151	165	15,837	424	24,366	653	37,534	1006
		up to 500	up to 34.5	975	26.1	3613	96.8	8033	215	11,776	316	29,506	791	46,037	1234	75,519	2024
		600	41.4	960	25.7	3557	95.3	8011	215	11,614	311	29,221	783	45,493	1219	73,928	1981
1480	102	800	55.2	904	24.2	3352	89.8	7730	207	10,977	294	27,832	746	43,159	1157	68,897	1846
		1160	80.0	660	17.7	2450	65.7	5868	157	8061	216	20,697	555	31,889	855	49,452	1325
		up to 500	up to 34.5	1033	27.7	3828	103	8482	227	12,473	334	31,217	837	48,735	1306	80,159	2148
		600	41.4	1020	27.3	3781	101	8480	227	12,337	331	31,000	831	48,297	1294	78,724	2110
1480	102	800	55.2	971	26.0	3602	96.5	8265	222	11,788	316	29,841	800	46,313	1241	74,210	1989
		1160	80.0	764	20.5	2838	76.0	6753	181	9328	250	23,899	641	36,862	988	57,439	1539

North America Only

# Bulletin 71.2:FL

**Table 11. Capacities for Type FL-SRII/SRS with PRX Series Pilot and Type SA/2 Pilot Supply Filter Regulator with 1:1 Line Size to Body Size Ratio**

INLET PRESSURE		OUTLET PRESSURE		CAPACITIES IN THOUSANDS OF SCFH / Nm <sup>3</sup> /h OF 0.6 SPECIFIC GRAVITY NATURAL GAS											
psig	bar	psig	bar	NPS 1 / DN 25 Body		NPS 2 / DN 50 Body		NPS 3 / DN 80 Body		NPS 4 / DN 100 Body		NPS 6 / DN 150 Body		NPS 8 / DN 200 Body	
				SCFH	Nm <sup>3</sup> /h	SCFH	Nm <sup>3</sup> /h	SCFH	Nm <sup>3</sup> /h	SCFH	Nm <sup>3</sup> /h	SCFH	Nm <sup>3</sup> /h	SCFH	Nm <sup>3</sup> /h
30	2.1	15	1.0	24	0.7	77	2.1	169	4.5	245	6.6	594	15.9	893	23.9
40	2.8	15	1.0	33	0.9	104	2.8	227	6.1	332	8.9	801	21.5	1213	32.5
		25	1.7	28	0.7	88	2.3	194	5.2	279	7.5	678	18.2	1014	27.2
50	3.4	15	1.0	41	1.1	129	3.5	278	7.5	412	11.0	988	26.5	1508	40.4
		25	1.7	37	1.0	117	3.1	256	6.9	373	10.0	902	24.2	1361	36.5
		35	2.4	31	0.8	97	2.6	216	5.8	309	8.3	753	20.2	1123	30.1
60	4.1	up to 16	up to 1.1	48	1.3	152	4.1	326	8.7	485	13.0	1163	31.2	1780	47.7
		20	1.4	47	1.3	149	4.0	321	8.6	474	12.7	1139	30.5	1737	46.6
		30	2.1	43	1.2	137	3.7	299	8.0	437	11.7	1055	28.3	1592	42.7
		45	3.1	34	0.9	106	2.8	236	6.3	337	9.0	822	22.0	1223	32.8
75	5.2	up to 22	up to 1.5	58	1.5	183	4.9	392	10.5	584	15.6	1398	37.5	2141	57.4
		30	2.1	56	1.5	176	4.7	380	10.2	560	15.0	1348	36.1	2050	54.9
		40	2.8	52	1.4	163	4.4	357	9.6	520	13.9	1256	33.7	1895	50.8
		60	4.1	37	1.0	118	3.2	263	7.1	375	10.1	915	24.5	1359	36.4
100	6.9	up to 32	up to 2.2	74	2.0	235	6.3	502	13.5	747	20.0	1790	48.0	2742	73.5
		40	2.8	72	1.9	228	6.1	491	13.2	725	19.4	1742	46.7	2654	71.1
		50	3.4	68	1.8	216	5.8	471	12.6	689	18.5	1661	44.5	2514	67.4
		85	5.9	43	1.2	135	3.6	303	8.1	431	11.6	1053	28.2	1560	41.8
125	8.6	up to 43	up to 3.0	90	2.4	285	7.6	611	16.4	909	24.4	2177	58.4	3333	89.3
		50	3.4	88	2.4	279	7.5	602	16.1	889	23.8	2136	57.2	3257	87.3
		75	5.2	78	2.1	247	6.6	542	14.5	787	21.1	1906	51.1	2867	76.8
		110	7.6	48	1.3	151	4.0	339	9.1	481	12.9	1175	31.5	1739	46.6
150	10.3	up to 52	up to 3.6	106	2.9	338	9.0	723	19.4	1075	28.8	2575	69.0	3944	106
		75	5.2	99	2.7	315	8.4	684	18.3	1003	26.9	2417	64.8	3662	98.1
		95	6.6	90	2.4	284	7.6	626	16.8	906	24.3	2196	58.9	3299	88.4
		130	9.0	60	1.6	188	5.0	422	11.3	599	16.1	1465	39.3	2168	58.1
200	13.8	up to 73	up to 5.0	139	3.7	440	11.8	941	25.2	1400	37.5	3354	89.9	5136	138
		100	6.9	131	3.5	413	11.1	897	24.0	1316	35.3	3171	85.0	4809	129
		125	8.6	119	3.2	377	10.1	828	22.2	1201	32.2	2908	77.9	4372	117
		185	12.8	60	1.6	190	5.1	429	11.5	606	16.2	1483	39.8	2189	58.7
300	20.7	up to 115	up to 7.9	203	5.4	644	17.3	1379	37.0	2050	55.0	4913	132	7520	202
		150	10.3	193	5.2	610	16.3	1322	35.4	1943	52.1	4678	125	7101	190
		200	13.8	169	4.5	534	14.3	1178	31.6	1703	45.6	4129	111	6195	166
		275	19.0	94	2.5	295	7.9	667	17.9	943	25.3	2309	61.9	3409	91.4
400	27.6	up to 155	up to 10.7	268	7.2	850	22.8	1819	48.8	2706	72.5	6482	174	9924	266
		200	13.8	255	6.8	806	21.6	1748	46.8	2569	68.9	6185	166	9392	252
		250	17.2	233	6.3	737	19.7	1617	43.3	2348	62.9	5684	152	8554	229
		300	20.7	201	5.4	634	17.0	1409	37.8	2021	54.2	4917	132	7338	197
		350	24.1	150	4.0	472	12.6	1061	28.4	1505	40.3	3679	98.6	5446	146
500	34.5	up to 196	up to 13.5	332	8.9	1055	28.3	2258	60.5	3358	90.0	8045	216	12,317	330
		225	15.5	325	8.7	1029	27.6	2218	59.4	3278	87.9	7874	211	12,002	322
		300	20.7	297	7.9	937	25.1	2051	55.0	2985	80.0	7218	193	10,884	292
		400	27.6	229	6.1	720	19.3	1608	43.1	2298	61.6	5601	150	8333	223
600	41.4	up to 237	up to 16.3	397	10.6	1260	33.8	2697	72.3	4011	108	9609	258	14,711	394
		300	20.7	379	10.2	1200	32.1	2599	69.6	3822	102	9199	247	13,973	375
		375	25.9	347	9.3	1097	29.4	2407	64.5	3496	93.7	8459	227	12,735	341
		450	31.0	300	8.0	944	25.3	2098	56.2	3011	80.7	7323	196	10,932	293
700	48.3	up to 278	up to 19.2	462	12.4	1465	39.3	3136	84.1	4664	125	11,173	299	17,105	458
		350	24.1	441	11.8	1396	37.4	3024	81.0	4448	119	10,705	287	16,263	436
		400	27.6	422	11.3	1333	35.7	2910	78.0	4250	114	10,260	275	15,507	416
		600	41.4	277	7.4	869	23.3	1950	52.3	2772	74.3	6771	182	10,036	269
800	55.2	up to 350	up to 24.1	518	13.9	1643	44.0	3534	94.7	5233	140	12,559	337	19,171	514
		450	31.0	484	13.0	1531	41.0	3338	89.5	4880	131	11,776	316	17,810	477
		609	42.0	391	10.5	1231	33.0	2739	73.4	3928	105	9558	256	14,258	382
900	62.1	up to 350	up to 24.1	593	15.9	1883	50.5	4026	108	5994	161	14,352	385	21,991	589
		500	34.5	547	14.7	1729	46.3	3765	101	5508	148	13,289	356	20,110	539
1000	69.0	609	42.0	493	13.2	1553	41.6	3427	91.8	4953	133	12,012	322	18,022	483
		up to 350	up to 24.1	666	17.9	2117	56.7	4507	121	6739	181	16,105	432	24,755	663
		500	34.5	627	16.8	1986	53.2	4300	115	6326	170	15,225	408	23,134	620
		609	42.0	583	15.6	1842	49.4	4034	108	5871	157	14,196	381	21,401	574

- continued -

North America Only

**Table 11. Capacities for Type FL-SRII/SRS with PRX Series Pilot and Type SA/2 Pilot Supply Filter Regulator with 1:1 Line Size to Body Size Ratio (continued)**

INLET PRESSURE		OUTLET PRESSURE		CAPACITIES IN THOUSANDS OF SCFH / Nm <sup>3</sup> /h OF 0.6 SPECIFIC GRAVITY NATURAL GAS											
psig	bar	psig	bar	NPS 1 / DN 25 Body		NPS 2 / DN 50 Body		NPS 3 / DN 80 Body		NPS 4 / DN 100 Body		NPS 6 / DN 150 Body		NPS 8 / DN 200 Body	
				SCFH	Nm <sup>3</sup> /h	SCFH	Nm <sup>3</sup> /h	SCFH	Nm <sup>3</sup> /h	SCFH	Nm <sup>3</sup> /h	SCFH	Nm <sup>3</sup> /h	SCFH	Nm <sup>3</sup> /h
1100	75.8	up to 350	up to 24.1	738	19.8	2348	62.9	4980	134	7473	200	17,833	478	27,481	737
		500	34.5	705	18.9	2234	59.9	4812	129	7115	191	17,087	458	26,053	698
		609	42.0	668	17.9	2111	56.6	4597	123	6728	180	16,229	435	24,564	658
1200	82.7	up to 350	up to 24.1	810	21.7	2577	69.1	5447	146	8201	220	19,542	524	30,182	809
		500	34.5	780	20.9	2476	66.4	5310	142	7884	211	18,899	507	28,902	775
		609	42.0	748	20.1	2369	63.5	5133	138	7547	202	18,167	487	27,593	740
1300	89.6	up to 350	up to 24.1	881	23.6	2804	75.2	5911	158	8922	239	21,238	569	32,863	881
		500	34.5	855	22.9	2713	72.7	5798	155	8638	232	20,677	554	31,701	850
		609	42.0	826	22.1	2619	70.2	5649	151	8341	224	20,042	537	30,530	818
1400	96.5	up to 350	up to 24.1	951	25.5	3030	81.2	6372	171	9640	258	22,924	614	35,530	952
		500	34.5	928	24.9	2948	79.0	6278	168	9383	252	22,429	601	34,463	924
		609	42.0	903	24.2	2862	76.7	6152	165	9116	244	21,871	586	33,402	895
1480	102	up to 350	up to 24.1	1007	27.0	3210	86.0	6739	181	10,212	274	24,267	650	37,655	1009
		500	34.5	986	26.4	3133	84.0	6658	178	9973	267	23,817	638	36,653	982
		609	42.0	963	25.8	3055	81.9	6547	176	9727	261	23,310	625	35,665	956

**Table 12. Capacities for Type FL-SRII/SRS with PRX-AP Series Pilot and Type SA/2 Pilot Supply Filter Regulator with 1:1 Line Size to Body Size Ratio**

INLET PRESSURE		OUTLET PRESSURE		CAPACITIES IN THOUSANDS OF SCFH / Nm <sup>3</sup> /h OF 0.6 SPECIFIC GRAVITY NATURAL GAS											
psig	bar	psig	bar	NPS 1 / DN 25 Body		NPS 2 / DN 50 Body		NPS 3 / DN 80 Body		NPS 4 / DN 100 Body		NPS 6 / DN 150 Body		NPS 8 / DN 200 Body	
				SCFH	Nm <sup>3</sup> /h	SCFH	Nm <sup>3</sup> /h	SCFH	Nm <sup>3</sup> /h	SCFH	Nm <sup>3</sup> /h	SCFH	Nm <sup>3</sup> /h	SCFH	Nm <sup>3</sup> /h
500	34.5	250	17.2	317	8.5	1,003	26.9	2173	58.2	3195	85.6	7692	206	11,682	313
		300	20.7	297	7.9	937	25.1	2051	55.0	2985	80.0	7218	193	10,884	292
		400	27.6	229	6.1	720	19.3	1608	43.1	2298	61.6	5601	150	8333	223
600	41.4	250	17.2	394	10.6	1249	33.5	2681	71.8	3977	106.6	9537	256	14,578	391
		350	24.1	359	9.6	1135	30.4	2481	66.5	3619	97.0	8742	234	13,199	354
		500	34.5	254	6.8	798	21.4	1787	47.9	2546	68.2	6213	167	9223	247
700	48.3	250	17.2	468	12.5	1486	39.8	3167	84.9	4729	127	11,308	303	17,367	465
		300	20.7	456	12.2	1446	38.8	3108	83.3	4606	123	11,049	296	16,875	452
		400	27.6	422	11.3	1333	35.7	2910	78.0	4250	114	10,260	275	15,507	416
800	55.2	550	37.9	328	8.8	1033	27.7	2303	61.7	3295	88.3	8026	215	11,952	320
		up to 300	up to 20.7	530	14.2	1684	45.1	3597	96.4	5362	144	12,832	344	19,681	528
		400	27.6	503	13.5	1593	42.7	3449	92.4	5074	136	12,212	327	18,554	497
900	62.1	500	34.5	461	12.4	1456	39.0	3196	85.6	4643	124	11,234	301	16,916	453
		650	44.8	355	9.5	1115	29.9	2492	66.8	3557	95.3	8673	232	12,894	346
		up to 350	up to 24.1	593	15.9	1883	50.5	4026	108	5994	161	14,352	385	21,991	589
1000	69.0	400	27.6	580	15.6	1840	49.3	3960	106	5861	157	14,069	377	21,466	575
		600	41.4	498	13.3	1571	42.1	3461	92.8	5008	134	12,139	325	18,225	488
		800	55.2	317	8.5	995	26.7	2241	60.1	3177	85.1	7770	208	11,494	308
1100	75.8	up to 400	up to 27.6	656	17.6	2080	55.8	4455	119	6624	178	15,869	425	24,297	651
		500	34.5	627	16.8	1986	53.2	4300	115	6326	170	15,225	408	23,134	620
		600	41.4	588	15.7	1856	49.7	4061	109	5915	159	14,296	383	21,566	578
1200	82.7	800	55.2	454	12.2	1429	38.3	3190	85.5	4559	122	11,110	298	16,531	443
		up to 450	up to 31.0	718	19.2	2278	61.1	4883	131	7254	194	17,385	466	26,600	713
		600	41.4	671	18.0	2123	56.9	4619	124	6765	181	16,312	437	24,705	662
1300	89.6	800	55.2	565	15.1	1779	47.7	3943	106	5673	152	13,784	369	20,610	552
		1000	69.0	353	9.5	1108	29.7	2499	67.0	3536	94.8	8655	232	12,788	343
		up to 500	up to 34.5	780	20.9	2476	66.4	5310	142	7884	211	18,899	507	28,902	775
1400	96.5	600	41.4	751	20.1	2379	63.8	5150	138	7579	203	18,238	489	27,715	743
		800	55.2	662	17.8	2089	56.0	4602	123	6660	179	16,143	433	24,239	650
		1100	75.8	370	9.9	1160	31.1	2619	70.2	3703	99.2	9066	243	13,388	359
1480	102	up to 500	up to 34.5	855	22.9	2713	72.7	5798	155	8638	232	20,677	554	31,701	850
		600	41.4	829	22.2	2627	70.4	5664	152	8369	224	20,103	539	30,638	821
		800	55.2	753	20.2	2376	63.7	5208	140	7574	203	18,319	491	27,606	740
1400	96.5	1160	80.0	450	12.1	1414	37.9	3184	85.3	4512	121	11,037	296	16,324	438
		up to 500	up to 34.5	928	24.9	2948	79.0	6278	168	9383	252	22,429	601	34,463	924
		600	41.4	905	24.3	2870	76.9	6164	165	9141	245	21,924	588	33,500	898
1480	102	800	55.2	838	22.5	2649	71.0	5778	155	8441	226	20,375	546	30,803	826
		1160	80.0	595	15.9	1870	50.1	4186	112	5967	160	14,557	390	21,620	579
		up to 500	up to 34.5	986	26.4	3133	84.0	6658	178	9973	267	23,817	638	36,653	982
1480	102	600	41.4	965	25.9	3062	82.1	6558	176	9750	261	23,358	626	35,756	958
		800	55.2	904	24.2	2859	76.6	6216	167	9110	244	21,960	589	33,274	892
		1160	80.0	692	18.6	2178	58.4	4854	130	6948	186	16,921	454	25,207	676

North America Only

# Bulletin 71.2:FL

**Table 13. Capacities for Type FL with PRX Series Pilot and Type SA/2 Pilot Supply Filter Regulator with 2:1 Line Size to Body Size Ratio**

INLET PRESSURE		OUTLET PRESSURE		CAPACITIES IN THOUSANDS OF SCFH / Nm <sup>3</sup> /h OF 0.6 SPECIFIC GRAVITY NATURAL GAS													
psig	bar	psig	bar	NPS 1 / DN 25 Body		NPS 2 / DN 50 Body		NPS 3 / DN 80 Body		NPS 4 / DN 100 Body		NPS 6 / DN 150 Body		NPS 8 / DN 200 Body		NPS 10 / DN 250 Body	
				SCFH	Nm <sup>3</sup> /h	SCFH	Nm <sup>3</sup> /h	SCFH	Nm <sup>3</sup> /h	SCFH	Nm <sup>3</sup> /h	SCFH	Nm <sup>3</sup> /h	SCFH	Nm <sup>3</sup> /h	SCFH	Nm <sup>3</sup> /h
30	2.1	up to 7.3	up to 0.50	30	0.8	122	3.3	276	7.4	438	11.7	1052	28.2	1745	46.8	2918	78.2
		15	1.0	27	0.7	110	3.0	255	6.8	398	10.7	1001	26.8	1639	43.9	2606	69.8
40	2.8	up to 8	up to 0.55	38	1.0	152	4.1	343	9.2	547	14.7	1285	34.4	2144	57.5	3591	96.2
		15	1.0	36	1.0	146	3.9	334	8.9	526	14.1	1283	34.4	2119	56.8	3449	92.4
		25	1.7	31	0.8	127	3.4	295	7.9	457	12.3	1170	31.3	1908	51.1	2993	80.2
50	3.4	up to 12	up to 0.83	45	1.2	180	4.8	406	10.9	648	17.4	1521	40.8	2539	68.0	4250	114
		15	1.0	44	1.2	178	4.8	404	10.8	642	17.2	1527	40.9	2539	68.0	4205	113
		25	1.7	41	1.1	166	4.5	383	10.3	599	16.1	1489	39.9	2448	65.6	3922	105
		35	2.4	35	0.9	141	3.8	331	8.9	511	13.7	1320	35.4	2147	57.5	3340	89.5
60	4.1	up to 16	up to 1.1	52	1.4	208	5.6	469	12.6	749	20.1	1757	47.1	2933	78.6	4908	132
		20	1.4	51	1.4	206	5.5	466	12.5	740	19.8	1765	47.3	2933	78.6	4847	130
		30	2.1	48	1.3	194	5.2	446	11.9	699	18.7	1731	46.4	2847	76.3	4573	123
		45	3.1	38	1.0	155	4.2	363	9.7	560	15.0	1457	39.0	2365	63.4	3656	98.0
75	5.2	up to 22	up to 1.5	62	1.7	251	6.7	564	15.1	901	24.1	2112	56.6	3525	94.5	5895	158
		30	2.1	60	1.6	245	6.6	556	14.9	881	23.6	2120	56.8	3513	94.2	5759	154
		40	2.8	57	1.5	231	6.2	532	14.3	834	22.4	2071	55.5	3404	91.2	5452	146
		60	4.1	42	1.1	173	4.6	407	10.9	626	16.8	1643	44.0	2661	71.3	4087	110
100	6.9	up to 32	up to 2.2	80	2.1	321	8.6	722	19.3	1154	30.9	2703	72.4	4512	121	7541	202
		40	2.8	78	2.1	315	8.4	715	19.2	1135	30.4	2715	72.8	4507	121	7416	199
		50	3.4	75	2.0	304	8.2	697	18.7	1096	29.4	2688	72.0	4433	119	7159	192
		85	5.9	49	1.3	200	5.4	472	12.7	724	19.4	1915	51.3	3096	83.0	4722	127
125	8.6	up to 43	up to 3.0	97	2.6	390	10.5	879	23.6	1404	37.6	3296	88.3	5501	147	9175	246
		50	3.4	95	2.6	386	10.3	874	23.4	1388	37.2	3309	88.7	5498	147	9068	243
		75	5.2	87	2.3	352	9.4	814	21.8	1271	34.1	3184	85.3	5221	140	8297	222
		110	7.6	55	1.5	224	6.0	530	14.2	810	21.7	2155	57.7	3479	93.2	5283	142
150	10.3	up to 52	up to 3.6	114	3.1	461	12.4	1038	27.8	1659	44.5	3884	104	6485	174	10,833	290
		75	5.2	109	2.9	441	11.8	1009	27.0	1590	42.6	3879	104	6406	172	10,377	278
		95	6.6	100	2.7	407	10.9	943	25.3	1470	39.4	3704	99.3	6065	163	9589	257
		130	9.0	68	1.8	279	7.5	658	17.6	1007	27.0	2671	71.6	4317	116	6569	176
200	13.8	up to 73	up to 5.0	149	4.0	601	16.1	1353	36.3	2162	57.9	5069	136	8461	227	14,113	378
		100	6.9	143	3.8	578	15.5	1320	35.4	2083	55.8	5068	136	8375	225	13,591	364
		125	8.6	132	3.5	538	14.4	1244	33.3	1942	52.0	4874	131	7989	214	12,664	339
		185	12.8	69	1.8	284	7.6	673	18.0	1027	27.5	2754	73.8	4437	119	6693	179
300	20.7	up to 115	up to 7.9	218	5.9	881	23.6	1984	53.2	3168	84.9	7438	199	12,411	333	20,672	554
		150	10.3	210	5.6	852	22.8	1943	52.1	3068	82.2	7443	200	12,311	330	20,013	536
		200	13.8	188	5.0	768	20.6	1779	47.7	2769	74.2	7008	188	11,462	307	18,052	484
		275	19.0	107	2.9	442	11.8	1046	28.0	1597	42.8	4274	115	6889	185	10,403	279
400	27.6	up to 155	up to 10.7	288	7.7	1162	31.1	2616	70.1	4178	112	9801	263	16,358	438	27,255	730
		200	13.8	278	7.4	1126	30.2	2566	68.8	4053	109	9818	263	16,245	435	26,431	708
		250	17.2	258	6.9	1051	28.2	2426	65.0	3789	102	9483	254	15,556	417	24,701	662
		300	20.7	226	6.0	923	24.7	2155	57.8	3331	89.3	8593	230	13,985	375	21,711	582
500	34.5	up to 196	up to 13.5	358	9.6	1442	38.6	3248	87.0	5187	139	12,167	326	20,306	544	33,827	907
		225	15.5	352	9.4	1423	38.1	3224	86.4	5120	137	12,216	327	20,296	544	33,386	895
		300	20.7	327	8.8	1330	35.6	3061	82.0	4794	129	11,914	319	19,579	525	31,248	837
		400	27.6	258	6.9	1057	28.3	2479	66.4	3818	102	9958	267	16,158	433	24,875	667
600	41.4	up to 237	up to 16.3	427	11.4	1722	46.2	3879	104	6195	166	14,533	390	24,255	650	40,398	1083
		300	20.7	413	11.1	1673	44.8	3810	102	6023	161	14,565	390	24,111	646	39,267	1052
		375	25.9	384	10.3	1563	41.9	3607	96.7	5636	151	14,090	378	23,120	620	36,733	984
		450	31.0	336	9.0	1374	36.8	3208	86.0	4960	133	12,785	343	20,810	558	32,318	866
700	48.3	up to 278	up to 19.2	497	13.3	2003	53.7	4510	121	7203	193	16,899	453	28,204	756	46,969	1259
		350	24.1	481	12.9	1946	52.2	4433	119	7008	188	16,939	454	28,044	752	45,683	1224
		400	27.6	464	12.4	1883	50.5	4320	116	6785	182	16,722	448	27,542	738	44,223	1185
		600	41.4	313	8.4	1286	34.5	3031	81.2	4647	125	12,272	329	19,850	532	30,270	811
800	55.2	up to 350	up to 24.1	560	15.0	2264	60.7	5120	137	8145	218	19,331	518	32,162	862	53,101	1423
		450	31.0	532	14.2	2158	57.8	4947	133	7776	208	19,114	512	31,504	844	50,682	1358
		609	42.0	439	11.8	1795	48.1	4195	112	6481	174	16,745	449	27,240	730	42,226	1132
900	62.1	up to 350	up to 24.1	637	17.1	2569	68.8	5777	155	9238	248	21,599	579	36,080	967	60,227	1614
		500	34.5	599	16.1	2433	65.2	5573	149	8766	235	21,501	576	35,459	950	57,131	1531
		609	42.0	548	14.7	2233	59.9	5177	139	8056	216	20,389	546	33,347	894	52,490	1407
1000	69.0	up to 350	up to 24.1	712	19.1	2866	76.8	6416	172	10,302	276	23,790	638	39,875	1069	67,172	1800
		500	34.5	683	18.3	2767	74.1	6300	169	9962	267	24,059	645	39,842	1068	64,933	1740
		609	42.0	643	17.2	2617	70.1	6026	162	9433	253	23,464	629	38,552	1033	61,470	1647

- continued -

North America Only

**Table 13. Capacities for Type FL with PRX Series Pilot and Type SA/2 Pilot Supply Filter Regulator with 2:1 Line Size to Body Size Ratio (continued)**

INLET PRESSURE		OUTLET PRESSURE		CAPACITIES IN THOUSANDS OF SCFH / Nm <sup>3</sup> /h OF 0.6 SPECIFIC GRAVITY NATURAL GAS													
psig	bar	psig	bar	NPS 1 / DN 25 Body		NPS 2 / DN 50 Body		NPS 3 / DN 80 Body		NPS 4 / DN 100 Body		NPS 6 / DN 150 Body		NPS 8 / DN 200 Body		NPS 10 / DN 250 Body	
				SCFH	Nm <sup>3</sup> /h	SCFH	Nm <sup>3</sup> /h	SCFH	Nm <sup>3</sup> /h	SCFH	Nm <sup>3</sup> /h	SCFH	Nm <sup>3</sup> /h	SCFH	Nm <sup>3</sup> /h	SCFH	Nm <sup>3</sup> /h
1100	75.8	up to 350	up to 24.1	786	21.1	3158	84.6	7043	189	11,348	304	25,931	695	43,589	1168	73,995	1983
		500	34.5	764	20.5	3086	82.7	6990	187	11,105	298	26,467	709	43,984	1179	72,386	1940
		609	42.0	732	19.6	2970	79.6	6800	182	10,700	287	26,224	703	43,256	1159	69,734	1869
1200	82.7	up to 350	up to 24.1	859	23.0	3447	92.4	7661	205	12,381	332	28,038	751	47,247	1266	80,733	2164
		500	34.5	841	22.6	3395	91.0	7658	205	12,212	327	28,775	771	47,966	1286	79,607	2133
		609	42.0	816	21.9	3304	88.6	7529	202	11,899	319	28,787	772	47,648	1277	77,549	2078
1300	89.6	up to 350	up to 24.1	932	25.0	3733	100	8273	222	13,404	359	30,119	807	50,864	1363	87,409	2343
		500	34.5	918	24.6	3697	99.1	8308	223	13,294	356	31,014	831	51,839	1389	86,666	2323
		609	42.0	897	24.0	3626	97.2	8226	221	13,050	350	31,220	837	51,831	1389	85,062	2280
1400	96.5	up to 350	up to 24.1	1004	26.9	4017	108	8880	238	14,421	387	32,182	863	54,451	1459	94,058	2521
		500	34.5	993	26.6	3994	107	8947	240	14,358	385	33,203	890	55,631	1491	93,605	2509
		609	42.0	975	26.1	3938	106	8901	239	14,170	380	33,561	890	55,868	1497	92,361	2475
1480	102	up to 350	up to 24.1	1061	28.4	4243	114	9363	251	15,230	408	33,822	907	57,303	1536	99,377	2663
		500	34.5	1052	28.2	4229	113	9451	253	15,199	407	34,928	936	58,621	1571	99,092	2656
		609	42.0	1037	27.8	4183	112	9429	253	15,047	403	35,385	948	59,018	1582	98,086	2629

**Table 14. Capacities for Type FL with PRX-AP Series Pilot and Type SA/2 Pilot Supply Filter Regulator with 2:1 Line Size to Body Size Ratio**

INLET PRESSURE		OUTLET PRESSURE		CAPACITIES IN THOUSANDS OF SCFH / Nm <sup>3</sup> /h OF 0.6 SPECIFIC GRAVITY NATURAL GAS													
psig	bar	psig	bar	NPS 1 / DN 25 Body		NPS 2 / DN 50 Body		NPS 3 / DN 80 Body		NPS 4 / DN 100 Body		NPS 6 / DN 150 Body		NPS 8 / DN 200 Body		NPS 10 / DN 250 Body	
				SCFH	Nm <sup>3</sup> /h	SCFH	Nm <sup>3</sup> /h	SCFH	Nm <sup>3</sup> /h	SCFH	Nm <sup>3</sup> /h	SCFH	Nm <sup>3</sup> /h	SCFH	Nm <sup>3</sup> /h	SCFH	Nm <sup>3</sup> /h
500	34.5	250	17.2	345	9.3	1399	37.5	3188	85.4	5038	135	12,192	327	20,178	541	32,849	880
		300	20.7	327	8.8	1330	35.6	3061	82.0	4794	129	11,914	319	19,579	525	31,248	837
		400	27.6	258	6.9	1057	28.3	2479	66.4	3818	102	9,958	267	16,158	433	24,875	667
600	41.4	250	17.2	425	11.4	1715	46.0	3871	104	6169	165	14,566	390	24,267	650	40,226	1078
		350	24.1	395	10.6	1607	43.1	3692	99.0	5791	155	14,323	384	23,569	632	37,748	1012
		500	34.5	287	7.7	1177	31.5	2768	74.2	4252	114	11,171	299	18,093	485	27,699	742
700	48.3	250	17.2	501	13.4	2016	54.0	4518	121	7246	194	16,791	450	28,118	754	47,252	1266
		300	20.7	493	13.2	1989	53.3	4496	121	7158	192	16,950	454	28,217	756	46,667	1251
		400	27.6	464	12.4	1883	50.5	4320	116	6785	182	16,722	448	27,542	738	44,223	1185
800	55.2	500	34.5	510	13.7	2075	55.6	4787	128	7483	201	18,697	501	30,683	822	48,764	1307
		650	44.8	400	10.7	1639	43.9	3847	103	5920	159	15,476	415	25,098	673	38,562	1033
		up to 300	up to 20.7	569	15.3	2292	61.4	5149	138	8243	221	19,198	515	32,104	860	53,748	1440
900	62.1	400	27.6	548	14.7	2220	59.5	5055	136	7993	214	19,312	518	31,977	857	52,100	1396
		600	41.4	553	14.8	2254	60.4	5220	140	8130	218	20,525	550	33,592	900	52,974	1420
		800	55.2	360	9.7	1481	39.7	3500	93.8	5353	144	14,233	382	22,981	616	34,862	934
1000	69.0	up to 400	up to 27.6	706	18.9	2844	76.2	6405	172	10,230	274	23,994	643	40,047	1073	66,695	1787
		500	34.5	683	18.3	2767	74.1	6300	169	9962	267	24,059	645	39,842	1068	64,933	1740
		600	41.4	647	17.4	2632	70.5	6056	162	9488	254	23,545	631	38,710	1037	61,830	1657
1100	75.8	800	55.2	512	13.7	2096	56.2	4915	132	7570	203	19,731	529	32,024	858	49,311	1322
		up to 450	up to 31.0	774	20.7	3120	83.6	7032	189	11,222	301	26,386	707	44,009	1180	73,155	1961
		600	41.4	735	19.7	2982	79.9	6822	183	10,742	288	26,268	704	43,356	1162	70,011	1876
1200	82.7	800	55.2	631	16.9	2578	69.1	6005	161	9305	249	23,839	639	38,865	1042	60,619	1625
		1000	69.0	402	10.8	1653	44.3	3914	105	5977	160	15,963	428	25,745	690	38,927	1043
		up to 500	up to 34.5	841	22.6	3395	91.0	7658	205	12,212	327	28,775	771	47,966	1286	79,607	2133
1300	89.6	600	41.4	818	21.9	3314	88.8	7544	202	11,932	320	28,806	772	47,706	1279	77,766	2084
		800	55.2	735	19.7	2997	80.3	6940	186	10,810	290	27,283	731	44,655	1197	70,432	1888
		1100	75.8	421	11.3	1733	46.5	4106	110	6266	168	16,762	449	27,024	724	40,810	1094
1400	96.5	up to 500	up to 34.5	918	24.6	3697	99.1	8308	223	13,294	356	31,014	831	51,839	1389	86,666	2323
		600	41.4	899	24.1	3633	97.4	8237	221	13,077	351	31,220	837	51,859	1390	85,234	2284
		800	55.2	831	22.3	3379	90.6	7785	209	12,181	327	30,340	813	49,832	1336	79,372	2127
1480	102	1160	80.0	512	13.7	2104	56.4	4974	133	7606	204	20,238	542	32,671	876	49,535	1328
		up to 500	up to 34.5	993	26.6	3994	107	8947	240	14,358	385	33,203	890	55,631	1491	93,605	2509
		600	41.4	977	26.2	3944	106	8908	239	14,190	380	33,546	899	55,871	1497	92,498	2479
1480	102	800	55.2	920	24.7	3737	100	8571	230	13,465	361	33,149	888	54,614	1464	87,747	2352
		1160	80.0	672	18.0	2755	73.8	6477	174	9954	267	26,109	700	42,306	1134	64,830	1737
		up to 500	up to 34.5	1052	28.2	4229	113	9451	253	15,199	407	34,928	936	58,621	1571	99,092	2656
1480	102	600	41.4	1039	27.8	4188	112	9434	253	15,064	404	35,360	948	59,006	1581	98,199	2632
		800	55.2	989	26.5	4011	108	9170	246	14,449	387	35,269	945	58,239	1561	94,160	2523
		1160	80.0	778	20.9	3186	85.4	7459	200	11,505	308	29,868	801	48,527	1301	74,940	2008

North America Only

# Bulletin 71.2:FL

**Table 15. Capacities for Type FL-SR with PRX Series Pilot and Type SA/2 Pilot Supply Filter Regulator with 2:1 Line Size to Body Size Ratio**

INLET PRESSURE		OUTLET PRESSURE		CAPACITIES IN THOUSANDS OF SCFH / Nm <sup>3</sup> /h OF 0.6 SPECIFIC GRAVITY NATURAL GAS									
psig	bar	psig	bar	NPS 1 / DN 25 Body		NPS 2 / DN 50 Body		NPS 3 / DN 80 Body		NPS 4 / DN 100 Body		NPS 6 / DN 150 Body	
				SCFH	Nm <sup>3</sup> /h	SCFH	Nm <sup>3</sup> /h	SCFH	Nm <sup>3</sup> /h	SCFH	Nm <sup>3</sup> /h	SCFH	Nm <sup>3</sup> /h
30	2.1	up to 7.3	up to 0.50	29	0.8	113	3.0	263	7.0	405	10.8	957	25.7
		15	1.0	26	0.7	101	2.7	240	6.4	367	9.8	888	23.8
40	2.8	up to 8	up to 0.55	36	1.0	143	3.8	327	8.8	506	13.6	1184	31.7
		15	1.0	34	0.9	136	3.6	316	8.5	486	13.0	1158	31.0
		25	1.7	29	0.8	116	3.1	277	7.4	422	11.3	1029	27.6
50	3.4	up to 12	up to 0.83	43	1.1	169	4.5	388	10.4	599	16.1	1402	37.6
		15	1.0	42	1.1	167	4.5	384	10.3	593	15.9	1397	37.4
		25	1.7	39	1.0	153	4.1	361	9.7	553	14.8	1330	35.7
		35	2.4	33	0.9	129	3.5	309	8.3	472	12.6	1155	30.9
60	4.1	up to 16	up to 1.1	49	1.3	195	5.2	448	12.0	692	18.6	1620	43.4
		20	1.4	49	1.3	192	5.1	444	11.9	684	18.3	1613	43.2
		30	2.1	45	1.2	179	4.8	421	11.3	646	17.3	1549	41.5
		45	3.1	36	1.0	141	3.8	339	9.1	517	13.8	1269	34.0
75	5.2	up to 22	up to 1.5	59	1.6	235	6.3	539	14.4	832	22.3	1948	52.2
		30	2.1	58	1.5	228	6.1	528	14.2	813	21.8	1926	51.6
		40	2.8	54	1.5	213	5.7	502	13.5	770	20.6	1851	49.6
		60	4.1	40	1.1	157	4.2	380	10.2	578	15.5	1425	38.2
100	6.9	up to 32	up to 2.2	76	2.0	301	8.1	689	18.5	1066	28.6	2493	66.8
		40	2.8	74	2.0	294	7.9	680	18.2	1048	28.1	2476	66.3
		50	3.4	71	1.9	282	7.5	659	17.7	1012	27.1	2418	64.8
		85	5.9	46	1.2	181	4.9	440	11.8	668	17.9	1654	44.3
125	8.6	up to 43	up to 3.0	93	2.5	366	9.8	840	22.5	1297	34.8	3037	81.4
		50	3.4	91	2.4	360	9.7	832	22.3	1282	34.4	3023	81.0
		75	5.2	82	2.2	324	8.7	766	20.5	1174	31.5	2832	75.9
		110	7.6	51	1.4	203	5.4	493	13.2	748	20.0	1856	49.7
150	10.3	up to 52	up to 3.6	110	2.9	433	11.6	991	26.6	1532	41.1	3584	96.0
		75	5.2	104	2.8	409	11.0	955	25.6	1468	39.3	3499	93.8
		95	6.6	95	2.5	374	10.0	887	23.8	1357	36.4	3283	88.0
		130	9.0	64	1.7	252	6.8	612	16.4	930	24.9	2305	61.8
200	13.8	up to 73	up to 5.0	143	3.8	564	15.1	1292	34.6	1997	53.5	4673	125
		100	6.9	136	3.6	537	14.4	1251	33.5	1924	51.6	4579	123
		125	8.6	126	3.4	495	13.3	1171	31.4	1793	48.1	4330	116
		185	12.8	65	1.7	256	6.9	625	16.8	948	25.4	2362	63.3
300	20.7	up to 115	up to 7.9	209	5.6	826	22.1	1894	50.8	2927	78.4	6853	184
		150	10.3	201	5.4	792	21.2	1842	49.4	2834	75.9	6736	181
		200	13.8	179	4.8	704	18.9	1672	44.8	2557	68.5	6199	166
		275	19.0	101	2.7	398	10.7	972	26.0	1474	39.5	3668	98.3
400	27.6	up to 155	up to 10.7	276	7.4	1090	29.2	2498	66.9	3860	104	9035	242
		200	13.8	265	7.1	1046	28.0	2433	65.2	3744	100	8893	238
		250	17.2	245	6.6	967	25.9	2285	61.2	3499	93.8	8439	226
		300	20.7	214	5.7	842	22.6	2017	54.1	3076	82.4	7523	202
		350	24.1	161	4.3	633	17.0	1538	41.2	2336	62.6	5790	155
500	34.5	up to 196	up to 13.5	342	9.2	1353	36.3	3101	83.1	4792	128	11,215	301
		225	15.5	336	9.0	1328	35.6	3068	82.2	4729	127	11,156	299
		300	20.7	311	8.3	1227	32.9	2888	77.4	4427	119	10,641	285
		400	27.6	244	6.5	961	25.8	2315	62.0	3525	94.5	8666	232
600	41.4	up to 237	up to 16.3	409	11.0	1616	43.3	3703	99.3	5723	153	13,396	359
		300	20.7	394	10.6	1555	41.7	3615	96.9	5563	149	13,204	354
		375	25.9	365	9.8	1439	38.6	3398	91.1	5205	140	12,546	336
		450	31.0	318	8.5	1254	33.6	3003	80.5	4579	123	11,197	300
700	48.3	up to 278	up to 19.2	475	12.7	1879	50.3	4306	115	6655	178	15,576	417
		350	24.1	459	12.3	1810	48.5	4206	113	6473	174	15,360	412
		400	27.6	441	11.8	1741	46.7	4083	109	6266	168	15,004	402
		600	41.4	296	7.9	1165	31.2	2823	75.7	4290	115	10,610	284
800	55.2	up to 350	up to 24.1	536	14.4	2116	56.7	4877	131	7524	202	17,705	475
		450	31.0	506	13.6	1997	53.5	4678	125	7182	193	17,175	460
		609	42.0	416	11.1	1637	43.9	3925	105	5984	160	14,648	393
900	62.1	up to 350	up to 24.1	610	16.4	2412	64.6	5520	148	8534	229	19,945	535
		500	34.5	571	15.3	2253	60.4	5271	141	8096	217	19,342	518
		609	42.0	520	13.9	2049	54.9	4865	130	7438	199	18,033	483

- continued -

North America Only

**Table 15. Capacities for Type FL-SR with PRX Series Pilot and Type SA/2 Pilot Supply Filter Regulator with 2:1 Line Size to Body Size Ratio (continued)**

INLET PRESSURE		OUTLET PRESSURE		CAPACITIES IN THOUSANDS OF SCFH / Nm <sup>3</sup> /h OF 0.6 SPECIFIC GRAVITY NATURAL GAS									
psig	bar	psig	bar	NPS 1 / DN 25 Body		NPS 2 / DN 50 Body		NPS 3 / DN 80 Body		NPS 4 / DN 100 Body		NPS 6 / DN 150 Body	
				SCFH	Nm <sup>3</sup> /h	SCFH	Nm <sup>3</sup> /h	SCFH	Nm <sup>3</sup> /h	SCFH	Nm <sup>3</sup> /h	SCFH	Nm <sup>3</sup> /h
1000	69.0	up to 350	up to 24.1	683	18.3	2700	72.4	6146	165	9518	255	22,119	593
		500	34.5	652	17.5	2574	69.0	5978	160	9201	247	21,827	585
		609	42.0	612	16.4	2413	64.7	5683	152	8711	234	20,949	561
1100	75.8	up to 350	up to 24.1	755	20.2	2984	80.0	6760	181	10,485	281	24,250	650
		500	34.5	730	19.6	2881	77.2	6652	178	10,258	275	24,185	648
		609	42.0	697	18.7	2751	73.7	6434	172	9882	265	23,601	633
1200	82.7	up to 350	up to 24.1	825	22.1	3265	87.5	7367	197	11,440	307	26,351	706
		500	34.5	805	21.6	3180	85.2	7304	196	11,281	302	26,459	709
		609	42.0	778	20.9	3072	82.3	7142	191	10,990	295	26,091	699
1300	89.6	up to 350	up to 24.1	895	24.0	3544	95.0	7968	214	12,386	332	28,430	762
		500	34.5	879	23.6	3473	93.1	7941	213	12,281	329	28,674	769
		609	42.0	857	23.0	3382	90.6	7822	210	12,055	323	28,470	763
1400	96.5	up to 350	up to 24.1	965	25.9	3821	102	8565	230	13,326	357	30,493	817
		500	34.5	951	25.5	3762	101	8567	230	13,265	356	30,847	827
		609	42.0	933	25.0	3684	98.7	8481	227	13,089	351	30,772	825
1480	102	up to 350	up to 24.1	1021	27.4	4041	108	9040	242	14,074	377	32,135	861
		500	34.5	1009	27.0	3990	107	9061	243	14,043	376	32,562	873
		609	42.0	992	26.6	3921	105	8998	241	13,900	373	32,572	873

**Table 16. Capacities for Type FL-SR with PRX-AP Series Pilot and Type SA/2 Pilot Supply Filter Regulator with 2:1 Line Size to Body Size Ratio**

INLET PRESSURE		OUTLET PRESSURE		CAPACITIES IN THOUSANDS OF SCFH / Nm <sup>3</sup> /h OF 0.6 SPECIFIC GRAVITY NATURAL GAS									
psig	bar	psig	bar	NPS 1 / DN 25 Body		NPS 2 / DN 50 Body		NPS 3 / DN 80 Body		NPS 4 / DN 100 Body		NPS 6 / DN 150 Body	
				SCFH	Nm <sup>3</sup> /h	SCFH	Nm <sup>3</sup> /h	SCFH	Nm <sup>3</sup> /h	SCFH	Nm <sup>3</sup> /h	SCFH	Nm <sup>3</sup> /h
500	34.5	250	17.2	330	8.8	1301	34.9	3024	81.1	4653	125	11,049	296
		300	20.7	311	8.3	1227	32.9	2888	77.4	4427	119	10,641	285
		400	27.6	244	6.5	961	25.8	2315	62.0	3525	94.5	8666	232
600	41.4	250	17.2	406	10.9	1606	43.0	3691	98.9	5699	153	13,378	359
		350	24.1	376	10.1	1484	39.8	3487	93.4	5348	143	12,827	344
		500	34.5	271	7.3	1068	28.6	2581	69.2	3925	105	9684	260
700	48.3	250	17.2	480	12.9	1897	50.8	4325	116	6695	179	15,582	418
		300	20.7	471	12.6	1861	49.9	4284	115	6612	177	15,543	417
		400	27.6	441	11.8	1741	46.7	4083	109	6266	168	15,004	402
800	55.2	550	37.9	350	9.4	1376	36.9	3309	88.7	5040	135	12,372	332
		up to 300	up to 20.7	545	14.6	2155	57.7	4923	132	7615	204	17,766	476
		400	27.6	523	14.0	2065	55.3	4797	129	7382	198	17,516	469
900	62.1	500	34.5	485	13.0	1911	51.2	4511	121	6910	185	16,652	446
		650	44.8	378	10.1	1489	39.9	3591	96.2	5465	147	13,452	361
		up to 350	up to 24.1	610	16.4	2412	64.6	5520	148	8534	229	19,945	535
1000	69.0	400	27.6	600	16.1	2371	63.6	5469	147	8436	226	19,866	532
		600	41.4	525	14.1	2069	55.5	4908	132	7507	201	18,178	487
		800	55.2	340	9.1	1338	35.9	3255	87.2	4941	132	12,260	329
1100	75.8	up to 400	up to 27.6	675	18.1	2668	71.5	6115	164	9451	253	22,119	593
		500	34.5	652	17.5	2574	69.0	5978	160	9201	247	21,827	585
		600	41.4	616	16.5	2429	65.1	5715	153	8762	235	21,048	564
1200	82.7	800	55.2	484	13.0	1906	51.1	4590	123	6988	187	17,178	460
		up to 450	up to 31.0	740	19.8	2924	78.4	6710	180	10,366	278	24,290	651
		600	41.4	701	18.8	2764	74.1	6457	173	9921	266	23,670	634
1300	89.6	800	55.2	598	16.0	2357	63.2	5629	151	8591	230	20,947	561
		1000	69.0	380	10.2	1492	40.0	3637	97.5	5517	148	13,718	368
		up to 500	up to 34.5	805	21.6	3180	85.2	7304	196	11,281	302	26,459	709
1400	96.5	600	41.4	781	20.9	3083	82.6	7160	192	11,020	295	26,138	701
		800	55.2	698	18.7	2752	73.8	6526	175	9982	268	24,168	648
		1100	75.8	398	10.7	1564	41.9	3814	102	5784	155	14,393	386
1480	102	up to 500	up to 34.5	879	23.6	3473	93.1	7941	213	12,281	329	28,674	769
		600	41.4	859	23.0	3391	90.9	7835	210	12,079	324	28,501	764
		800	55.2	790	21.2	3115	83.5	7340	197	11,249	302	27,068	725
1480	102	1160	80.0	484	13.0	1901	51.0	4625	124	7021	188	17,426	467
		up to 500	up to 34.5	951	25.5	3762	101	8567	230	13,265	356	30,847	827
		600	41.4	935	25.0	3692	98.9	8491	228	13,108	351	30,791	825
1480	102	800	55.2	876	23.5	3457	92.6	8102	217	12,436	333	29,762	798
		1160	80.0	636	17.0	2501	67.0	6041	162	9188	246	22,654	607
		up to 500	up to 34.5	1009	27.0	3990	107	9061	243	14,043	376	32,562	873
1480	102	600	41.4	994	26.6	3928	105	9006	241	13,916	373	32,582	873
		800	55.2	943	25.3	3720	99.7	8683	233	13,344	358	31,811	853
		1160	80.0	737	19.7	2901	77.7	6972	187	10,621	285	26,059	698

North America Only

# Bulletin 71.2:FL

**Table 17. Capacities for Type FL-SR/SRS with PRX Series Pilot and Type SA/2 Pilot Supply Filter Regulator with 2:1 Line Size to Body Size Ratio**

INLET PRESSURE		OUTLET PRESSURE		CAPACITIES IN THOUSANDS OF SCFH / Nm <sup>3</sup> /h OF 0.6 SPECIFIC GRAVITY NATURAL GAS									
psig	bar	psig	bar	NPS 1 / DN 25 Body		NPS 2 / DN 50 Body		NPS 3 / DN 80 Body		NPS 4 / DN 100 Body		NPS 6 / DN 150 Body	
				SCFH	Nm <sup>3</sup> /h	SCFH	Nm <sup>3</sup> /h	SCFH	Nm <sup>3</sup> /h	SCFH	Nm <sup>3</sup> /h	SCFH	Nm <sup>3</sup> /h
30	2.1	up to 7.3	up to 0.50	26	0.7	94	2.5	201	5.4	324	8.7	744	19.9
		15	1.0	23	0.6	82	2.2	178	4.8	288	7.7	676	18.1
40	2.8	up to 8	up to 0.55	33	0.9	119	3.2	254	6.8	410	11.0	930	24.9
		15	1.0	31	0.8	111	3.0	239	6.4	387	10.4	895	24.0
		25	1.7	26	0.7	93	2.5	203	5.4	329	8.8	778	20.9
50	3.4	up to 12	up to 0.83	39	1.1	141	3.8	301	8.1	485	13.0	1101	29.5
		15	1.0	39	1.0	138	3.7	295	7.9	477	12.8	1090	29.2
		25	1.7	35	0.9	125	3.3	270	7.2	437	11.7	1019	27.3
		35	2.4	29	0.8	103	2.8	225	6.0	365	9.8	870	23.3
60	4.1	up to 16	up to 1.1	45	1.2	164	4.4	348	9.3	561	15.0	1273	34.1
		20	1.4	44	1.2	160	4.3	341	9.1	550	14.7	1258	33.7
		30	2.1	41	1.1	146	3.9	315	8.4	510	13.7	1189	31.9
		45	3.1	32	0.9	112	3.0	245	6.6	399	10.7	953	25.5
75	5.2	up to 22	up to 1.5	55	1.5	197	5.3	418	11.2	675	18.1	1530	41.0
		30	2.1	52	1.4	188	5.0	403	10.8	651	17.5	1496	40.1
		40	2.8	49	1.3	174	4.7	375	10.1	608	16.3	1418	38.0
		60	4.1	35	0.9	125	3.3	273	7.3	444	11.9	1066	28.6
100	6.9	up to 32	up to 2.2	70	1.9	252	6.7	535	14.3	864	23.2	1959	52.5
		40	2.8	68	1.8	244	6.5	521	14.0	842	22.6	1928	51.7
		50	3.4	65	1.7	231	6.2	497	13.3	804	21.5	1863	49.9
		85	5.9	41	1.1	143	3.8	315	8.4	511	13.7	1233	33.0
125	8.6	up to 43	up to 3.0	85	2.3	306	8.2	651	17.4	1051	28.2	2385	63.9
		50	3.4	83	2.2	299	8.0	639	17.1	1032	27.7	2358	63.2
		75	5.2	74	2.0	263	7.1	569	15.3	923	24.7	2162	57.9
		110	7.6	45	1.2	159	4.3	351	9.4	571	15.3	1380	37.0
150	10.3	up to 52	up to 3.6	100	2.7	362	9.7	770	20.6	1243	33.3	2816	75.5
		75	5.2	94	2.5	336	9.0	722	19.4	1169	31.3	2702	72.4
		95	6.6	85	2.3	303	8.1	656	17.6	1064	28.5	2500	67.0
		130	9.0	57	1.5	199	5.3	437	11.7	711	19.1	1717	46.0
200	13.8	up to 73	up to 5.0	131	3.5	472	12.6	1003	26.9	1619	43.4	3671	98.4
		100	6.9	123	3.3	441	11.8	948	25.4	1533	41.1	3540	94.9
		125	8.6	113	3.0	401	10.8	869	23.3	1408	37.7	3303	88.5
		185	12.8	57	1.5	201	5.4	443	11.9	721	19.3	1750	46.9
300	20.7	up to 115	up to 7.9	192	5.1	691	18.5	1469	39.4	2371	63.5	5380	144
		150	10.3	182	4.9	652	17.5	1398	37.5	2262	60.6	5215	140
		200	13.8	160	4.3	568	15.2	1234	33.1	2000	53.6	4712	126
		275	19.0	89	2.4	313	8.4	690	18.5	1122	30.1	2721	72.9
400	27.6	up to 155	up to 10.7	253	6.8	911	24.4	1938	51.9	3128	83.8	7095	190
		200	13.8	241	6.5	862	23.1	1849	49.6	2990	80.1	6889	185
		250	17.2	221	5.9	785	21.0	1699	45.5	2752	73.8	6446	173
		300	20.7	190	5.1	673	18.0	1469	39.4	2385	63.9	5672	152
		350	24.1	142	3.8	499	13.4	1099	29.5	1787	47.9	4313	116
500	34.5	up to 196	up to 13.5	314	8.4	1131	30.3	2405	64.5	3883	104	8808	236
		225	15.5	307	8.2	1102	29.5	2354	63.1	3803	102	8698	233
		300	20.7	280	7.5	999	26.8	2157	57.8	3494	93.6	8153	219
		400	27.6	217	5.8	764	20.5	1673	44.8	2718	72.8	6502	174
600	41.4	up to 237	up to 16.3	375	10.0	1351	36.2	2873	77.0	4638	124	10,520	282
		300	20.7	358	9.6	1283	34.4	2750	73.7	4446	119	10,236	274
		375	25.9	328	8.8	1169	31.3	2528	67.8	4096	110	9587	257
		450	31.0	283	7.6	1003	26.9	2188	58.6	3551	95.2	8444	226
700	48.3	up to 278	up to 19.2	436	11.7	1571	42.1	3340	89.5	5393	145	12,232	328
		350	24.1	417	11.2	1493	40.0	3200	85.8	5174	139	11,910	319
		400	27.6	399	10.7	1423	38.1	3067	82.2	4964	133	11,537	309
		600	41.4	261	7.0	920	24.7	2022	54.2	3288	88.1	7917	212
800	55.2	up to 350	up to 24.1	490	13.1	1760	47.2	3755	101	6065	163	13,835	371
		450	31.0	458	12.3	1635	43.8	3520	94.3	5697	153	13,221	354
		609	42.0	370	9.9	1308	35.0	2856	76.5	4636	124	11,036	296
900	62.1	up to 350	up to 24.1	560	15.0	2020	54.1	4291	115	6926	186	15,685	420
		500	34.5	517	13.8	1846	49.5	3972	106	6428	172	14,903	399
		609	42.0	466	12.5	1653	44.3	3589	96.2	5819	156	13,708	367

North America Only

- continued -



**Table 17. Capacities for Type FL-SR/SRS with PRX Series Pilot and Type SA/2 Pilot Supply Filter Regulator with 2:1 Line Size to Body Size Ratio (continued)**

INLET PRESSURE		OUTLET PRESSURE		CAPACITIES IN THOUSANDS OF SCFH / Nm <sup>3</sup> /h OF 0.6 SPECIFIC GRAVITY NATURAL GAS									
psig	bar	psig	bar	NPS 1 / DN 25 Body		NPS 2 / DN 50 Body		NPS 3 / DN 80 Body		NPS 4 / DN 100 Body		NPS 6 / DN 150 Body	
				SCFH	Nm <sup>3</sup> /h	SCFH	Nm <sup>3</sup> /h	SCFH	Nm <sup>3</sup> /h	SCFH	Nm <sup>3</sup> /h	SCFH	Nm <sup>3</sup> /h
1000	69.0	up to 350	up to 24.1	629	16.9	2274	60.9	4816	129	7768	208	17,486	469
		500	34.5	593	15.9	2124	56.9	4551	122	7359	197	16,930	454
		609	42.0	551	14.8	1964	52.6	4242	114	6871	184	16,044	430
1100	75.8	up to 350	up to 24.1	697	18.7	2525	67.7	5333	143	8596	230	19,256	516
		500	34.5	666	17.8	2392	64.1	5108	137	8253	221	18,865	506
		609	42.0	631	16.9	2255	60.4	4851	130	7850	210	18,192	488
1200	82.7	up to 350	up to 24.1	764	20.5	2773	74.3	5844	157	9417	252	21,004	563
		500	34.5	737	19.8	2654	71.1	5650	151	9124	245	20,739	556
		609	42.0	707	18.9	2533	67.9	5430	146	8782	235	20,222	542
1300	89.6	up to 350	up to 24.1	831	22.3	3020	80.9	6352	170	10,230	274	22,736	609
		500	34.5	807	21.6	2912	78.0	6182	166	9977	267	22,571	605
		609	42.0	781	20.9	2803	75.1	5991	161	9682	260	22,173	594
1400	96.5	up to 350	up to 24.1	898	24.1	3265	87.5	6856	184	11,039	296	24,455	655
		500	34.5	876	23.5	3166	84.8	6707	180	10,818	290	24,371	653
		609	42.0	853	22.8	3067	82.2	6539	175	10,561	283	24,067	645
1480	102	up to 350	up to 24.1	951	25.5	3461	92.8	7258	195	11,683	313	25,824	692
		500	34.5	931	24.9	3367	90.2	7122	191	11,485	308	25,795	691
		609	42.0	909	24.4	3275	87.8	6969	187	11,252	302	25,553	685

**Table 18. Capacities for Type FL-SR/SRS with PRX-AP Series Pilot and Type SA/2 Pilot Supply Filter Regulator with 2:1 Line Size to Body Size Ratio**

INLET PRESSURE		OUTLET PRESSURE		CAPACITIES IN THOUSANDS OF SCFH / Nm <sup>3</sup> /h OF 0.6 SPECIFIC GRAVITY NATURAL GAS									
psig	bar	psig	bar	NPS 1 / DN 25 Body		NPS 2 / DN 50 Body		NPS 3 / DN 80 Body		NPS 4 / DN 100 Body		NPS 6 / DN 150 Body	
				SCFH	Nm <sup>3</sup> /h	SCFH	Nm <sup>3</sup> /h	SCFH	Nm <sup>3</sup> /h	SCFH	Nm <sup>3</sup> /h	SCFH	Nm <sup>3</sup> /h
500	34.5	250	17.2	299	8.0	1072	28.7	2299	61.6	3718	99.6	8563	230
		300	20.7	280	7.5	999	26.8	2157	57.8	3494	93.6	8153	219
		400	27.6	217	5.8	764	20.5	1673	44.8	2718	72.8	6502	174
600	41.4	250	17.2	372	10.0	1339	35.9	2851	76.4	4605	123	10,477	281
		350	24.1	340	9.1	1211	32.5	2613	70.0	4230	113	9848	264
		500	34.5	240	6.4	846	22.7	1856	49.7	3016	80.8	7243	194
700	48.3	250	17.2	442	11.8	1595	42.8	3381	90.6	5455	146	12,300	330
		300	20.7	431	11.5	1550	41.5	3303	88.5	5335	143	12,157	326
		400	27.6	399	10.7	1423	38.1	3067	82.2	4964	133	11,537	309
800	55.2	550	37.9	310	8.3	1096	29.4	2398	64.3	3894	104	9297	249
		up to 300	up to 20.7	501	13.4	1808	48.4	3837	103	6191	166	13,995	375
		400	27.6	475	12.7	1703	45.6	3650	97.8	5903	158	13,583	364
900	62.1	500	34.5	436	11.7	1552	41.6	3357	90.0	5439	146	12,729	341
		650	44.8	335	9.0	1182	31.7	2591	69.4	4209	113	10,082	270
		up to 350	up to 24.1	560	15.0	2020	54.1	4291	115	6926	186	15,685	420
1000	69.0	400	27.6	548	14.7	1971	52.8	4206	113	6795	182	15,513	416
		600	41.4	471	12.6	1672	44.8	3627	97.2	5880	158	13,833	371
		800	55.2	300	8.0	1054	28.2	2321	62.2	3774	101	9121	244
1100	75.8	up to 400	up to 27.6	619	16.6	2232	59.8	4745	127	7659	205	17,372	466
		500	34.5	593	15.9	2124	56.9	4551	122	7359	197	16,930	453
		600	41.4	555	14.9	1979	53.0	4273	115	6919	185	16,136	433
1200	82.7	800	55.2	430	11.5	1516	40.6	3319	88.9	5391	145	12,892	346
		up to 450	up to 31.0	678	18.2	2443	65.5	5198	139	8392	225	19,056	511
		600	41.4	634	17.0	2268	60.8	4875	131	7889	211	18,262	489
1300	89.6	800	55.2	534	14.3	1891	50.7	4118	110	6682	179	15,839	425
		1000	69.0	334	8.9	1172	31.4	2585	69.3	4205	113	10,186	273
		up to 500	up to 34.5	737	19.8	2654	71.1	5650	151	9124	245	20,739	556
1400	96.5	600	41.4	710	19.0	2544	68.2	5452	146	8815	236	20,277	543
		800	55.2	626	16.8	2224	59.6	4824	129	7820	210	18,393	493
		1100	75.8	350	9.4	1227	32.9	2708	72.6	4405	118	10,680	286
1480	102	up to 500	up to 34.5	807	21.6	2912	78.0	6182	166	9977	267	22,571	605
		600	41.4	783	21.0	2813	75.4	6010	161	9711	260	22,216	595
		800	55.2	711	19.1	2533	67.9	5474	147	8868	238	20,719	555
1480	102	1160	80.0	426	11.4	1496	40.1	3297	88.3	5361	144	12,961	347
		up to 500	up to 34.5	876	23.5	3166	84.8	6707	180	10,818	290	24,371	653
		600	41.4	855	22.9	3076	82.4	6555	176	10,586	284	24,101	646
1480	102	800	55.2	792	21.2	2827	75.8	6090	163	9857	264	22,896	614
		1160	80.0	562	15.1	1982	53.1	4349	117	7066	189	16,955	454
		up to 500	up to 34.5	931	24.9	3367	90.2	7122	191	11,485	308	25,795	691
1480	102	600	41.4	911	24.4	3284	88.0	6984	187	11,274	302	25,581	686
		800	55.2	854	22.9	3054	81.9	6564	176	10,620	285	24,562	658
		1160	80.0	654	17.5	2312	62.0	5055	136	8209	220	19,591	525

North America Only

# Bulletin 71.2:FL

**Table 19. Capacities for Type FL-SRII with PRX Series Pilot and Type SA/2 Pilot Supply Filter Regulator with 2:1 Line Size to Body Size Ratio**

INLET PRESSURE		OUTLET PRESSURE		CAPACITIES IN THOUSANDS OF SCFH / Nm <sup>3</sup> /h OF 0.6 SPECIFIC GRAVITY NATURAL GAS													
psig	bar	psig	bar	NPS 1 / DN 25 Body		NPS 2 / DN 50 Body		NPS 3 / DN 80 Body		NPS 4 / DN 100 Body		NPS 6 / DN 150 Body		NPS 8 / DN 200 Body		NPS 10 / DN 250 Body	
				SCFH	Nm <sup>3</sup> /h	SCFH	Nm <sup>3</sup> /h	SCFH	Nm <sup>3</sup> /h	SCFH	Nm <sup>3</sup> /h	SCFH	Nm <sup>3</sup> /h	SCFH	Nm <sup>3</sup> /h	SCFH	Nm <sup>3</sup> /h
30	2.1	up to 7.3	up to 0.50	26	0.7	103	2.8	239	6.4	358	9.6	866	23.2	1341	35.9	2179	58.4
		15	1.0	24	0.6	92	2.5	222	6.0	326	8.7	797	21.4	1217	32.6	1935	51.9
40	2.8	up to 8	up to 0.55	33	0.9	130	3.5	294	7.9	446	11.9	1076	28.8	1677	44.9	2749	73.7
		15	1.0	32	0.8	123	3.3	289	7.7	430	11.5	1045	28.0	1611	43.2	2598	69.6
		25	1.7	27	0.7	106	2.8	258	6.9	376	10.1	920	24.7	1400	37.5	2206	59.1
50	3.4	up to 12	up to 0.83	39	1.1	154	4.1	349	9.3	528	14.1	1275	34.2	1986	53.2	3254	87.2
		15	1.0	39	1.0	151	4.1	348	9.3	523	14.0	1266	33.9	1965	52.7	3200	85.8
		25	1.7	36	1.0	140	3.7	333	8.9	491	13.2	1197	32.1	1835	49.2	2929	78.5
		35	2.4	30	0.8	118	3.2	290	7.8	421	11.3	1031	27.6	1563	41.9	2450	65.7
60	4.1	up to 16	up to 1.1	46	1.2	177	4.8	403	10.8	610	16.3	1473	39.5	2295	61.5	3759	101
		20	1.4	45	1.2	175	4.7	402	10.8	604	16.2	1462	39.2	2267	60.8	3686	98.8
		30	2.1	42	1.1	163	4.4	387	10.4	573	15.4	1394	37.4	2140	57.4	3421	91.7
		45	3.1	33	0.9	129	3.4	319	8.6	461	12.4	1132	30.3	1712	45.9	2673	71.6
75	5.2	up to 22	up to 1.5	55	1.5	213	5.7	484	13.0	733	19.6	1771	47.5	2759	73.9	4516	121
		30	2.1	53	1.4	207	5.5	480	12.9	719	19.3	1743	46.7	2696	72.3	4361	117
		40	2.8	50	1.3	194	5.2	463	12.4	684	18.3	1665	44.6	2553	68.4	4072	109
		60	4.1	37	1.0	144	3.8	359	9.6	517	13.8	1269	34.0	1915	51.3	2977	79.8
100	6.9	up to 32	up to 2.2	70	1.9	273	7.3	620	16.6	939	25.2	2266	60.7	3533	94.7	5779	155
		40	2.8	69	1.8	267	7.2	617	16.5	926	24.8	2242	60.1	3474	93.1	5631	151
		50	3.4	66	1.8	256	6.9	604	16.2	897	24.0	2180	58.4	3355	89.9	5377	144
		85	5.9	42	1.1	166	4.4	417	11.2	598	16.0	1470	39.4	2214	59.3	3427	91.8
125	8.6	up to 43	up to 3.0	85	2.3	332	8.9	755	20.2	1143	30.6	2761	74.0	4300	115	7025	188
		50	3.4	84	2.3	327	8.8	753	20.2	1132	30.3	2740	73.4	4251	114	6898	185
		75	5.2	76	2.0	295	7.9	709	19.0	1043	28.0	2543	68.2	3891	104	6174	165
		110	7.6	47	1.3	185	5.0	468	12.5	670	18.0	1648	44.2	2479	66.4	3824	102
150	10.3	up to 52	up to 3.6	101	2.7	393	10.5	891	23.9	1350	36.2	3258	87.3	5079	136	8303	223
		75	5.2	96	2.6	372	10.0	874	23.4	1300	34.8	3158	84.6	4867	130	7814	209
		95	6.6	87	2.3	341	9.1	823	22.1	1207	32.3	2946	78.9	4499	121	7117	191
		130	9.0	59	1.6	230	6.2	581	15.6	833	22.3	2048	54.9	3083	82.6	4763	128
200	13.8	up to 73	up to 5.0	132	3.5	512	13.7	1162	31.1	1759	47.1	4248	114	6621	177	10,812	290
		100	6.9	125	3.4	488	13.1	1143	30.6	1703	45.6	4135	111	6377	171	10,246	275
		125	8.6	116	3.1	451	12.1	1085	29.1	1594	42.7	3888	104	5943	159	9,415	252
		185	12.8	60	1.6	234	6.3	596	16.0	850	22.8	2095	56.1	3142	84.2	4826	129
300	20.7	up to 115	up to 7.9	193	5.2	750	20.1	1704	45.7	2579	69.1	6229	167	9703	260	15,829	424
		150	10.3	185	5.0	720	19.3	1681	45.1	2508	67.2	6086	163	9395	252	15,108	405
		200	13.8	165	4.4	642	17.2	1554	41.7	2275	61.0	5557	149	8476	227	13,372	358
		275	19.0	93	2.5	364	9.8	925	24.8	1322	35.4	3255	87.2	4885	131	7509	201
400	27.6	up to 155	up to 10.7	254	6.8	990	26.5	2246	60.2	3401	91.1	8212	220	12,797	343	20,879	560
		200	13.8	244	6.5	951	25.5	2219	59.5	3312	88.8	8036	215	12,411	333	19,968	535
		250	17.2	226	6.1	881	23.6	2113	56.6	3109	83.3	7581	203	11,599	311	18,390	493
		300	20.7	197	5.3	768	20.6	1890	50.7	2744	73.6	6721	180	10,196	273	15,944	427
500	34.5	up to 196	up to 13.5	316	8.5	1228	32.9	2789	74.7	4221	113	10,194	273	15,884	426	25,912	694
		225	15.5	310	8.3	1207	32.3	2779	74.5	4176	112	10,110	271	15,678	420	25,388	680
		300	20.7	287	7.7	1117	29.9	2663	71.4	3930	105	9572	257	14,676	393	23,339	625
		400	27.6	225	6.0	877	23.5	2180	58.4	3150	84.4	7726	207	11,684	313	18,175	487
600	41.4	up to 237	up to 16.3	377	10.1	1467	39.3	3331	89.3	5042	135	12,176	326	18,972	509	30,946	829
		300	20.7	363	9.7	1414	37.9	3294	88.3	4921	132	11,937	320	18,442	494	29,685	796
		375	25.9	336	9.0	1311	35.1	3141	84.2	4624	124	11,272	302	17,254	462	27,363	733
		450	31.0	293	7.9	1144	30.6	2813	75.4	4086	110	10,005	268	15,181	407	23,741	636
700	48.3	up to 278	up to 19.2	439	11.8	1706	45.7	3873	103.8	5862	157	14,158	380	22,060	591	35,979	964
		350	24.1	423	11.3	1646	44.1	3832	103	5725	153	13,886	372	21,458	575	34,544	926
		400	27.6	407	10.9	1585	42.5	3751	101	5556	149	13,516	362	20,772	557	33,153	889
		600	41.4	272	7.3	1064	28.5	2673	71.6	3840	103	9437	253	14,220	381	21,988	589
800	55.2	up to 350	up to 24.1	494	13.2	1923	51.5	4408	118	6639	178	16,060	430	24,942	669	40,474	1085
		450	31.0	467	12.5	1818	48.7	4293	115	6366	171	15,480	415	23,807	638	38,040	1019
		609	42.0	383	10.3	1493	40.0	3681	98.7	5340	143	13,082	351	19,837	532	30,987	830
900	62.1	up to 350	up to 24.1	563	15.1	2189	58.7	4957	133	7515	201	18,140	486	28,290	758	46,201	1238
		500	34.5	526	14.1	2050	54.9	4833	130	7174	192	17,440	467	26,838	719	42,921	1150
		609	42.0	479	12.8	1867	50.0	4522	121	6620	177	16,167	433	24,659	661	38,883	1042
1000	69.0	up to 350	up to 24.1	630	16.9	2450	65.7	5490	147	8368	224	20,163	540	31,553	846	51,801	1388
		500	34.5	601	16.1	2340	62.7	5445	146	8137	218	19,736	529	30,503	818	49,118	1316
		609	42.0	564	15.1	2197	58.9	5243	141	7734	207	18,840	505	28,878	774	45,894	1230

North America Only

- continued -

**Table 19. Capacities for Type FL-SRII with PRX Series Pilot and Type SA/2 Pilot Supply Filter Regulator with 2:1 Line Size to Body Size Ratio (continued)**

INLET PRESSURE		OUTLET PRESSURE		CAPACITIES IN THOUSANDS OF SCFH / Nm <sup>3</sup> /h OF 0.6 SPECIFIC GRAVITY NATURAL GAS													
psig	bar	psig	bar	NPS 1 / DN 25 Body		NPS 2 / DN 50 Body		NPS 3 / DN 80 Body		NPS 4 / DN 100 Body		NPS 6 / DN 150 Body		NPS 8 / DN 200 Body		NPS 10 / DN 250 Body	
				SCFH	Nm <sup>3</sup> /h	SCFH	Nm <sup>3</sup> /h	SCFH	Nm <sup>3</sup> /h	SCFH	Nm <sup>3</sup> /h	SCFH	Nm <sup>3</sup> /h	SCFH	Nm <sup>3</sup> /h	SCFH	Nm <sup>3</sup> /h
1100	75.8	up to 350	up to 24.1	697	18.7	2706	72.5	6012	161	9205	247	22,148	594	34,759	932	57,316	1536
		500	34.5	673	18.0	2618	70.2	6024	161	9056	243	21,920	588	34,005	911	55,073	1476
		609	42.0	643	17.2	2503	67.1	5897	158	8757	235	21,283	570	32,760	878	52,410	1405
1200	82.7	up to 350	up to 24.1	762	20.4	2960	79.3	6527	175	10,032	269	24,106	646	37,924	1016	62,772	1682
		500	34.5	743	19.9	2888	77.4	6582	176	9944	267	24,031	644	37,398	1002	60,866	1631
		609	42.0	718	19.2	2794	74.9	6509	174	9721	261	23,583	632	36,432	976	58,616	1571
1300	89.6	up to 350	up to 24.1	827	22.2	3211	86.1	7036	189	10,851	291	26,045	698	41,061	1101	68,183	1827
		500	34.5	811	21.7	3153	84.5	7125	191	10,812	290	26,090	699	40,714	1091	66,546	1783
		609	42.0	790	21.2	3074	82.4	7094	190	10,647	285	25,787	691	39,962	1071	64,612	1732
1400	96.5	up to 350	up to 24.1	892	23.9	3461	92.8	7540	202	11,664	313	27,969	750	44,177	1184	73,562	1971
		500	34.5	878	23.5	3413	91.5	7658	205	11,664	313	28,112	753	43,974	1179	72,143	1933
		609	42.0	860	23.1	3347	89.7	7660	205	11,546	309	27,923	748	43,391	1163	70,460	1888
1480	102	up to 350	up to 24.1	943	25.3	3660	98.1	7942	213	12,311	330	29,500	791	46,657	1250	77,847	2086
		500	34.5	932	25.0	3619	97.0	8078	217	12,338	331	29,709	796	46,552	1248	76,575	2052
		609	42.0	916	24.5	3561	95.4	8101	217	12,250	328	29,595	793	46,081	1235	75,058	2012

**Table 20. Capacities for Type FL-SRII with PRX-AP Series Pilot and Type SA/2 Pilot Supply Filter Regulator with 2:1 Line Size to Body Size Ratio**

INLET PRESSURE		OUTLET PRESSURE		CAPACITIES IN THOUSANDS OF SCFH / Nm <sup>3</sup> /h OF 0.6 SPECIFIC GRAVITY NATURAL GAS													
psig	bar	psig	bar	NPS 1 / DN 25 Body		NPS 2 / DN 50 Body		NPS 3 / DN 80 Body		NPS 4 / DN 100 Body		NPS 6 / DN 150 Body		NPS 8 / DN 200 Body		NPS 10 / DN 250 Body	
				SCFH	Nm <sup>3</sup> /h	SCFH	Nm <sup>3</sup> /h	SCFH	Nm <sup>3</sup> /h	SCFH	Nm <sup>3</sup> /h	SCFH	Nm <sup>3</sup> /h	SCFH	Nm <sup>3</sup> /h	SCFH	Nm <sup>3</sup> /h
500	34.5	250	17.2	304	8.1	1183	31.7	2757	73.9	4116	110	9987	268	15,427	413	24,827	665
		300	20.7	287	7.7	1117	29.9	2663	71.4	3930	105	9572	257	14,676	393	23,339	625
		400	27.6	225	6.0	877	23.5	2180	58.4	3150	84.4	7726	207	11,684	313	18,175	487
600	41.4	250	17.2	375	10.0	1458	39.1	3329	89.2	5025	135	12,147	326	18,892	506	30,728	824
		350	24.1	347	9.3	1351	36.2	3208	86.0	4745	127	11,548	310	17,730	475	28,254	757
		500	34.5	250	6.7	975	26.1	2438	65.3	3511	94.1	8622	231	13,011	349	20,169	541
700	48.3	250	17.2	443	11.9	1722	46.1	3869	104	5888	158	14,195	380	22,193	594	36,386	975
		300	20.7	435	11.6	1691	45.3	3869	104	5832	156	14,104	378	21,919	587	35,603	954
		400	27.6	407	10.9	1585	42.5	3751	101	5556	149	13,516	362	20,772	557	33,153	889
800	55.2	250	17.2	443	11.9	1722	46.1	3869	104	5888	158	14,195	380	22,193	594	36,386	975
		300	20.7	435	11.6	1691	45.3	3869	104	5832	156	14,104	378	21,919	587	35,603	954
		400	27.6	407	10.9	1585	42.5	3751	101	5556	149	13,516	362	20,772	557	33,153	889
900	62.1	up to 300	up to 20.7	503	13.5	1956	52.4	4414	118	6702	180	16,170	433	25,245	677	41,299	1107
		400	27.6	482	12.9	1877	50.3	4369	117	6529	175	15,836	424	24,473	656	39,402	1056
		500	34.5	447	12.0	1741	46.7	4169	112	6139	165	14,964	401	22,907	614	36,334	974
1000	69.0	up to 350	up to 24.1	563	15.1	2189	58.7	4957	133	7515	201	18,140	486	28,290	758	46,201	1238
		400	27.6	554	14.8	2155	57.7	4947	133	7445	200	18,014	483	27,964	750	45,342	1215
		600	41.4	484	13.0	1886	50.5	4557	122	6679	179	16,304	437	24,886	667	39,286	1053
1100	75.8	up to 400	up to 27.6	623	16.7	2423	64.9	5500	147	8326	223	20,106	539	31,330	840	51,095	1369
		500	34.5	601	16.1	2340	62.7	5445	146	8137	218	19,736	529	30,503	818	49,118	1316
		600	41.4	568	15.2	2212	59.3	5266	141	7777	208	18,937	508	29,046	779	46,211	1238
1200	82.7	up to 450	up to 31.0	683	18.3	2656	71.2	6041	162	9135	245	22,070	592	34,365	921	55,983	1500
		600	41.4	646	17.3	2515	67.4	5913	159	8789	236	21,354	572	32,890	882	52,669	1412
		800	55.2	551	14.8	2149	57.6	5259	141	7658	205	18,737	502	28,480	763	44,656	1197
1300	89.6	up to 500	up to 34.5	743	19.9	2888	77.4	6582	176	9944	267	24,031	644	37,398	1002	60,866	1631
		600	41.4	720	19.3	2803	75.1	6520	175	9746	261	23,635	633	36,534	979	58,834	1577
		800	55.2	643	17.2	2508	67.2	6058	162	8880	238	21,677	581	33,090	887	52,241	1400
1400	96.5	up to 500	up to 34.5	811	21.7	3153	84.5	7125	191	10,812	290	26,090	699	40,714	1091	66,546	1783
		600	41.4	792	21.2	3082	82.6	7100	190	10,666	286	25,825	692	40,442	1073	64,799	1737
		800	55.2	728	19.5	2837	76.0	6775	182	9989	268	24,337	652	37,290	999	59,224	1587
1480	102	up to 500	up to 34.5	878	23.5	3413	91.5	7658	205	11,664	313	28,112	753	43,974	1179	72,143	1933
		600	41.4	862	23.1	3353	89.9	7662	205	11,560	310	27,949	749	43,455	1165	70,623	1893
		800	55.2	808	21.6	3146	84.3	7440	199	11,026	296	26,816	719	41,225	1105	65,817	1764
1480	102	up to 500	up to 34.5	932	25.0	3619	97.0	8078	217	12,338	331	29,709	796	46,552	1248	76,575	2052
		600	41.4	917	24.6	3567	95.6	8102	217	12,261	329	29,614	794	46,134	1236	75,205	2015
		800	55.2	869	23.3	3384	90.7	7945	213	11,818	317	28,708	769	44,238	1186	70,892	1900
1480	102	up to 500	up to 34.5	916	24.5	3561	95.4	8101	217	12,250	328	29,595	793	46,081	1235	75,058	2012
		600	41.4	917	24.6	3567	95.6	8102	217	12,261	329	29,614	794	46,134	1236	75,205	2015
		800	55.2	869	23.3	3384	90.7	7945	213	11,818	317	28,708	769	44,238	1186	70,892	1900

North America Only

# Bulletin 71.2:FL

**Table 21. Capacities for Type FL-SRII/SRS with PRX Series Pilot and Type SA/2 Pilot Supply Filter Regulator with 2:1 Line Size to Body Size Ratio**

INLET PRESSURE		OUTLET PRESSURE		CAPACITIES IN THOUSANDS OF SCFH / Nm <sup>3</sup> /h OF 0.6 SPECIFIC GRAVITY NATURAL GAS											
psig	bar	psig	bar	NPS 1 / DN 25 Body		NPS 2 / DN 50 Body		NPS 3 / DN 80 Body		NPS 4 / DN 100 Body		NPS 6 / DN 150 Body		NPS 8 / DN 200 Body	
				SCFH	Nm <sup>3</sup> /h	SCFH	Nm <sup>3</sup> /h	SCFH	Nm <sup>3</sup> /h	SCFH	Nm <sup>3</sup> /h	SCFH	Nm <sup>3</sup> /h	SCFH	Nm <sup>3</sup> /h
30	2.1	up to 7.3	up to 0.50	28	0.8	86	2.3	186	5.0	287	7.7	677	18.2	976	26.2
		15	1.0	25	0.7	75	2.0	167	4.5	256	6.9	619	16.6	853	22.9
40	2.8	up to 8	up to 0.55	36	1.0	109	2.9	233	6.2	361	9.7	843	22.6	1241	33.3
		15	1.0	34	0.9	102	2.7	222	6.0	343	9.2	816	21.9	1159	31.1
		25	1.7	29	0.8	85	2.3	191	5.1	294	7.9	714	19.1	969	26.0
50	3.4	up to 12	up to 0.83	42	1.1	130	3.5	276	7.4	428	11.5	999	26.8	1471	39.4
		15	1.0	42	1.1	127	3.4	272	7.3	421	11.3	991	26.6	1440	38.6
		25	1.7	38	1.0	114	3.1	252	6.8	388	10.4	932	25.0	1300	34.8
		35	2.4	32	0.9	94	2.5	213	5.7	327	8.8	799	21.4	1073	28.8
60	4.1	up to 16	up to 1.1	49	1.3	150	4.0	319	8.6	494	13.2	1154	30.9	1701	45.6
		20	1.4	48	1.3	146	3.9	314	8.4	486	13.0	1143	30.6	1659	44.5
		30	2.1	45	1.2	134	3.6	294	7.9	453	12.2	1086	29.1	1521	40.8
		45	3.1	35	1.0	103	2.7	233	6.2	357	9.6	877	23.5	1168	31.3
75	5.2	up to 22	up to 1.5	59	1.6	180	4.8	384	10.3	594	15.9	1388	37.2	2045	54.8
		30	2.1	57	1.5	172	4.6	373	10.0	576	15.4	1362	36.5	1958	52.5
		40	2.8	53	1.4	159	4.3	351	9.4	540	14.5	1297	34.7	1810	48.5
		60	4.1	40	1.1	114	3.1	260	7.0	399	10.7	982	26.3	1298	34.8
100	6.9	up to 32	up to 2.2	75	2.0	231	6.2	491	13.2	761	20.4	1776	47.6	2619	70.2
		40	2.8	73	2.0	223	6.0	481	12.9	744	19.9	1753	47.0	2535	67.9
		50	3.4	70	1.9	211	5.7	462	12.4	713	19.1	1700	45.6	2401	64.4
		85	5.9	46	1.2	131	3.5	300	8.0	460	12.3	1137	30.5	1490	39.9
125	8.6	up to 43	up to 3.0	91	2.4	280	7.5	598	16.0	926	24.8	2163	58.0	3184	85.3
		50	3.4	90	2.4	274	7.3	589	15.8	911	24.4	2144	57.5	3111	83.4
		75	5.2	81	2.2	241	6.5	533	14.3	821	22.0	1979	53.0	2739	73.4
		110	7.6	51	1.4	146	3.9	335	9.0	513	13.8	1274	34.1	1661	44.5
150	10.3	up to 52	up to 3.6	108	2.9	332	8.9	706	18.9	1094	29.3	2554	68.4	3767	101
		75	5.2	102	2.7	308	8.2	671	18.0	1036	27.8	2464	66.0	3498	93.7
		95	6.6	94	2.5	277	7.4	616	16.5	948	25.4	2290	61.4	3151	84.5
		130	9.0	64	1.7	182	4.9	418	11.2	639	17.1	1583	42.4	2071	55.5
200	13.8	up to 73	up to 5.0	141	3.8	432	11.6	920	24.7	1426	38.2	3330	89.2	4906	132
		100	6.9	134	3.6	404	10.8	880	23.6	1358	36.4	3227	86.5	4593	123
		125	8.6	124	3.3	367	9.8	815	21.8	1254	33.6	3024	81.0	4176	112
		185	12.8	65	1.7	183	4.9	425	11.4	649	17.4	1617	43.3	2091	56.0
300	20.7	up to 115	up to 7.9	206	5.5	633	17.0	1348	36.1	2089	56.0	4881	131	7183	193
		150	10.3	198	5.3	597	16.0	1297	34.8	2003	53.7	4752	127	6783	182
		200	13.8	177	4.7	520	13.9	1160	31.1	1784	47.8	4318	116	5917	159
		275	19.0	100	2.7	286	7.7	660	17.7	1010	27.1	2513	67.4	3257	87.3
400	27.6	up to 155	up to 10.7	272	7.3	835	22.4	1779	47.7	2755	73.8	6436	173	9479	254
		200	13.8	261	7.0	789	21.2	1714	45.9	2647	70.9	6276	168	8971	240
		250	17.2	242	6.5	718	19.3	1591	42.6	2449	65.6	5898	158	8171	219
		300	20.7	212	5.7	616	16.5	1389	37.2	2133	57.2	5212	140	7010	188
		350	24.1	160	4.3	456	12.2	1049	28.1	1606	43.0	3978	107	5203	139
500	34.5	up to 196	up to 13.5	337	9.0	1037	27.8	2208	59.2	3420	91.7	7989	214	11,766	315
		225	15.5	331	8.9	1009	27.1	2172	58.2	3359	90.0	7908	212	11,465	307
		300	20.7	307	8.2	914	24.5	2016	54.0	3105	83.2	7453	200	10,396	279
		400	27.6	242	6.5	699	18.7	1588	42.6	2436	65.3	5983	160	7959	213
600	41.4	up to 237	up to 16.3	403	10.8	1238	33.2	2637	70.7	4085	110	9542	256	14,053	378
		300	20.7	389	10.4	1175	31.5	2547	68.3	3935	106	9323	250	13,347	358
		375	25.9	361	9.7	1069	28.7	2367	63.4	3644	97.7	8771	235	12,165	326
		450	31.0	315	8.4	917	24.6	2069	55.4	3176	85.1	7758	208	10,442	280
700	48.3	up to 278	up to 19.2	468	12.5	1439	38.6	3066	82.2	4749	127	11,095	297	16,339	438
		350	24.1	452	12.1	1367	36.6	2964	79.4	4579	123	10,846	291	15,535	416
		400	27.6	436	11.7	1303	34.9	2858	76.6	4407	118	10,534	282	14,812	397
		600	41.4	293	7.9	841	22.5	1928	51.7	2953	79.1	7298	196	9587	257
800	55.2	up to 350	up to 24.1	528	14.1	1613	43.2	3459	92.7	5352	143	12,569	337	18,313	491
		450	31.0	500	13.4	1496	40.1	3277	87.8	5055	136	12,068	323	17,012	456
		609	42.0	411	11.0	1196	32.1	2702	72.4	4148	111	10,142	272	13,619	365
900	62.1	up to 350	up to 24.1	601	16.1	1851	49.6	3935	105	6097	163	14,221	381	21,006	563
		500	34.5	564	15.1	1690	45.3	3696	99.1	5702	153	13,599	365	19,209	515
		609	42.0	514	13.8	1513	40.5	3374	90.4	5189	139	12,562	337	17,215	461

- continued -

North America Only

**Table 21. Capacities for Type FL-SRII/SRS with PRX Series Pilot and Type SA/2 Pilot Supply Filter Regulator with 2:1 Line Size to Body Size Ratio (continued)**

INLET PRESSURE		OUTLET PRESSURE		CAPACITIES IN THOUSANDS OF SCFH / Nm <sup>3</sup> /h OF 0.6 SPECIFIC GRAVITY NATURAL GAS											
psig	bar	psig	bar	NPS 1 / DN 25 Body		NPS 2 / DN 50 Body		NPS 3 / DN 80 Body		NPS 4 / DN 100 Body		NPS 6 / DN 150 Body		NPS 8 / DN 200 Body	
				SCFH	Nm <sup>3</sup> /h	SCFH	Nm <sup>3</sup> /h	SCFH	Nm <sup>3</sup> /h	SCFH	Nm <sup>3</sup> /h	SCFH	Nm <sup>3</sup> /h	SCFH	Nm <sup>3</sup> /h
1000	69.0	up to 350	up to 24.1	672	18.0	2084	55.9	4399	118	6824	183	15,828	424	23,646	634
		500	34.5	643	17.2	1945	52.1	4214	113	6511	175	15,416	413	22,098	592
		609	42.0	604	16.2	1797	48.2	3965	106	6109	164	14,668	393	20,443	548
1100	75.8	up to 350	up to 24.1	742	19.9	2314	62.0	4857	130	7540	202	17,406	467	26,251	704
		500	34.5	719	19.3	2191	58.7	4711	126	7287	195	17,148	460	24,887	667
		609	42.0	688	18.4	2064	55.3	4512	121	6962	187	16,598	445	23,464	629
1200	82.7	up to 350	up to 24.1	811	21.7	2543	68.1	5308	142	8249	221	18,963	508	28,830	773
		500	34.5	793	21.2	2432	65.2	5193	139	8041	216	18,823	505	27,608	740
		609	42.0	768	20.6	2320	62.2	5032	135	7772	208	18,418	494	26,357	706
1300	89.6	up to 350	up to 24.1	880	23.6	2769	74.2	5756	154	8951	240	20,506	550	31,392	841
		500	34.5	865	23.2	2668	71.5	5665	152	8780	235	20,458	548	30,281	812
		609	42.0	844	22.6	2567	68.8	5532	148	8554	229	20,164	540	29,163	782
1400	96.5	up to 350	up to 24.1	948	25.4	2994	80.2	6201	166	9648	259	22,037	591	33,939	910
		500	34.5	936	25.1	2901	77.8	6130	164	9507	255	22,064	591	32,920	882
		609	42.0	919	24.6	2810	75.3	6019	161	9315	250	21,858	586	31,907	855
1480	102	up to 350	up to 24.1	1002	26.9	3174	85.1	6556	176	10,204	274	23,256	623	35,969	964
		500	34.5	992	26.6	3086	82.7	6497	174	10,083	270	23,334	625	35,012	938
		609	42.0	977	26.2	3001	80.4	6401	172	9914	266	23,185	621	34,068	913

**Table 22. Capacities for Type FL-SRII/SRS with PRX-AP Series Pilot and Type SA/2 Pilot Supply Filter Regulator with 2:1 Line Size to Body Size Ratio**

INLET PRESSURE		OUTLET PRESSURE		CAPACITIES IN THOUSANDS OF SCFH / Nm <sup>3</sup> /h OF 0.6 SPECIFIC GRAVITY NATURAL GAS											
psig	bar	psig	bar	NPS 1 / DN 25 Body		NPS 2 / DN 50 Body		NPS 3 / DN 80 Body		NPS 4 / DN 100 Body		NPS 6 / DN 150 Body		NPS 8 / DN 200 Body	
				SCFH	Nm <sup>3</sup> /h	SCFH	Nm <sup>3</sup> /h	SCFH	Nm <sup>3</sup> /h	SCFH	Nm <sup>3</sup> /h	SCFH	Nm <sup>3</sup> /h	SCFH	Nm <sup>3</sup> /h
500	34.5	250	17.2	325	8.7	982	26.3	2131	57.1	3291	88.2	7799	209	11,159	299
		300	20.7	307	8.2	914	24.5	2016	54.0	3105	83.2	7453	200	10,396	279
		400	27.6	242	6.5	699	18.7	1588	42.6	2436	65.3	5983	160	7959	213
600	41.4	250	17.2	400	10.7	1226	32.9	2622	70.3	4060	109	9512	255	13,925	373
		350	24.1	372	10.0	1109	29.7	2437	65.3	3757	101	8997	241	12,608	338
		500	34.5	269	7.2	773	20.7	1766	47.3	2706	72.5	6672	179	8810	236
700	48.3	250	17.2	472	12.7	1462	39.2	3092	82.9	4795	129	11,139	299	16,589	445
		300	20.7	464	12.4	1420	38.0	3041	81.5	4706	126	11,041	296	16,120	432
		400	27.6	436	11.7	1303	34.9	2858	76.6	4407	118	10,534	282	14,812	397
800	55.2	550	37.9	346	9.3	1002	26.9	2273	60.9	3487	93.5	8551	229	11,417	306
		up to 300	up to 20.7	537	14.4	1657	44.4	3514	94.2	5447	146	12,682	340	18,800	504
		400	27.6	516	13.8	1560	41.8	3381	90.6	5223	140	12,370	332	17,723	475
900	62.1	500	34.5	479	12.8	1421	38.1	3142	84.2	4839	130	11,644	312	16,158	433
		650	44.8	375	10.0	1081	29.0	2461	66.0	3774	101	9281	249	12,317	330
		up to 350	up to 24.1	601	16.1	1851	49.6	3935	105	6097	163	14,221	381	21,006	563
1000	69.0	400	27.6	592	15.9	1806	48.4	3876	104	5997	161	14,096	378	20,505	550
		600	41.4	519	13.9	1530	41.0	3406	91.3	5241	141	12,673	340	17,409	467
		800	55.2	337	9.0	963	25.8	2217	59.4	3394	91.0	8416	226	10,979	294
1100	75.8	up to 400	up to 27.6	665	17.8	2045	54.8	4355	117	6746	181	15,757	422	23,209	622
		500	34.5	643	17.2	1945	52.1	4214	113	6511	175	15,416	413	22,098	592
		600	41.4	608	16.3	1811	48.5	3990	107	6149	165	14,748	395	20,600	552
1200	82.7	800	55.2	479	12.8	1386	37.1	3150	84.4	4831	130	11,863	318	15,790	423
		up to 450	up to 31.0	729	19.5	2238	60.0	4774	128	7394	198	17,291	463	25,409	681
		600	41.4	691	18.5	2076	55.6	4532	122	6994	187	16,658	446	23,598	632
1300	89.6	800	55.2	592	15.9	1729	46.3	3886	104	5970	160	14,540	390	19,688	528
		1000	69.0	376	10.1	1071	28.7	2473	66.3	3784	101	9405	252	12,215	327
		up to 500	up to 34.5	793	21.2	2432	65.2	5193	139	8041	216	18,823	505	27,608	740
1400	96.5	600	41.4	770	20.6	2330	62.4	5048	135	7799	209	18,463	495	26,474	710
		800	55.2	690	18.5	2035	54.5	4530	121	6969	187	16,850	452	23,154	621
		1100	75.8	394	10.6	1122	30.1	2592	69.5	3965	106	9663	264	12,789	343
1480	102	up to 500	up to 34.5	865	23.2	2668	71.5	5665	152	8780	235	20,458	548	30,281	812
		600	41.4	846	22.7	2577	69.1	5545	149	8576	230	20,198	541	29,267	784
		800	55.2	780	20.9	2319	62.1	5119	137	7886	211	18,945	508	26,370	707
1480	102	1160	80.0	479	12.8	1368	36.7	3150	84.4	4821	129	11,961	321	15,593	418
		up to 500	up to 34.5	936	25.1	2901	77.8	6130	164	9507	255	22,064	591	32,920	882
		600	41.4	920	24.7	2818	75.5	6030	162	9334	250	21,884	587	32,000	858
1480	102	800	55.2	865	23.2	2588	69.4	5673	152	8749	235	20,903	560	29,424	789
		1160	80.0	629	16.9	1812	48.6	4135	111	6339	170	15,615	419	20,652	554
		up to 500	up to 34.5	992	26.6	3086	82.7	6497	174	10,083	270	23,334	625	35,012	938
1480	102	600	41.4	979	26.2	3009	80.6	6411	172	9931	266	23,205	622	34,155	915
		800	55.2	930	24.9	2796	74.9	6099	163	9412	252	22,398	600	31,784	852
		1160	80.0	729	19.5	2114	56.7	4791	128	7351	197	18,017	483	24,078	645

North America Only

# Bulletin 71.2:FL

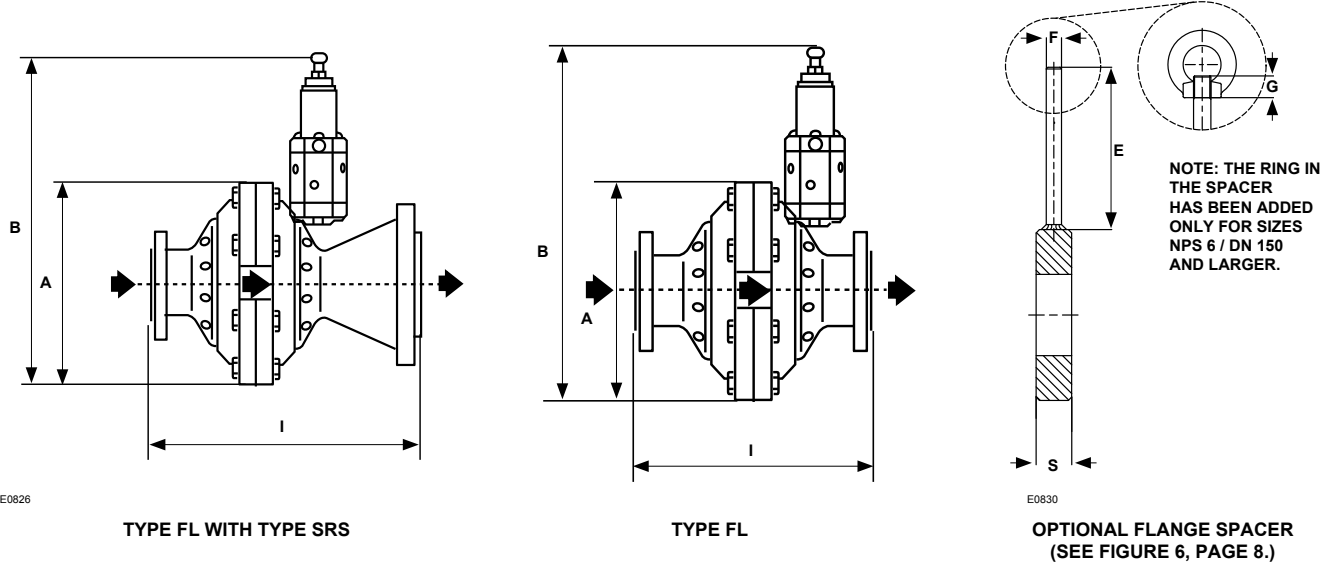

Figure 7. Dimensions

Table 23. Dimensions

BODY SIZE NPS / DN	DIMENSIONS, IN. / mm							APPROXIMATE WEIGHTS, LBS / kg
	(Face-to-Face / I) CL300 to CL600	A	B	E	F	G	S	With Types SR and SRII
1 / 25	8.3 / 211	8.9 / 225	17.1 / 430	4.7 / 120	0.39 / 10	----	1.18 / 30	68 / 31
2 / 50	11.3 / 286	11.3 / 287	19.5 / 490	4.7 / 120	0.39 / 10	----	1.97 / 50	132 / 60
3 / 80	13.3 / 337	15.7 / 400	23.4 / 590	4.7 / 120	0.39 / 10	----	2.36 / 60	326 / 148
4 / 100	15.5 / 394	18.9 / 480	26.8 / 680	4.7 / 120	0.39 / 10	----	2.36 / 60	443 / 201
6 / 150	20.0 / 508	24.0 / 610	33.9 / 860	4.7 / 120	0.39 / 10	0.47 / 12	3.15 / 80	1058 / 480
8 / 200	<b>CL300</b>	25.7 / 653	39.5 / 1000	4.7 / 120	0.39 / 10	0.47 / 12	3.93 / 100	1367 / 620
	<b>CL600</b>							
10 / 250	<b>CL300</b>	30.9 / 785	43.3 / 1100	4.7 / 120	0.39 / 10	0.47 / 12	3.93 / 100	2623 / 1190
	<b>CL600</b>							
BODY SIZE NPS / DN	(Face-to-Face / I) CL300 to CL600	A	B	E	F	G	S	With Type SRS
1 x 4 / 25 x 100	11.9 / 300	8.9 / 225	17.1 / 430	4.7 / 120	0.39 / 10	----	2.36 / 60	99 / 45
2 x 6 / 50 x 150	15.7 / 400	11.3 / 287	19.5 / 490	4.7 / 120	0.39 / 10	0.47 / 12	3.15 / 80	192 / 87
3 x 10 / 80 x 250	19.7 / 500	15.7 / 400	23.4 / 590	4.7 / 120	0.39 / 10	0.47 / 12	3.93 / 100	514 / 233
4 x 10 / 100 x 250	20.7 / 525	18.9 / 480	26.8 / 680	4.7 / 120	0.39 / 10	0.47 / 12	3.93 / 100	631 / 286
6 x 12 / 150 x 300	26.0 / 660	24.0 / 610	33.9 / 860	4.7 / 120	0.39 / 10	----	Consult Factory	1367 / 620
8 x 16 / 200 x 400	<b>CL300</b>	25.7 / 653	39.5 / 1000	4.7 / 120	0.39 / 10	----	Consult Factory	1984 / 900
	<b>CL600</b>							

North America Only

## Ordering Information

Carefully review each specification in the Specifications section, then complete the Specification Worksheet on page 32.

If a pilot setpoint is not requested, the regulator will be set at the approximate midrange.

## Ordering Guide

**Body Size** (Select One)

### Types FL, FL-SR and FL-SRII

(Same Inlet and Outlet Size)

- NPS 1 / DN 25\*\*
- NPS 2 / DN 50\*\*
- NPS 3 / DN 80\*\*
- NPS 4 / DN 100\*\*
- NPS 6 / DN 150\*\*
- NPS 8 / DN 200\*\*
- NPS 10 / DN 250\*\*

### Types FL-SR/SRS and FL-SRII/SRS

(Different Inlet and Outlet Size)

- NPS 1 x 4 / DN 25 x 100\*\*
- NPS 2 x 6 / DN 50 x 150\*\*
- NPS 3 x 10 / DN 80 x 250\*\*
- NPS 4 x 10 / DN 100 x 250\*\*
- NPS 6 x 12 / DN 150 x 300\*\*
- NPS 8 x 16 / DN 200 x 400\*\*

**End Connection Style** (Select One)

- CL300 RF\*\*
- CL600 RF\*\*

**O-ring Material** (Select One)

- Nitrile (NBR)\*\*
- Fluorocarbon (FKM)\*\*

**Disk Material**

- Nitrile (NBR) **(standard)**\*\*\*
- Fluorocarbon (FKM)\*\*
- Polyurethane (PU)\*\*

**Pilot Type** (Select One)

- PRX/120\*\*
- PRX-AP/120\*\*
- PRX/125\*\* (monitor override pilot)
- PRX-AP/125\*\* (monitor override pilot)
- PRX/131\*\*
- PRX-AP/131\*\*

**Outlet Flange Spacer** (Optional)

- Yes\*\*
- No

**Silencer** (Optional)

- Type SR\*\*
- Type SR/SRS\*\*
- Type SRII\*\*
- Type SRII/SRS\*\*

**Outlet Pressure Range** (Select One)

#### Type PRX-120/125/131

- 14.5 to 26 psig / 1.00 to 1.8 bar, Yellow\*\*
- 23 to 44 psig / 1.6 to 3.0 bar, Green\*\*
- 41 to 80 psig / 2.8 to 5.5 bar, Blue\*\*
- 73 to 123 psig / 5.0 to 8.5 bar, Black\*\*
- 116 to 210 psig / 8.0 to 14.5 bar, Silver\*\*
- 203 to 334 psig / 14.0 to 23.0 bar, Gold\*\*\*
- 319 to 435 psig / 22.0 to 30.0 bar, Aluminum\*\*\*

#### Type PRX-AP/120/125/131

- 435 to 1160 psig / 30.0 to 80.0 bar, Clear\*\*

**Main Valve Mounting Position**

- Horizontal
- Vertical

**Pilot Diaphragm** (Select One)

- Nitrile (NBR) **(standard)**\*\*\*
- Fluorocarbon (FKM)\*\*

**Pilot Disk** (Select One)

- Polyurethane (PU) **(standard)**\*\*
- Fluorocarbon (FKM)\*\*

**Type SA/2 O-Ring and Diaphragm Material**

- Nitrile (NBR) **(standard)**\*\*
- Fluorocarbon (FKM)\*\*

**Main Valve Replacement Parts Kit** (Optional)

- Yes, send one replacement parts kit to match this order.

**Main Valve Replacement Commission Kit** (Optional)

- Yes, send one commission kit to match this order.

**Pilot Valve Replacement Parts Kit** (Optional)

- Yes, send one replacement parts kit to match this order.

Regulators Quick Order Guide	
***	Readily Available for Shipment
**	Allow Additional Time for Shipment
*	Special Order, Constructed from Non-Stocked Parts. Consult your Sales Representative for Availability.
Availability of the product being ordered is determined by the component with the longest shipping time for the requested construction.	

Specification Worksheet	
<b>Application:</b>	
Specific Use	_____
Line Size	_____
Fluid Type	_____
Specific Gravity	_____
Temperature	_____
Does the Application Require Overpressure Protection?	
<input type="checkbox"/> Yes	<input type="checkbox"/> No
<b>Pressure:</b>	
Maximum Inlet Pressure	_____
Minimum Inlet Pressure	_____
Differential Pressure	_____
Set Pressure	_____
Maximum Flow	_____
<b>Accuracy Requirements:</b>	
Less Than or Equal To:	
<input type="checkbox"/> 5%	<input type="checkbox"/> 10% <input type="checkbox"/> 20% <input type="checkbox"/> 40%
<b>Construction Material Requirements (if known):</b>	
_____	

## Industrial Regulators

### Emerson Process Management Regulator Technologies, Inc.

USA - Headquarters  
McKinney, Texas 75070 USA  
Tel: +1 800 558 5853  
Outside U.S. +1 972 548 3574

Asia-Pacific  
Shanghai 201206, China  
Tel: +86 21 2892 9000

Europe  
Bologna 40013, Italy  
Tel: +39 051 419 0611

Middle East and Africa  
Dubai, United Arab Emirates  
Tel: +971 4811 8100

## Natural Gas Technologies

### Emerson Process Management Regulator Technologies, Inc.

USA - Headquarters  
McKinney, Texas 75070 USA  
Tel: +1 800 558 5853  
Outside U.S. +1 972 548 3574

Asia-Pacific  
Singapore 128461, Singapore  
Tel: +65 6770 8337

Europe  
Bologna 40013, Italy  
Tel: +39 051 419 0611  
Chartres 28008, France  
Tel: +33 2 37 33 47 00

Middle East and Africa  
Dubai, United Arab Emirates  
Tel: +971 4811 8100

## TESCOM

### Emerson Process Management Tescom Corporation

USA - Headquarters  
Elk River, Minnesota 55330-2445, USA  
Tels: +1 763 241 3238  
+1 800 447 1250

Europe  
Selmsdorf 23923, Germany  
Tel: +49 38823 31 287

Asia-Pacific  
Shanghai 201206, China  
Tel: +86 21 2892 9499

For further information visit [www.emersonprocess.com/regulators](http://www.emersonprocess.com/regulators)

The Emerson logo is a trademark and service mark of Emerson Electric Co. All other marks are the property of their prospective owners. Fisher is a mark owned by Fisher Controls International LLC, a business of Emerson Process Management.

The contents of this publication are presented for informational purposes only, and while every effort has been made to ensure their accuracy, they are not to be construed as warranties or guarantees, express or implied, regarding the products or services described herein or their use or applicability. We reserve the right to modify or improve the designs or specifications of such products at any time without notice.

Emerson Process Management Regulator Technologies, Inc. does not assume responsibility for the selection, use or maintenance of any product. Responsibility for proper selection, use and maintenance of any Emerson Process Management Regulator Technologies, Inc. product remains solely with the purchaser.