

# SAMAN FATER RASHA

## WALDRON GEAR COUPLING Size 1-7

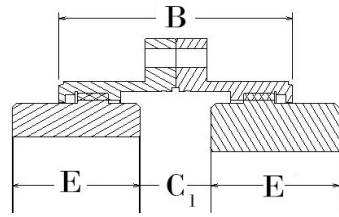

ONE HUB REVERSED

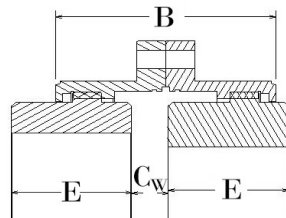

TWO HUBS REVERSED

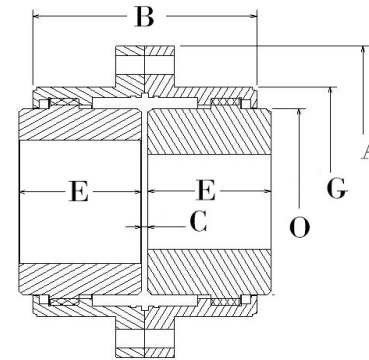

Coupling Size	Maximum Bore with Standard Key	Rating HP / 100 RPM	Torque Rating (lb.-in.)	Peak Torque Rating (lb.-in.)	Maximum Speed (RPM)	Dimensions							
						A	B	C	C1	Cw	E	G	O
1	1 5/8	10	6300	12600	10000	4 9/16	3 3/16	1/8	3/8	5/8	1 11/16	3	2 5/16
1 1/2	2 3/16	24	15100	30200	7400	6	3 7/8	1/8	9/16	1	2 1/16	3 13/16	3 1/8
2	2 3/4	50	31500	63000	5900	7	4 5/8	1/8	13/16	1 1/2	2 7/16	4 13/16	4
2 1/2	3 1/4	90	56700	113400	5000	8 3/8	5 11/16	3/16	29/32	1 5/8	3 1/32	5 23/32	4 23/32
3	4	150	94500	189000	4300	9 7/16	6 9/16	3/16	1 1/32	1 7/8	3 19/32	6 23/32	5 5/8
3 1/2	4 3/4	230	145000	290000	3900	11	7 5/8	1/4	1 5/16	2 3/8	4 3/16	7 3/4	6 5/8
4	5 3/8	350	221000	442000	3500	12 1/2	8 5/8	1/4	1 7/16	2 5/8	4 3/4	8 31/32	7 1/2
4 1/2	6	480	300000	600000	3200	13 5/8	9 5/8	5/16	1 5/8	2 15/16	5 3/8	10 3/8	8 1/2
5	6 3/4	650	410000	820000	2900	15 5/16	10 13/16	5/16	1 11/16	3 1/16	6 1/8	11 3/8	9 1/2
5 1/2	7 1/2	850	536000	1072000	2700	16 3/4	11 5/8	5/16	1 7/8	3 7/16	6 5/8	12 9/16	10 27/64
6	8 1/4	1100	693000	1386000	2500	18	13 1/4	5/16	2 5/16	4 5/16	7 3/8	13 7/8	11 3/4
7	9 1/4	1600	1010000	2020000	2200	20 3/4	14 3/4	3/8	2 3/16	4	8 11/16	15 3/4	13 1/4

Sizes 5 1/2 , 6 and 7 are only available with exposed bolt sleeves. Type EB exposed bolt sleeves are standard.